



# Vanilla Shell Suites For Lease

## 18540 E. San Tan Blvd | Queen Creek, AZ

**CONSTRUCTION FINISHED**

2 Months Free Rent  
On A 3 Year Lease

3 Months Free Rent  
On A 5 Year Lease

**TENANT INCENTIVE**

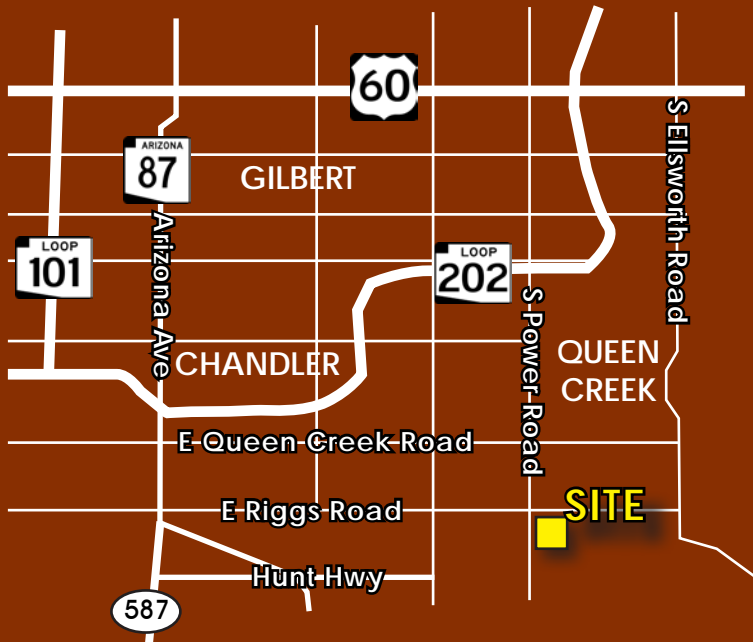

### Property Features

- ± 11,590 SF
- Multi-Use Commercial Project
- 1 Suite Available: 3,669 SF
- Will Deliver in Vanilla Shell Condition
- Zoning: C-3, City of Queen Creek
- Located at Power Rd & San Tan Blvd
- Located on ± 1 Acre Lot
- Frontage on San Tan Blvd
- Ample Parking

For More Information,  
Please Contact:

**Tyson Breinholt**  
D: 480.966.7513  
M: 602.315.7131  
tbreinholt@cpiq.com



**COMMERCIAL PROPERTIES INC.**

Locally Owned. Globally Connected. CRPAC International

TEMPE: 2323 W. University Drive, Tempe, AZ 85281 | 480.966.2301  
SCOTTSDALE: 8777 N. Gainey Center Dr., Suite 245, Scottsdale, AZ 85258 | www.cpiq.com

The information contained herein has been obtained from various sources. We have no reason to doubt its accuracy; however, J & J Commercial Properties, Inc. has not verified such information and makes no guarantee, warranty or representation about such information. The prospective buyer or lessee should independently verify all dimensions, specifications, floor plans, and all information prior to the lease or purchase of the property. All offerings are subject to price change, prior sale, lease, or withdrawal from the market without prior notice.  
Effective: 12 21 18



**CONSTRUCTION FINISHED**

# Vanilla Shell Suites 18540 E. San Tan Blvd Queen Creek, AZ

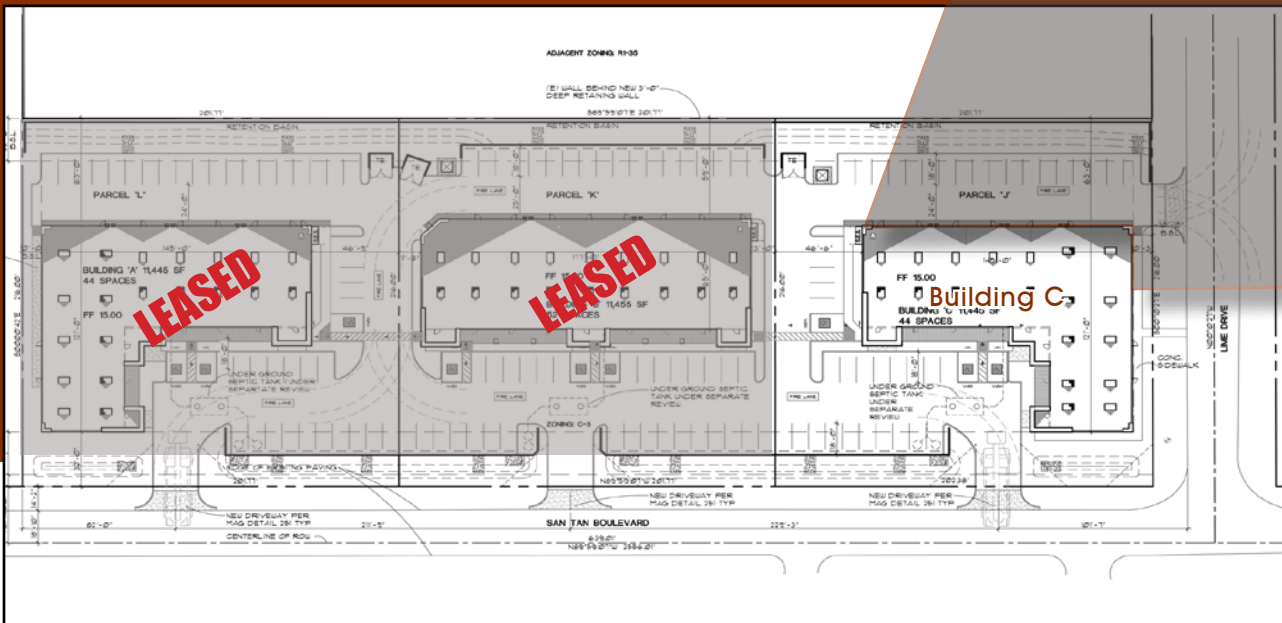
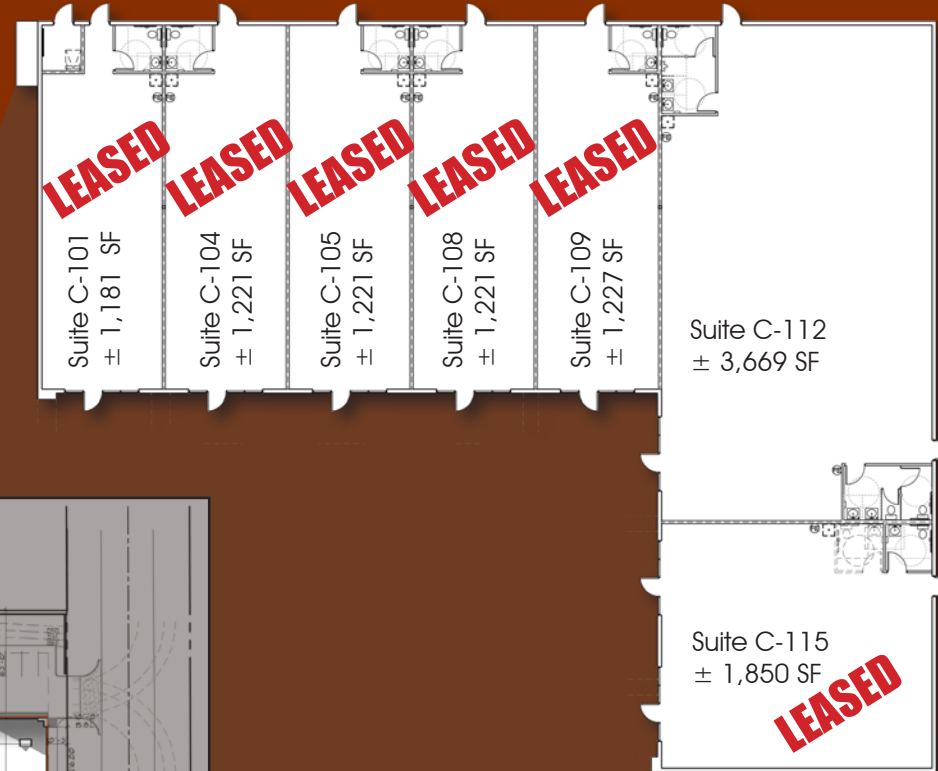

Tyson Breinholt  
D: 480.966.7513  
M: 602.315.7131  
tbreinholt@cpi.az.com

**COMMERCIAL PROPERTIES INC.**  
Locally Owned. Globally Connected. CFRAC International

TEMPE: 2323 W. University Drive, Tempe, AZ 85281 | 480.966.2301  
SCOTTSDALE: 8777 N. Gainey Center Dr., Suite 245, Scottsdale, AZ 85258 | www.cpi.az.com