

# 369 N. OLD WOODWARD BIRMINGHAM, MICHIGAN

RETAIL FOR LEASE  
1,636 Square Feet Available

AERIS

SIGNATURE  
ASSOCIATES

BROOKSIDE RESIDENCES



## PROPERTY FEATURES

- 1,636 available square feet
- Zoned R-5
- First floor retail space with opportunity to build a mezzanine and create more square footage
- The Brookside is the most luxurious living space available
- Gorgeous floor to ceiling windows on two sides of the space
- Give your customers an experience unlike any other in town!
- Lease Rate: \$62.00/sq.ft. NNN

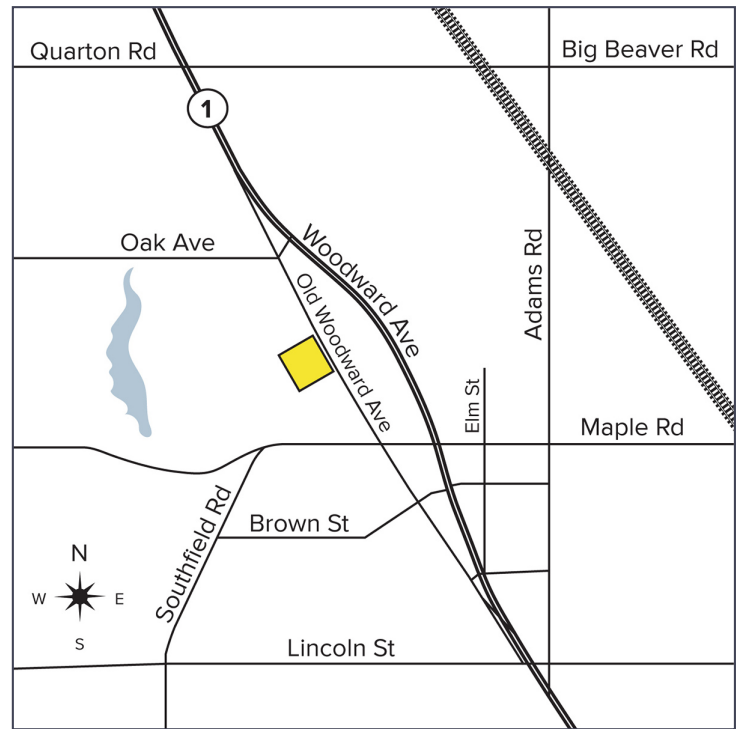

For more information, please contact:

**ANGELA THOMAS**  
(248) 359 3838  
athomas@signatureassociates.com

**ERICA DUNLAP**  
(248) 359 3808  
edunlap@signatureassociates.com

**SIGNATURE ASSOCIATES**  
One Towne Square, Suite 1200  
Southfield, MI 48076  
www.signatureassociates.com

# 369 N. Old Woodward - BIRMINGHAM, MICHIGAN

Retail For Lease

1,636  
Square Feet  
AVAILABLE



## DEMOGRAPHICS

	POPULATION	MED. HH INCOME
1 MILE	13,469	\$132,628
3 MILE	81,533	\$111,974
5 MILE	222,534	\$101,892

## TRAFFIC COUNTS (TWO-WAY)

9,101	N. Old Woodward N. of Willits St. 2-Way
10,604	N. Old Woodward S. of Willits St. 2-Way
9,012	Willits St. W. of N. Old Woodward 2-Way
6,679	Oakland Ave. E. of N. Old Woodward 2-Way



For more information, please contact:

**ANGELA THOMAS**  
(248) 359 3838  
athomas@signatureassociates.com

**ERICA DUNLAP**  
(248) 359 3808  
edunlap@signatureassociates.com

**SIGNATURE ASSOCIATES**  
One Towne Square, Suite 1200  
Southfield, MI 48076  
www.signatureassociates.com

## CITY OVERVIEW / BIRMINGHAM



The City of Birmingham is an energetic hub for all things “Live, Shop, Play” and is known as one of the nation’s most affluent suburbs. Birmingham has a thriving pedestrian friendly retail shopping district with a historic downtown dating back to the 1830s. The downtown area is comprised of approximately 300 retail and service businesses with everything your heart desires.

### TRADE AREA/STATS (2019 ESTIMATES)

TOTAL POPULATION	225,802
TOTAL HOUSEHOLDS	100,119
% FEMALE	51.7%
% MALE	48.3%
MEDIAN AGE	42.3
TOTAL HOUSEHOLD EXPENDITURE	\$8.51 billion
AVERAGE HOUSEHOLD INCOME	\$188,140
AVERAGE HOME PRICE	\$390,975

### BIRMINGHAM FACTS & FIGURES

- Home to notable retailers and restaurants such as Lululemon, Anthropologie, West Elm, Starbucks Reserve, Paper Source, Hyde Park, & Flemings
- Surrounded by Michigan’s wealthiest zip codes, including Bloomfield Hills, Bloomfield Twp., Franklin/Bingham Farms, and West Bloomfield
- Named one of the “Top 20 Walkable Towns in America” according to an independent audit of more than 600 communities throughout the United States
- There are 5 municipal parking decks that offer 2 hours free, plus metered parking along the main thoroughfares
- CNN Money named Birmingham among Top 10 6-figure towns

For more information, please contact:

**ANGELA THOMAS**  
(248) 359 3838  
athomas@signatureassociates.com

**ERICA DUNLAP**  
(248) 359 3808  
edunlap@signatureassociates.com

**SIGNATURE ASSOCIATES**  
One Towne Square, Suite 1200  
Southfield, MI 48076  
www.signatureassociates.com