



Property Features

- Conveniently located on Broad Street across from the post office
- ±10,900 SF Available
 - ± 3,000 SF office
 - ± 7,900 SF warehouse
- Property is Zoned I-1
- Dock doors on front side
- Grade door could be added
- Lease: \$3.96 PSF (Industrial Gross)



For more information, contact:

TOM DANA
Vice President
757 499 2894
tom.dana@thalhimer.com

The Town Center of Virginia Beach
222 Central Park Ave., Suite 1820
Virginia Beach, VA 23462
www.thalhimer.com

FLOOR PLAN

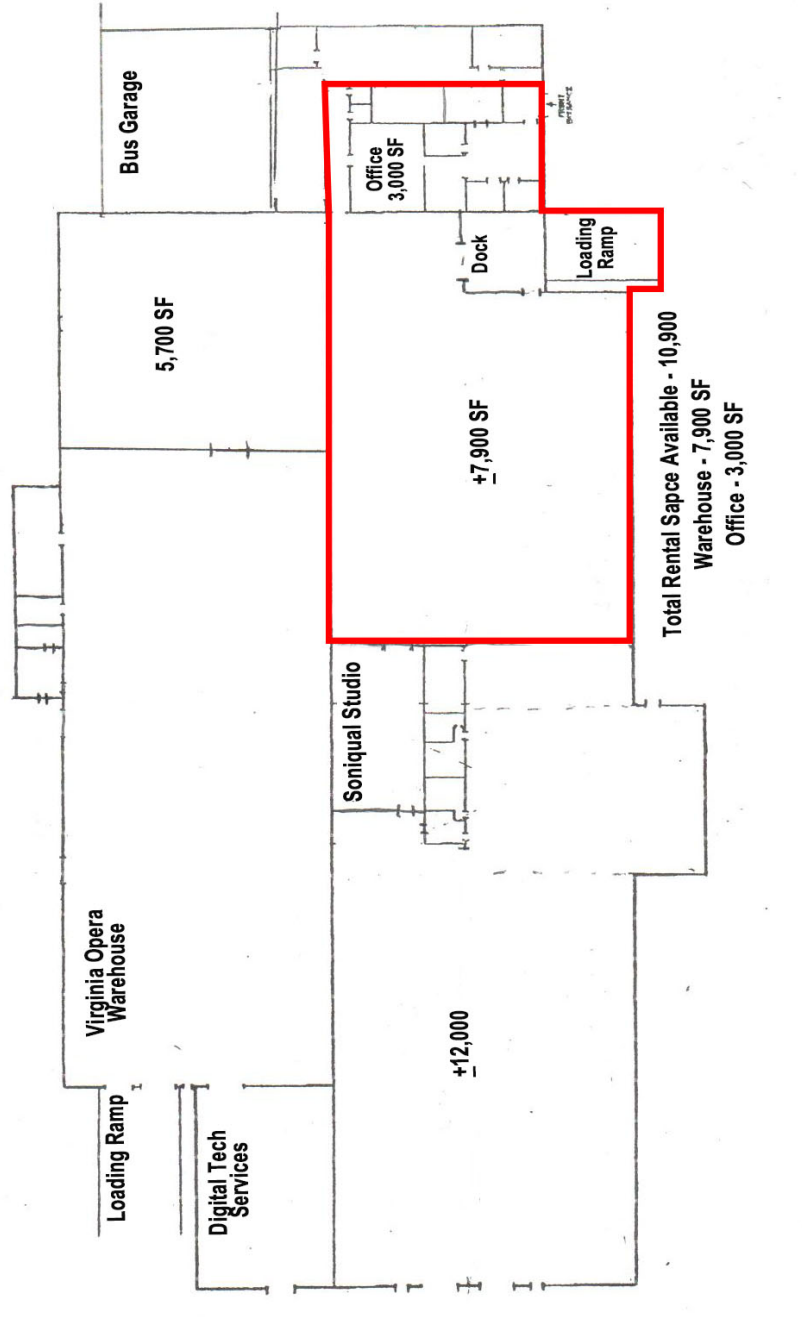

H.U.M Properties
 900 Broad Street
 Portsmouth, VA 23707

For more information, contact:

TOM DANA
 Vice President
 757 499 2894
 tom.dana@thalhimer.com

The Town Center of Virginia Beach
 222 Central Park Ave., Suite 1820
 Virginia Beach, VA 23462
 www.thalhimer.com