



For Lease

Office & Lab Space Available 1st Floor – 32,813 RSF

Space Highlights

- Abundant lab space comprised of chemistry labs with 8 in-laboratory offices
- Small molecule chemical processing pilot plant with (1) 200 gal, (1) 100 gal, and (2) 50 gal glass lined, agitated reactors with associated processing equipment
- 13 chemical solvent fume hoods (11) X 64 inch sash width, (2) X 88 inch sash width, 8 sinks with waste water ph neutralization

Property Highlights

- 65,300 s.f. Life Science building
- Diesel fired 605 kW backup generator
- Easy access to Route 84 and Danbury Airport

8 Casper Street Danbury, CT

Paul Michael Tortora

Senior Vice President

+1 203 705 2263

paul.tortora@am.jll.com

Matt Felice

Senior Vice President

+1 212 812 6422

matt.felice@am.jll.com

Gil Ohls

Managing Director

+1 212 418 2602

gil.ohls@am.jll.com



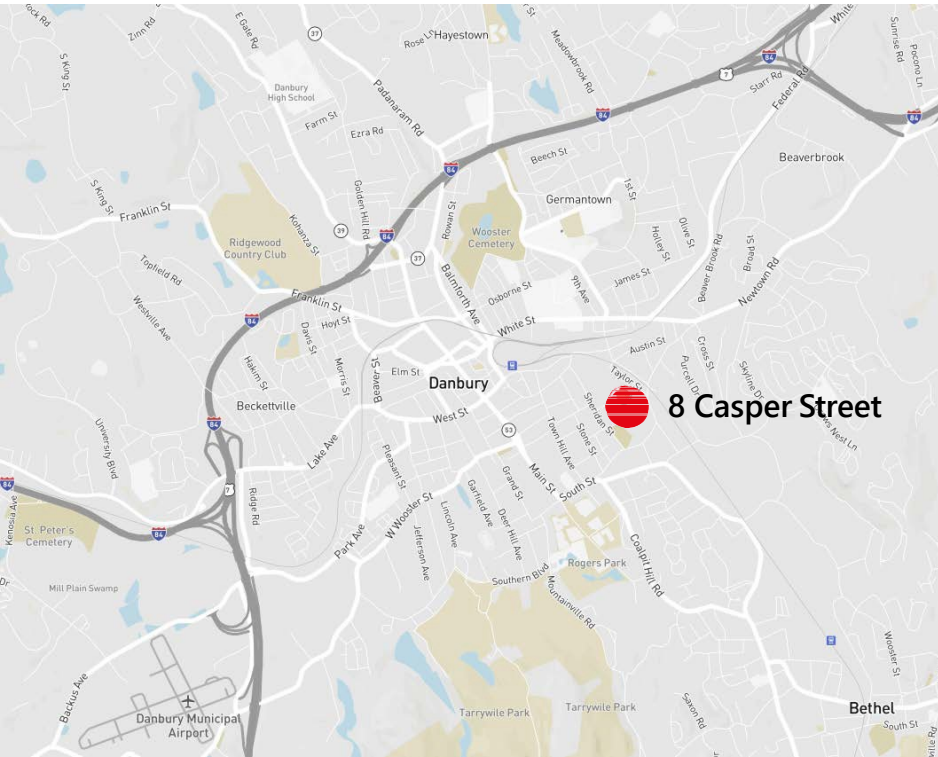

Building size:	65,300 s.f.
Year built/Renovated:	1986 / 2006
Owner:	MannKind Corp.
Parking ratio:	3 / 1,000 s.f.
Power:	3 phase 480V throughout with 208 and 120V available in various electrical rooms
HVAC:	Central HVAC with controlled environments in GMP areas – controlled by BAS throughout.
Slab-to-slab heights:	14'
Generator:	605 kW Diesel Fired
Elevators:	1
Sprinkler:	100% (wet)
Loading:	2
Electric and gas provider:	Eversource
Construction:	Steel and concrete block

Summary of Availability:

Possession: Immediate
Rent: Upon Request
Term: 5-10 Years



Entire 1st Floor As-Built – 32,813 RSF

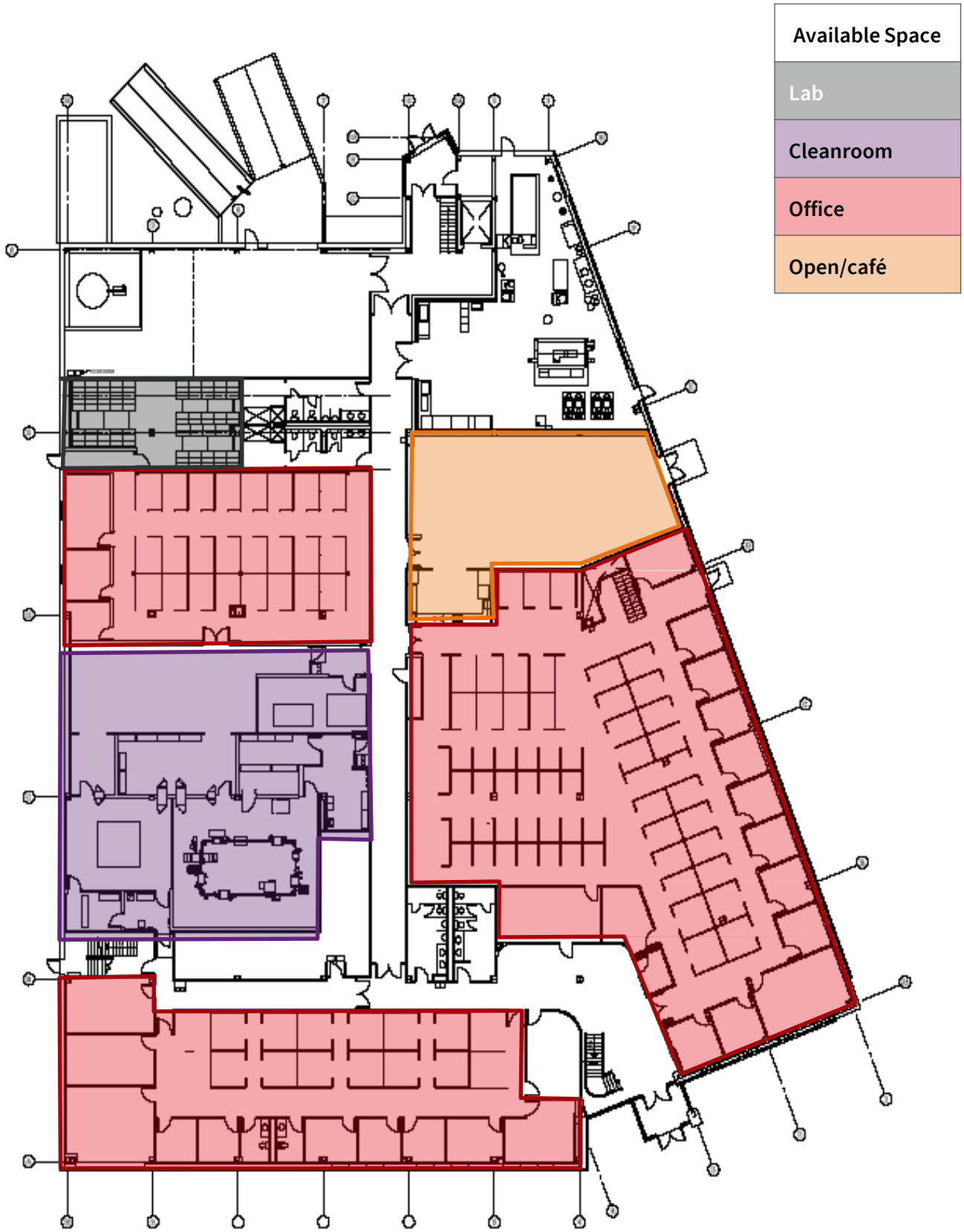

Although information has been obtained from sources deemed reliable, Owner, Jones Lang LaSalle, and/or their representatives, brokers or agents make no guarantees as to the accuracy of the information contained herein, and offer the Property without express or implied warranties of any kind. The Property may be withdrawn without notice. ©2017. Jones Lang LaSalle. All rights reserved.



Entire 1st Floor – Test Fit
32,813 RSF

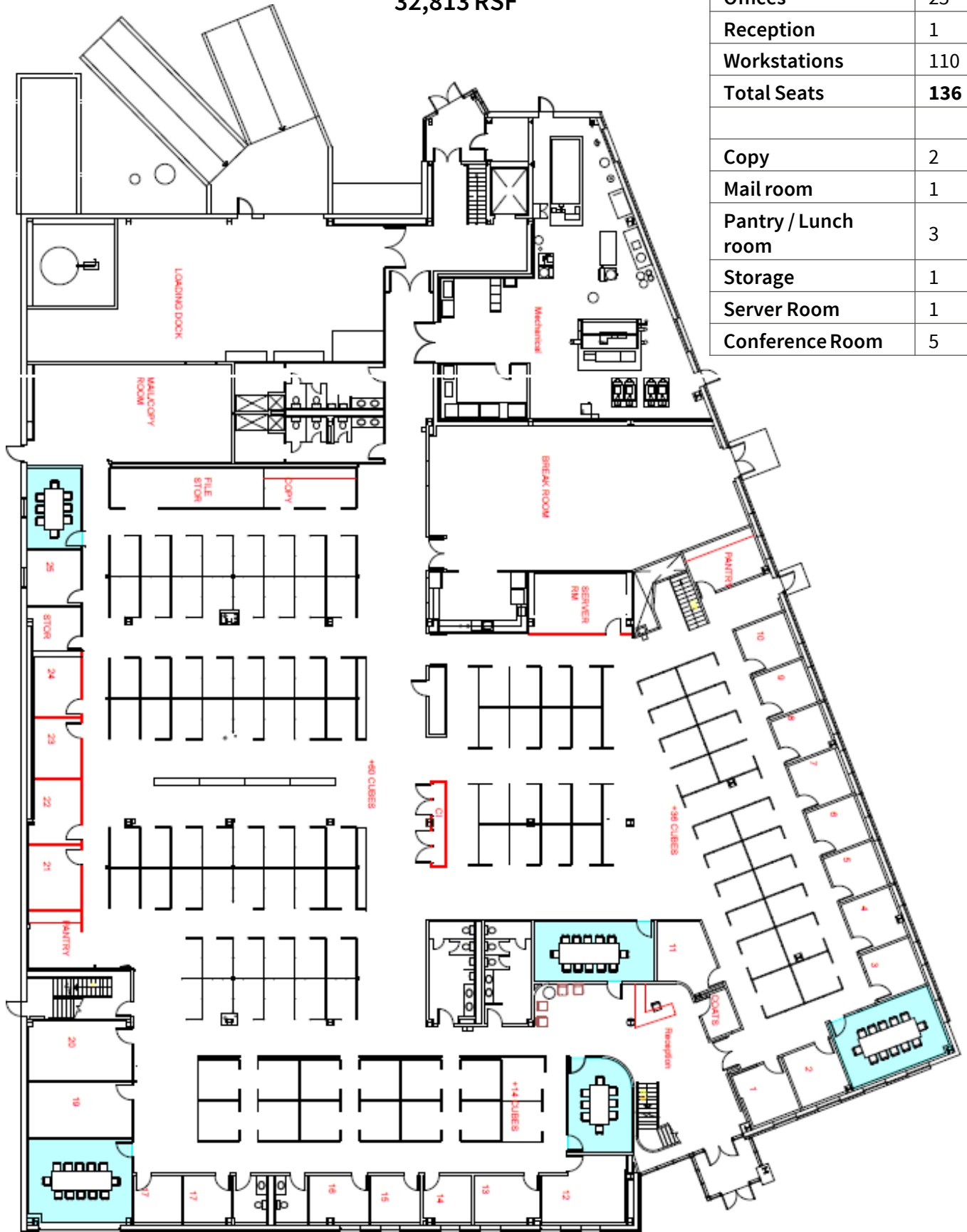

Program	
Offices	25
Reception	1
Workstations	110
Total Seats	136
Copy	2
Mail room	1
Pantry / Lunch room	3
Storage	1
Server Room	1
Conference Room	5

Although information has been obtained from sources deemed reliable, Owner, Jones Lang LaSalle, and/or their representatives, brokers or agents make no guarantees as to the accuracy of the information contained herein, and offer the Property without express or implied warranties of any kind. The Property may be withdrawn without notice. ©2017. Jones Lang LaSalle. All rights reserved.



Building 8: Details

Construction	Built in 1986; Renovated 2006 Concrete, masonry and steel Renovations in 2001-02 (MS-1) Renovations in 2005-06 (CR-2, Micro Lab, RODI Water, Honeywell EBI) EPDM Roof 2011
Building Areas Footprint Second Floor Penthouse	33,000 sq. ft. 32,300 N/A
Total Gross Square Feet	65,300 sq. ft.
Operations	R&D (nine labs) Chemical processing pilot plant (MS-1) Clinical manufacturing (Class 10K and 100K clean rooms) Offices and cubicles
Environmental	To be covered in ELUR
Fire Protection	Wet sprinkler FM-200 systems for IT Server and High Density file storage
Security	Cameras with continuous recording and monitored security center Card reader access
Utilities Boilers Chillers Cooling Towers Air Compressors Stand-by Power	1 @ 125 HP; 15psig 1 @ 200HP, 100psig 1 @ 350 tons; 1 @ 125 tons (new in 2013) 1 @ 350 tons 1 @ 200 cfm oil-free; 100 psig 605 kW generator bridged by a 100kVA UPS