



**AGENT PROFILE**

Maureen Anter-Ressler

Ann Ertle

**PROPERTY HIGHLIGHTS**

- Across from the soon to be newly developed Brunswick Middle School
- Located in the heart of Brunswick
- Great visibility
- Pristine condition
- Move in ready

**TRADE AREA DEMOGRAPHICS**

	POPULATION	AVG. HH INCOME	DAYTIME EMPLOYEES
<b>1 Mile</b>	4,463	\$101,051	2,943
<b>3 Miles</b>	50,726	\$84,899	19,174
<b>5 Miles</b>	129,142	\$87,351	77,126
<b>5 Minutes</b>	18,905	\$84,317	7,740

**QUICK LINKS** *(click to view)*

3401 Richmond Rd., Suite 200  
Beachwood, OH 44122

[www.passovgroup.com](http://www.passovgroup.com)

**FOR MORE INFORMATION, CONTACT: 216.831.8100**

**Maureen Anter-Ressler** / [mressler@passovgoup.com](mailto:mressler@passovgoup.com) • **Ann Ertle** / [aertle@passovgroup.com](mailto:aertle@passovgroup.com)

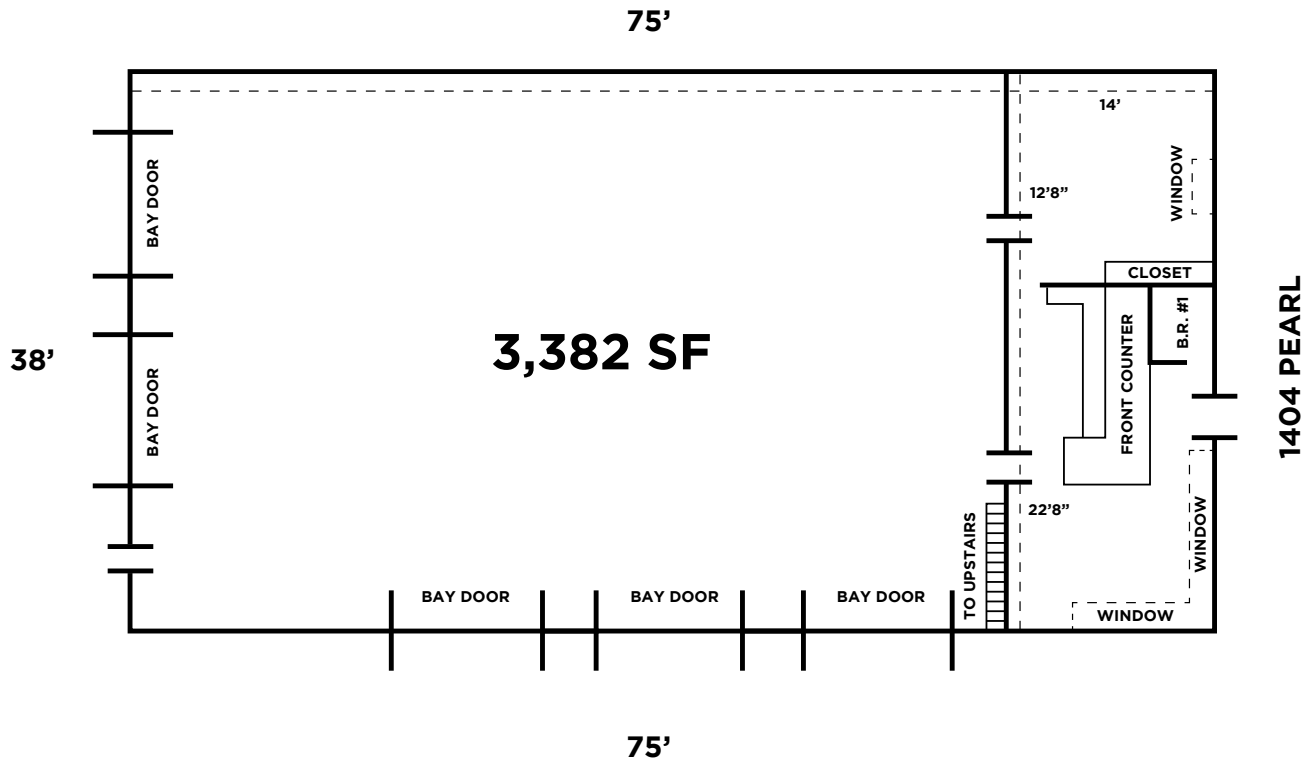

- 3,382 SF
- 5 Drive in Doors
- Restroom
- Shop Counter
- Office





BRUNSWICK FIRE DEPARTMENT STATION NO. 1

Huntington  
Welcome.

CONRAD'S  
The Finest & Best Get-Gos

15,092 VPD

SITE

CENTER RD

BRUNSWICK UNITED METHODIST CHURCH

PIZZA PAPA JOHN'S

DQ

HARBOR WOODS LIVING AT BRUNSWICK

ALDI

Auto Zone

O'Reilly AUTO PARTS

PEARL RD

NEW BRUNSWICK MIDDLE SCHOOL

BRUNSWICK PLAZA

DIAMOND EVENT CENTER & CATERING

DICK HOOVER'S LANES

HOMETOWN COUNTRY KITCHEN

SOUTHWICK MANOR

17,815 VPD

Speedway

PNC







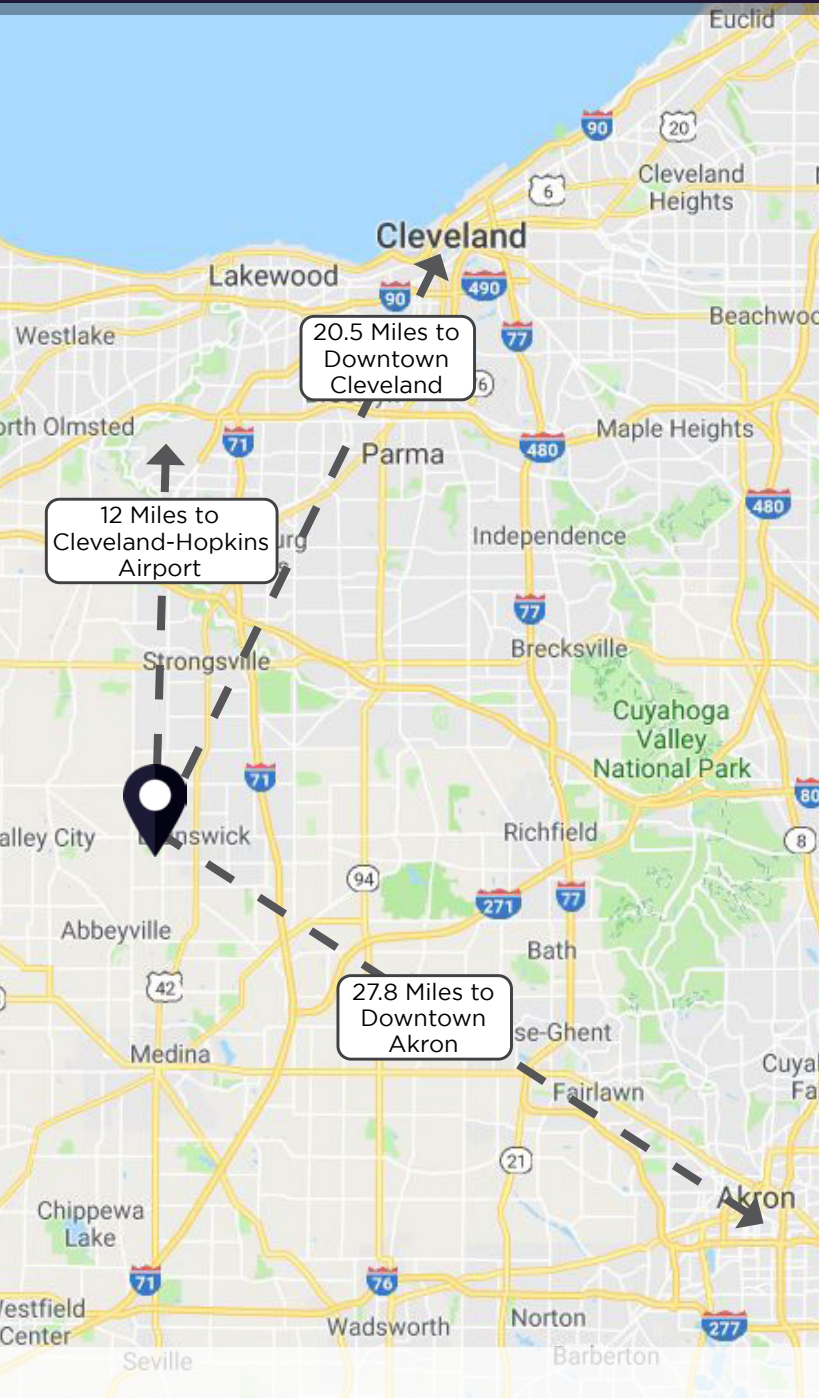

## GREAT LOCATION

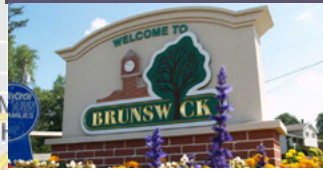

The City of Brunswick is an ideal place for commercial, industrial and residential development. We are located close to Cleveland and Akron via I-71, 20 minutes from Cleveland Hopkins International Airport, and only 10 minutes from the Ohio Turnpike.

## BUSINESS & FAMILY-FRIENDLY



We're a community of safe, family-oriented neighborhoods with a thriving atmosphere of commercial, industrial and educational growth. Our city is designated a "business friendly community" in northeast Ohio by the Greater Akron Chamber of Commerce and in partnership with the Greater Cleveland Growth Association. There is an active Northern Medina County Chamber Alliance and SCORE to help you start and build your business.

## CENTER OF EDUCATION



For the past five years, the State of Ohio rated Brunswick City School District "Excellence with Distinction." This is their highest rating.

Cuyahoga Community College's new facility, Brunswick University Center, opened for classes in January 2011 with over 800 students along with Tiffin University and Franklin University.

In addition, a Lorain County Community College and University of Akron partnership opened at Midpoint Campus in Brunswick on January 20, 2009.

## MEDICAL HUB



Brunswick is home to world class medical facilities like The Cleveland Clinic and Southwest General Health Center (both operating emergency centers in the City) plus Medina Hospital and MetroHealth. Digestive Disease Consultants and several new and expanded projects continue along the two main corridors.

## NEW TAX ABATEMENTS & INCENTIVES



New economic incentives have attracted over \$95 million in new business and residential investments in the past two years, and another \$200 million is planned in the next two years. Forward-thinking business people are discovering the "can do" spirit prevalent in Brunswick. With economic development incentives and a business cooperative government, we welcome you to contact us to assist you in exploring ways for your business to grow and expand in the city that Family Circle called "One of the Best Cities in America to Raise a Family!"