

# DOING DEALS IN SOUTHFIELD PARK

OFFICE SPACE  
FOR LEASE

## 6402 SOUTH TROY CIRCLE

CENTENNIAL, CO 80111



- NEW OWNERSHIP
- NEW MANAGEMENT
- NEW LANDSCAPING
- NEW LOBBY
- NEW SPEC SUITE
- GREAT SOUTHEAST  
LOCATION WITHOUT  
THE HIGH RENTAL  
RATES



### FOUR DEALS DONE WITH NEW OWNERSHIP!!!



**BUILDING SF:** 29,176 SF

**AVAILABILITY:** Suite 350: 3,867 RSF  
Suite 360: 2,272 RSF  
Suite 340: 1,595 RSF

**LEASE RATE:** \$15.00/SF Full Service

**PARKING:** 4/1,000

#### AMENITIES

- :: Building signage available
- :: New HVAC system
- :: Near Centennial Airport
- :: Easy access to I-25 & Parker Road
- :: Fully ADA accessible
- :: Low operating cost
- :: Exercise room
- :: Lockers & showers
- :: Common conference room

FOR MORE  
INFORMATION  
PLEASE CONTACT

**Dave Buck**  
Vice President  
720.528.6514  
dave.buck@cbre.com

**Richard Damm**  
First Vice President  
720.528.6510  
richard.damm@cbre.com



OFFICE SPACE  
FOR LEASE

# 6402 SOUTH TROY CIRCLE

CENTENNIAL, CO 80111



## NEARBY AMENITIES

### MULTIPLE RESTAURANTS INCLUDING:

- Sushi Kazu Japanese Restaurant
- Quizno's
- Subway
- Einstein's Bagels
- Diego Zuang Burger Bar
- Sabor Mexican
- Peppino's Pizza
- My Favorite Muffin
- Wendy's

### RETAIL

- Target
- Old Navy

### HOTELS

- Embassy Suites
- Ramada Hotel
- Candlewood Suites

## Suite 350 - 3,867 RSF Available

Able to Subdivide into Smaller Spec Type Suites

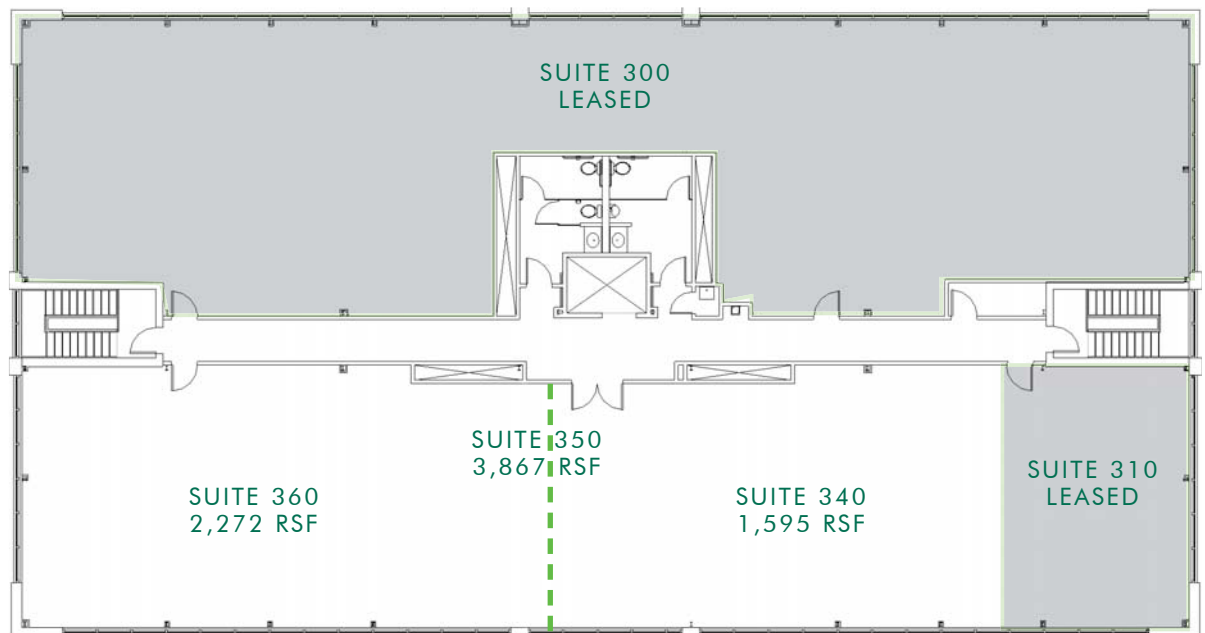

FOR MORE  
INFORMATION  
PLEASE  
CONTACT

**Dave Buck**

Vice President

720.528.6514

dave.buck@cbre.com

**Richard Damm**

First Vice President

720.528.6510

richard.damm@cbre.com

CBRE | 8390 E. Crescent Parkway | Suite 300 | Greenwood Village, CO 80111 | [www.cbre.com/denver](http://www.cbre.com/denver)

© 2012 CBRE, Inc. This information has been obtained from sources believed reliable. We have not verified it and make no guarantee, warranty or representation about it. Any projections, opinions, assumptions or estimates used are for example only and do not represent the current or future performance of the property. You and your advisors should conduct a careful, independent investigation of the property to determine to your satisfaction the suitability of the property for your needs.

**CBRE**