

# **G** GUCKENBURG REALTY, INC.

703 Giddings Ave • Suite U2, Annapolis MD 21401

Email: Tom@guckenburger.com

Office: 410-760-1313



## COMMERCIAL PROPERTY FOR SALE

**Property:** Parcel 34, Fort Meade RD, (RT 198) Laurel MD 21146, Anne Arundel County

**Price:** \$1,150,000 With Tax Differed Exchange or Development/Terms/Leasing

**Land:** 2.34+- Acres, 180 Ft. Front (200' Back) X 650 Ft+- Sides, **ZONED:** C4

**Description:** Recent Public Water Fire Hydrant brought to Front West Corner, Public Sewer brought under RT 295 with Pump Required with neighbors development planning extension/partnership

**Location:** RT 295 to RT 198 (Fort Meade Rd ) East to Arundel Gateway Rd to Billboard on property on Right. Just past RT 198 Barber Shop

**Comments:** RT 198 Road changes Planning, Neighbors Planning, May Sell or Participate before permits. Engineering in process.

**Contact:** Tom Guckenburger 410-760-1313 Email: Tom@guckenburger.com (Owner/Agent)

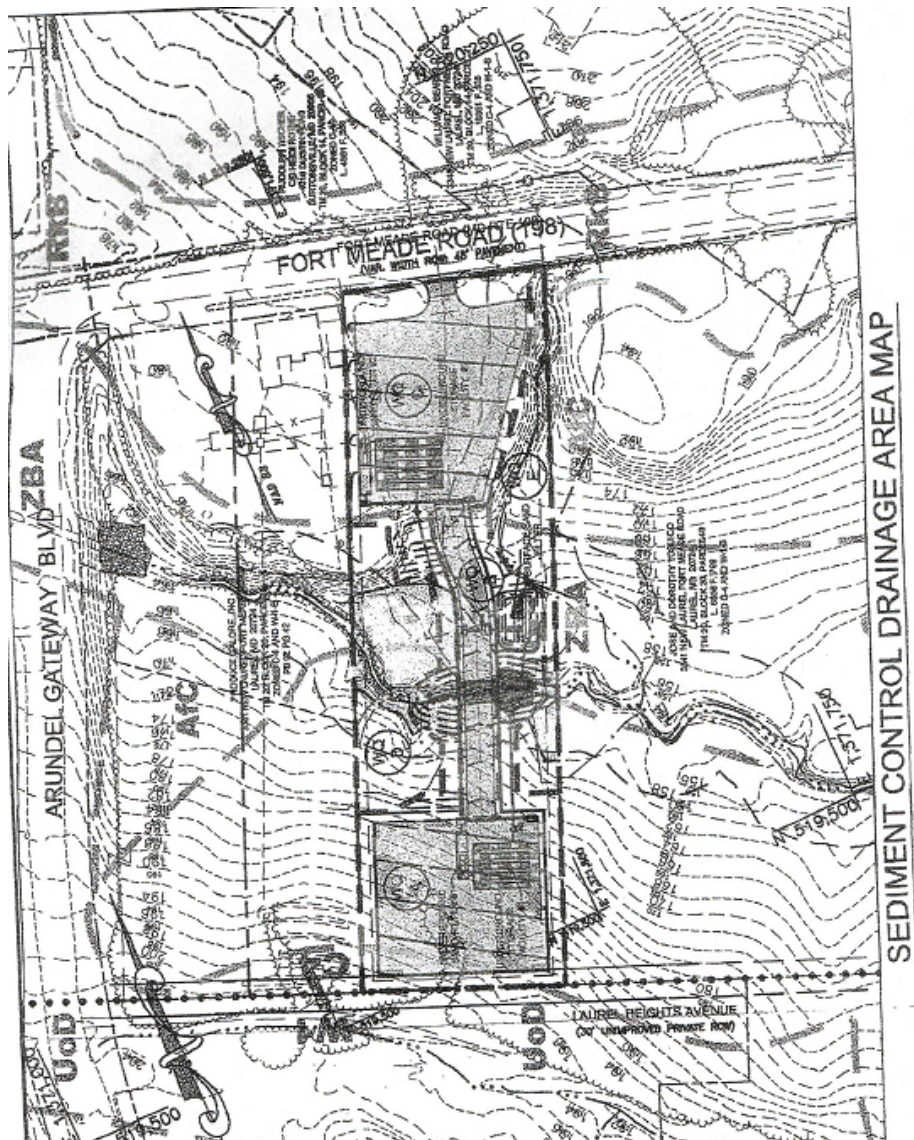

This property offering is subject to change without notice. All information is deemed reliable but not guaranteed. Buyer or lessee prospects should independently verify all information