

FOR SALE OR LEASE

WWW.INSITEREALTY.COM

1410 BIGELOW

8,225 SQUARE FEET

LOCATED IN A QUALIFIED
OPPORTUNITY ZONE



PROPERTY DETAILS

- 8,225 SF BUILDING (FOR SALE OR LEASE)
- 4,655 SF OFFICE
- 3,570 SF WAREHOUSE
- 31,250 SF LAND (0.717 ACRES)
- 15' EAVE HEIGHTS
- 36 PARKING SPACES
- SECURED/PAVED OUTSIDE STORAGE OR PARKING
- URBAN INFILL SITE IN A QUALIFIED OPPORTUNITY ZONE
- HIGH END OFFICE CONSTRUCTION WITH FLEXIBLE LAYOUT
- LOCATED OUTSIDE ANY FLOODPLAIN
- EASY ACCESS TO I-10, I-69, I-45, 610 AND DOWNTOWN
- **SALE PRICE: 1.4 MILLION**
- **MONTHLY LEASE RATE: \$1.50 NET**



CONTACT

STEVE HAZEL
shazel@insiterealty.com
713.339.5317

JOHN STAVINOKA
jstavinoka@insiterealty.com
713.339.5333

The information contained herein was obtained from sources believed reliable; however, InSite Realty Partners, L.P. makes no guarantees, warranties or representations as to the completeness or accuracy thereof. The presentation of this property is submitted subject to errors, omissions, change of price or conditions, prior sale or lease, or withdrawal without written notice.

INSITE

1410 BIGELOW

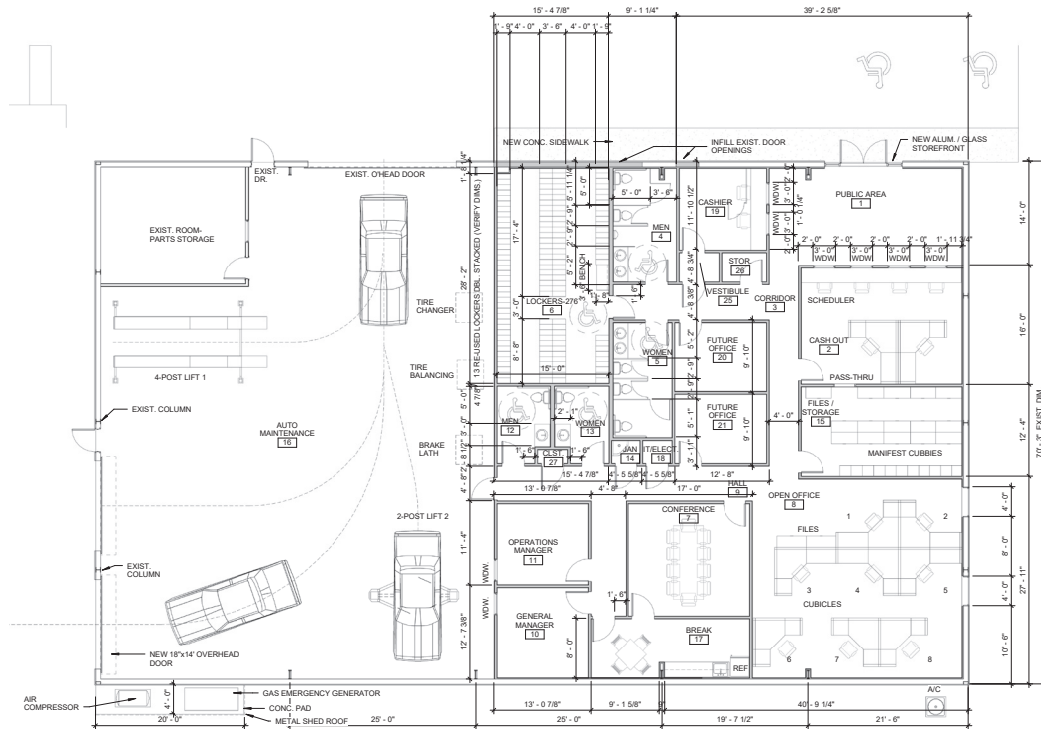

FOR SALE OR LEASE: 8,225 SF BUILDING
LAND: 31,250 SF (0.717 AC)

CONTACT

STEVE HAZEL
 shazel@insirealty.com
 713.339.5317

JOHN STAVINOHA
 jstavinoha@insirealty.com
 713.339.5333

