

RETAIL SPACE FOR LEASE



SHOPPES ON FIFTH PLAZA
994 W. 5th Avenue
Columbus, Ohio

Property Highlights

- Class A retail plaza near The Ohio State University
- 1,421 SF available (20' x 71')
- 100+ luxury apartments located directly across the street
- Over 300,000 employees within a 3-mile radius
- Join tenants: Five Guys, Papa John's, Buffalo Wild Wings, Salon Lofts, Lady Jane's Haircuts, Zest Cold Pressed, Oshio Sushi, JodyD Salon, Four String Brewing Company and more

Demographics:

Estimated Population	Daytime Employees	Average HH Income
1 Miles: 19,660	1 Miles: 65,323	3 Miles: \$74,332
3 Miles: 153,343	3 Miles: 321,912	5 Miles: \$72,517
5 Miles: 361,013	5 Miles: 443,362	7 Miles: \$70,422



Contact Agent:

Carla Massara

216.514.1400 x108

cmassara@kowitzrealstate.com

RETAIL SPACE FOR LEASE SITE PLAN

994 W. 5th Street
Columbus, Ohio

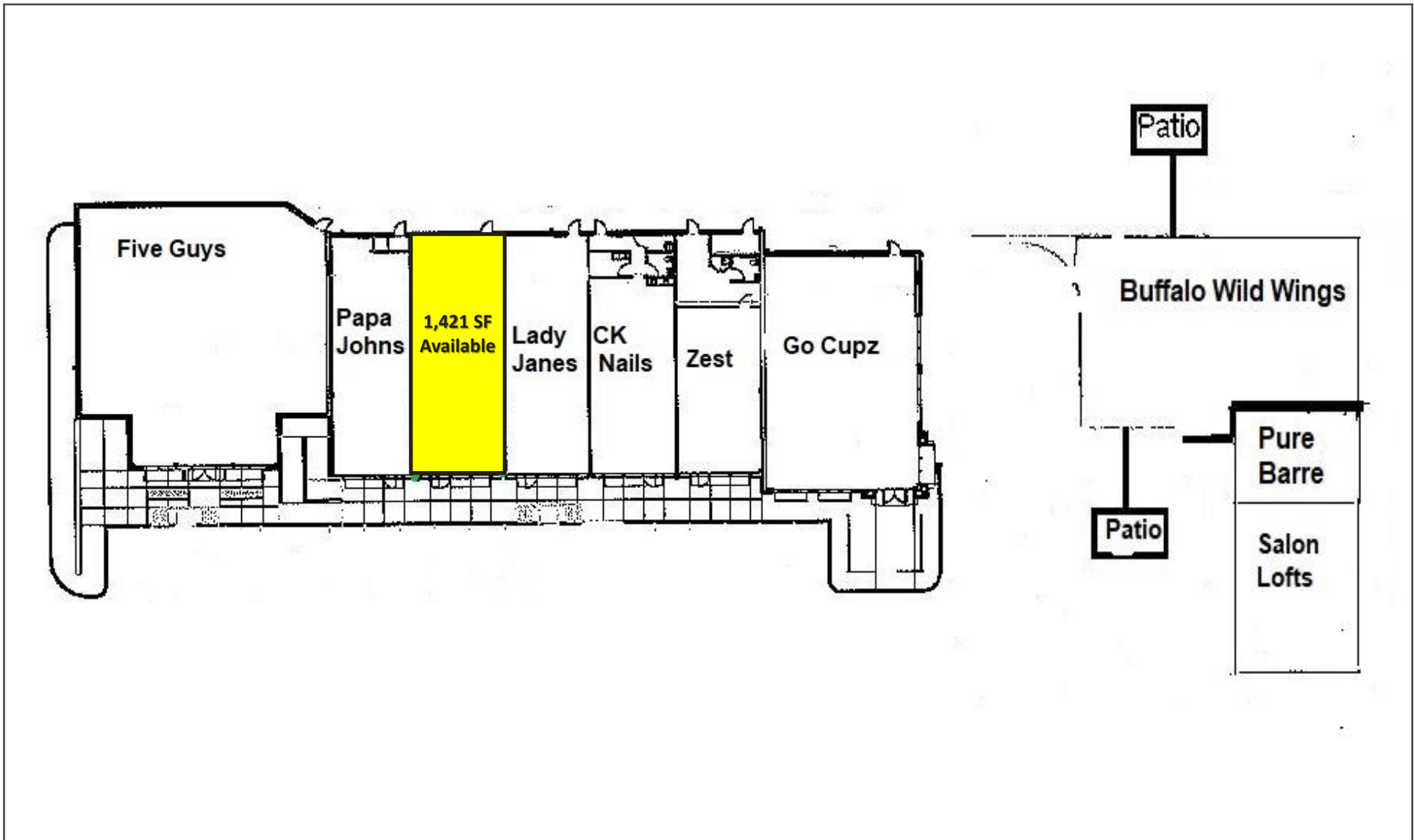

KOWIT & COMPANY
REAL ESTATE GROUP

6009-B Landerhaven Drive, Suite B
Mayfield Heights, Ohio 44124
P: 216.514.1400 | www.kowitrealestate.com

Contact Agents:

Carla Massara
216.514.1400 x108
cmassara@kowitrealestate.com

RETAIL SPACE FOR LEASE AERIAL

994 W. 5th Street
Columbus, Ohio

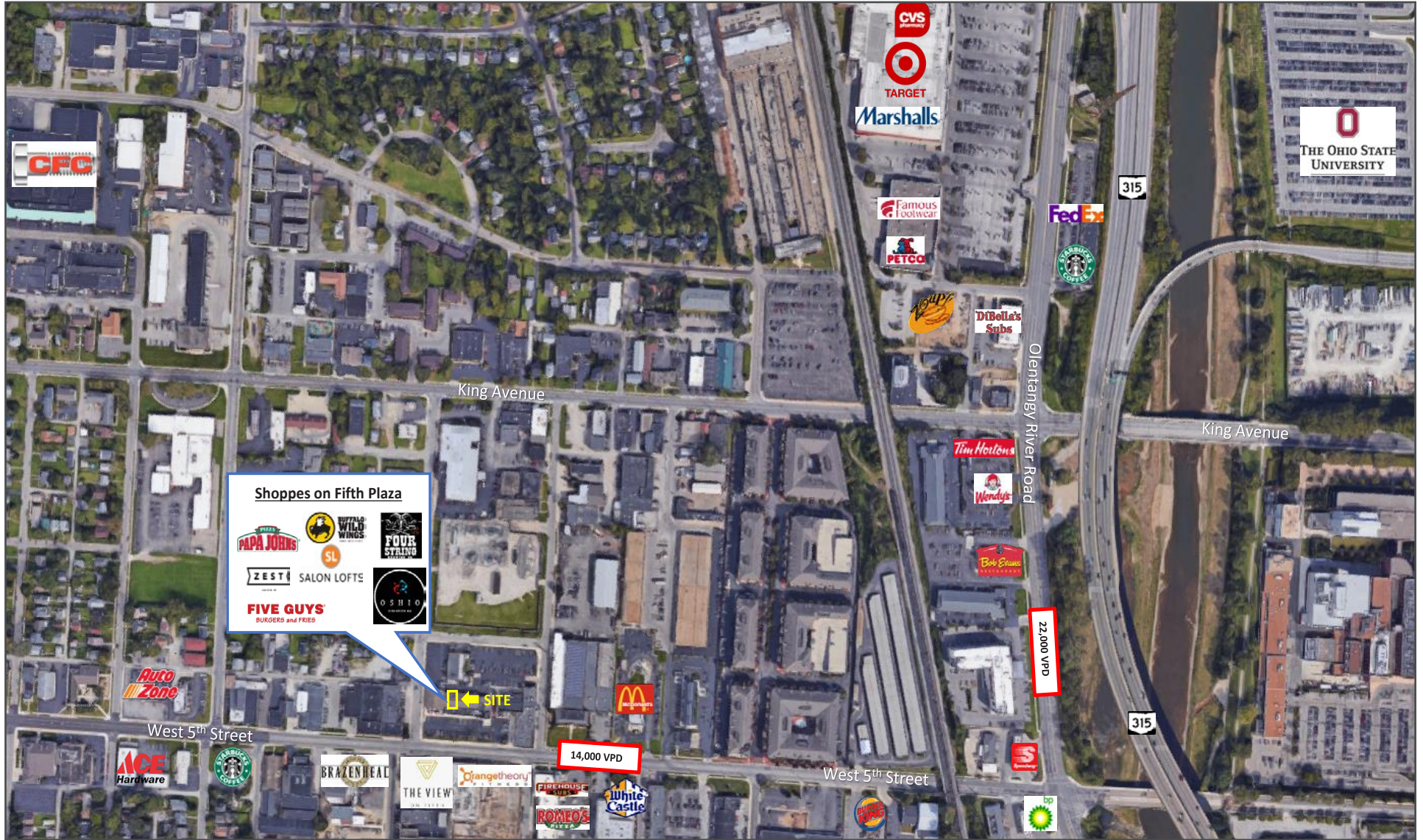

KOWIT & COMPANY
REAL ESTATE GROUP

6009-B Landerhaven Drive, Suite B
Mayfield Heights, Ohio 44124
P: 216.514.1400 | www.kowitrealestate.com

Contact Agents:

Carla Massara
216.514.1400 x108
cmassara@kowitrealestate.com

RETAIL SPACE FOR LEASE DEMOGRAPHICS

994 W. 5th Street
Columbus, Ohio

994 W 5th Ave Columbus, OH 43212		1 mi radius	3 mi radius	5 mi radius
POPULATION	2018 Estimated Population	19,660	153,343	361,013
	2023 Projected Population	20,511	162,233	388,221
	2010 Census Population	15,602	132,821	323,262
	2000 Census Population	14,818	128,526	329,872
	Projected Annual Growth 2018 to 2023	0.9%	1.2%	1.5%
	Historical Annual Growth 2000 to 2018	1.8%	1.1%	0.5%
	2018 Median Age	31.3	30.1	33.2
HOUSEHOLDS	2018 Estimated Households	11,141	65,813	153,154
	2023 Projected Households	11,615	69,731	164,701
	2010 Census Households	8,871	56,634	137,280
	2000 Census Households	8,289	55,336	139,577
	Projected Annual Growth 2018 to 2023	0.8%	1.2%	1.5%
	Historical Annual Growth 2000 to 2018	1.9%	1.1%	0.5%
RACE AND ETHNICITY	2018 Estimated White	73.3%	73.5%	64.7%
	2018 Estimated Black or African American	11.8%	13.8%	24.5%
	2018 Estimated Asian or Pacific Islander	10.0%	7.7%	5.2%
	2018 Estimated American Indian or Native Alaskan	0.3%	0.3%	0.3%
	2018 Estimated Other Races	4.5%	4.7%	5.3%
	2018 Estimated Hispanic	4.6%	4.5%	4.6%
INCOME	2018 Estimated Average Household Income	\$74,332	\$72,517	\$70,422
	2018 Estimated Median Household Income	\$62,220	\$58,978	\$56,991
	2018 Estimated Per Capita Income	\$42,158	\$31,580	\$30,157
EDUCATION (AGE 25+)	2018 Estimated Elementary (Grade Level 0 to 8)	1.1%	2.0%	2.9%
	2018 Estimated Some High School (Grade Level 9 to 11)	1.3%	6.0%	8.5%
	2018 Estimated High School Graduate	10.1%	15.5%	22.9%
	2018 Estimated Some College	14.7%	15.3%	17.2%
	2018 Estimated Associates Degree Only	4.7%	4.9%	5.7%
	2018 Estimated Bachelors Degree Only	40.9%	33.7%	25.9%
	2018 Estimated Graduate Degree	27.1%	22.6%	16.8%
BUSINESS	2018 Estimated Total Businesses	2,018	12,218	20,037
	2018 Estimated Total Employees	65,323	321,912	443,362
	2018 Estimated Employee Population per Business	32.4	26.3	22.1
	2018 Estimated Residential Population per Business	9.7	12.6	18.0



6009-B Landerhaven Drive, Suite B
Mayfield Heights, Ohio 44124
P: 216.514.1400 | www.kowitrealestate.com

Contact Agents:

Carla Massara
216.514.1400 x108
cmassara@kowitrealestate.com

RETAIL SPACE FOR LEASE AREA MAP

994 W. 5th Street
Columbus, Ohio

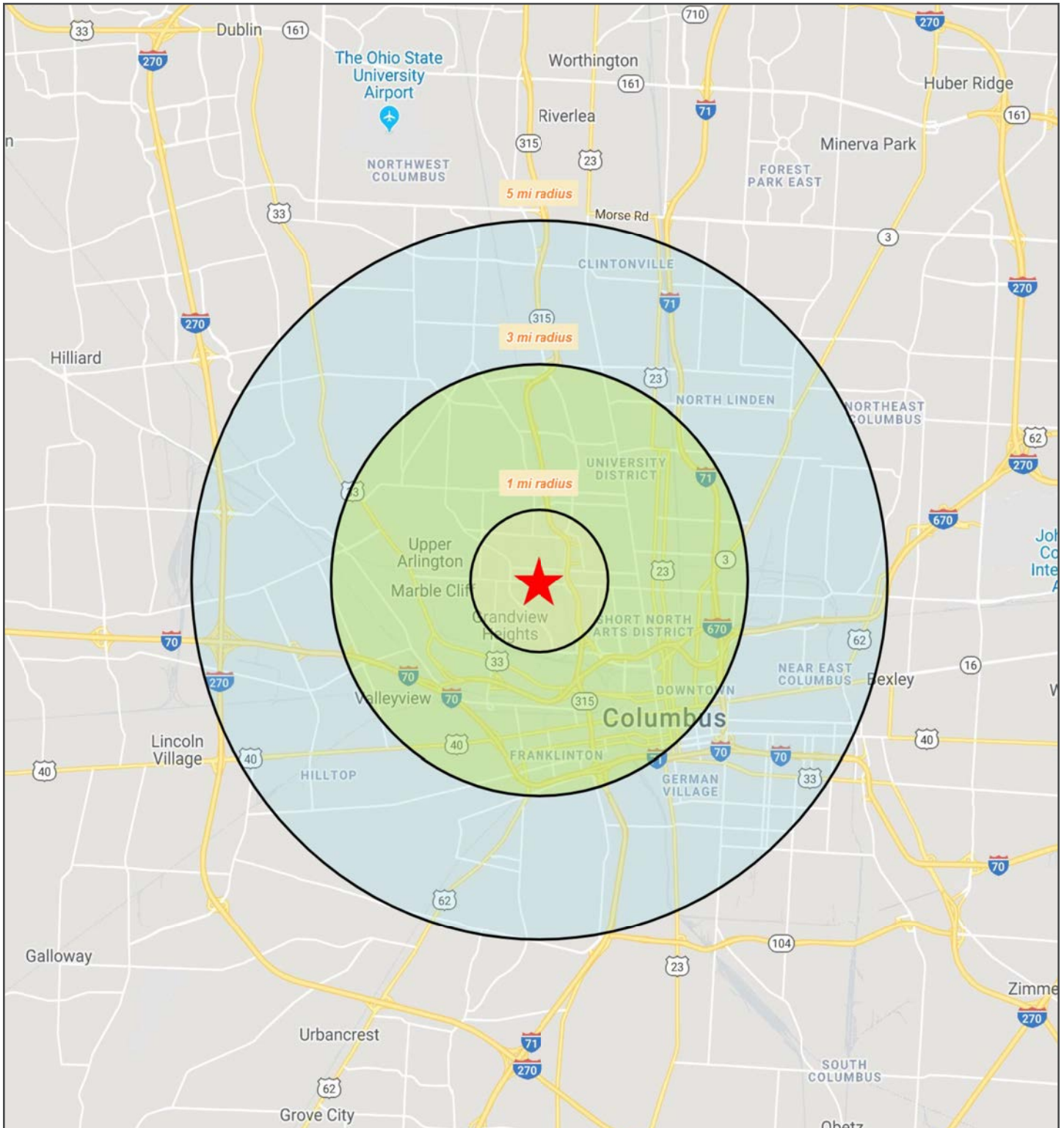

KOWIT & COMPANY
REAL ESTATE GROUP

6009-B Landerhaven Drive, Suite B
Mayfield Heights, Ohio 44124
P: 216.514.1400 | www.kowitrealestate.com

Contact Agents:

Carla Massara
216.514.1400 x108
cmassara@kowitrealestate.com