



Possible Future Exterior Rendering - Exterior is currently undergoing renovation plans but has not been formally decided by Landlord

**CEDAR VILLAGE MALL - UNDER NEW OWNERSHIP - RENOVATIONS UNDERWAY - VERY REASONABLE RATES**

The highly visible Cedar Village Mall is now under new ownership and has a number of different suite sizes to fit your business needs! This high traffic corner of I-196BL/Chicago Drive & S. Waverly Rd very easy to get to with large pylon signs is a great way to get your business name out in the Holland/Zeeland/West Michigan Market! Join Little Cesars, Family Farm & Home, Engelsman Greenhouse and also close to Engedi Church, Big Apple Bagles, Taco Bell, Speedway & Arby's! The exterior is currently under review for new design as well as a number of other improvements. Priced very reasonably with multiple suite layouts to fit your needs!

Suite	Sq. Ft.	Rent \$ SF / Yr.	CAM \$ . Ft. / Yr.	Total Per Mo (Rent+CAM)
410	1,600	\$6.00	\$3.00	<b>\$1,200.00</b>
430	3,200	\$6.00	\$3.00	<b>\$2,400.00</b>
400-B	5,983	\$6.00	\$3.00	<b>\$4,487.25</b>
400-A	6,017	\$6.00	\$3.00	<b>\$4,512.75</b>

Suite	Sq. Ft.	Rent \$ SF / Yr.	CAM \$ . Ft. / Yr.	Total Per Mo (Rent+CAM)
400-C	10,894	\$6.00	\$3.00	<b>\$8,170.50</b>
400-AB	12,000	\$6.00	\$3.00	<b>\$9,000.00</b>
400-BC	16,877	\$6.00	\$3.00	<b>\$12,657.75</b>
400	22,894	\$6.00	\$3.00	<b>\$17,170.50</b>

**Property Highlights:**

- > **HIGH VISIBILITY**
- > **Great Location: Corner of I-196BL/ Chicago Drive & S. Waverly Rd.**
- > **Flexible Terms - 12-60 Lease Terms**

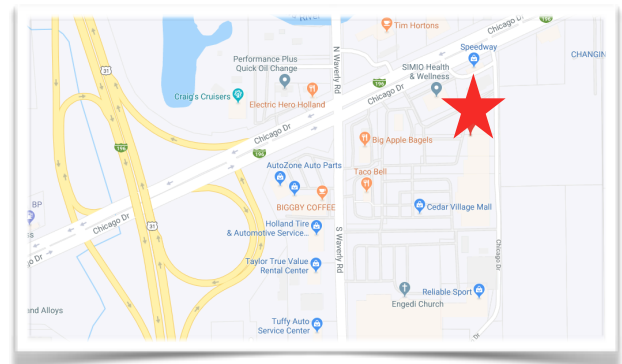

Rusty Richter  
Principal Broker  
616.551.4885  
[rustyjrich@gmail.com](mailto:rustyjrich@gmail.com)

Andy Richter  
Managing Partner  
616.551.4886  
[teamandyrichter@gmail.com](mailto:teamandyrichter@gmail.com)

4035 Chicago Drive SW | Suite 100 | Grandville, MI | [richterrealty.com](http://richterrealty.com)



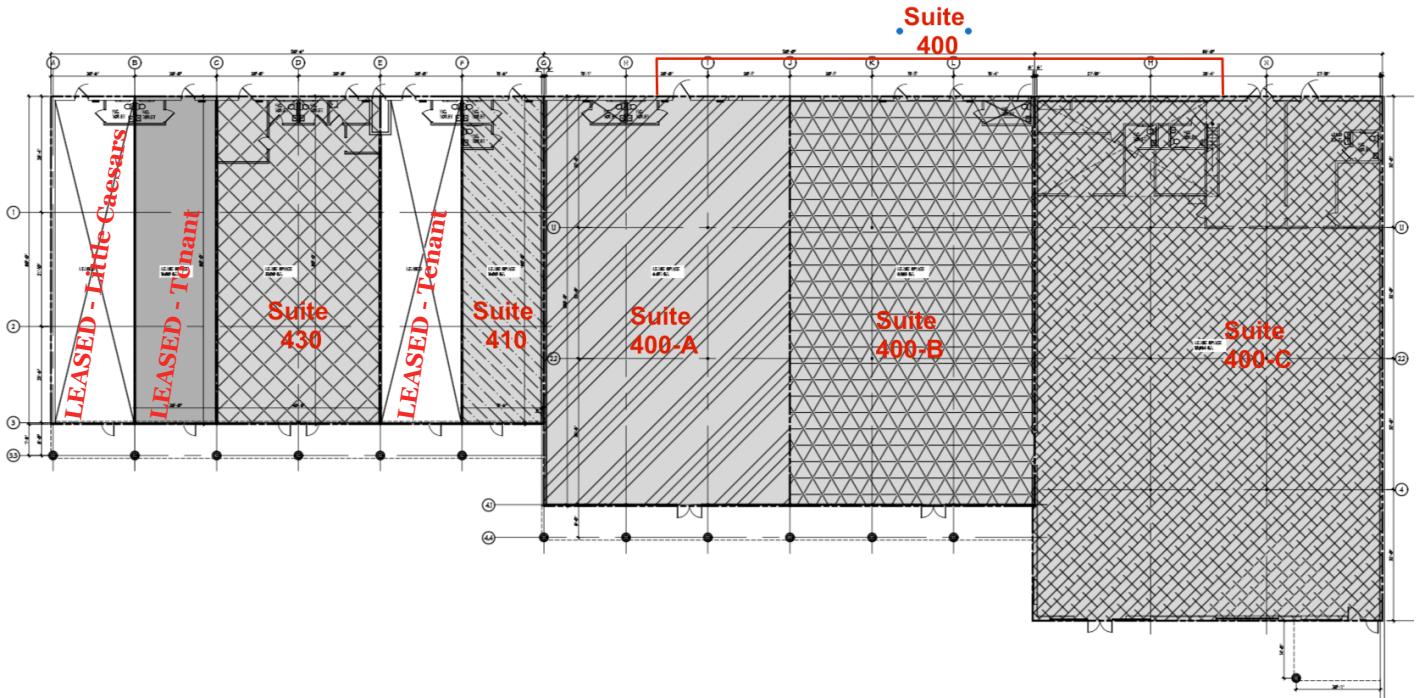

Suite	Sq. Ft.	Rent \$ SF / Yr.	CAM \$ . Ft. / Yr.	Total Per Mo (Rent+CAM)
410	1,600	\$6.00	\$3.00	<b>\$1,200.00</b>
430	3,200	\$6.00	\$3.00	<b>\$2,400.00</b>
400-B	5,983	\$6.00	\$3.00	<b>\$4,487.25</b>
400-A	6,017	\$6.00	\$3.00	<b>\$4,512.75</b>

Suite	Sq. Ft.	Rent \$ SF / Yr.	CAM \$ . Ft. / Yr.	Total Per Mo (Rent+CAM)
400-C	10,894	\$6.00	\$3.00	<b>\$8,170.50</b>
400-AB	12,000	\$6.00	\$3.00	<b>\$9,000.00</b>
400-BC	16,877	\$6.00	\$3.00	<b>\$12,657.75</b>
400	22,894	\$6.00	\$3.00	<b>\$17,170.50</b>

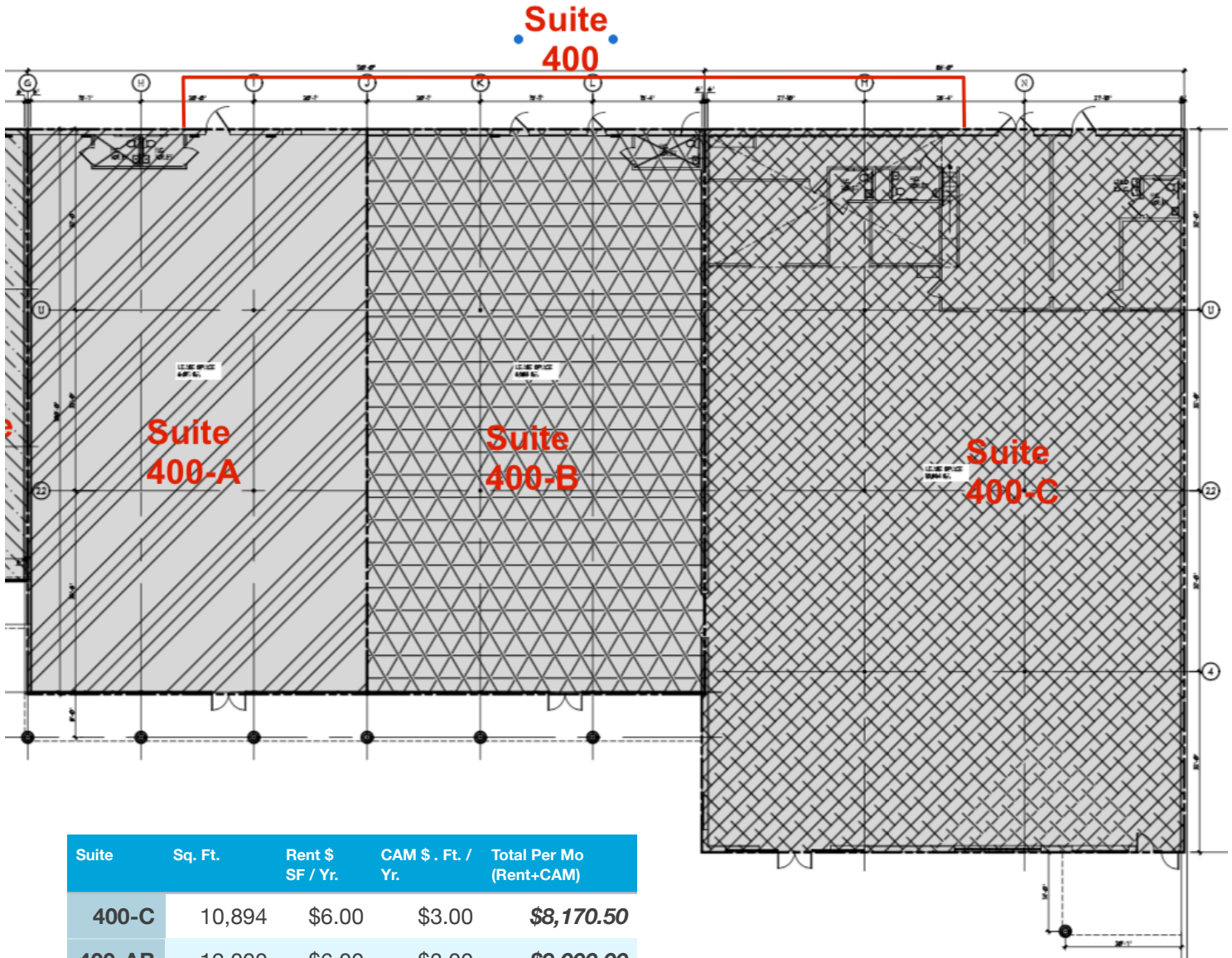

Suite	Sq. Ft.	Rent \$ SF / Yr.	CAM \$ . Ft. / Yr.	Total Per Mo (Rent+CAM)
400-C	10,894	\$6.00	\$3.00	<b>\$8,170.50</b>
400-AB	12,000	\$6.00	\$3.00	<b>\$9,000.00</b>
400-BC	16,877	\$6.00	\$3.00	<b>\$12,657.75</b>
400	22,894	\$6.00	\$3.00	<b>\$17,170.50</b>
400-B	5,983	\$6.00	\$3.00	<b>\$4,487.25</b>
400-A	6,017	\$6.00	\$3.00	<b>\$4,512.75</b>

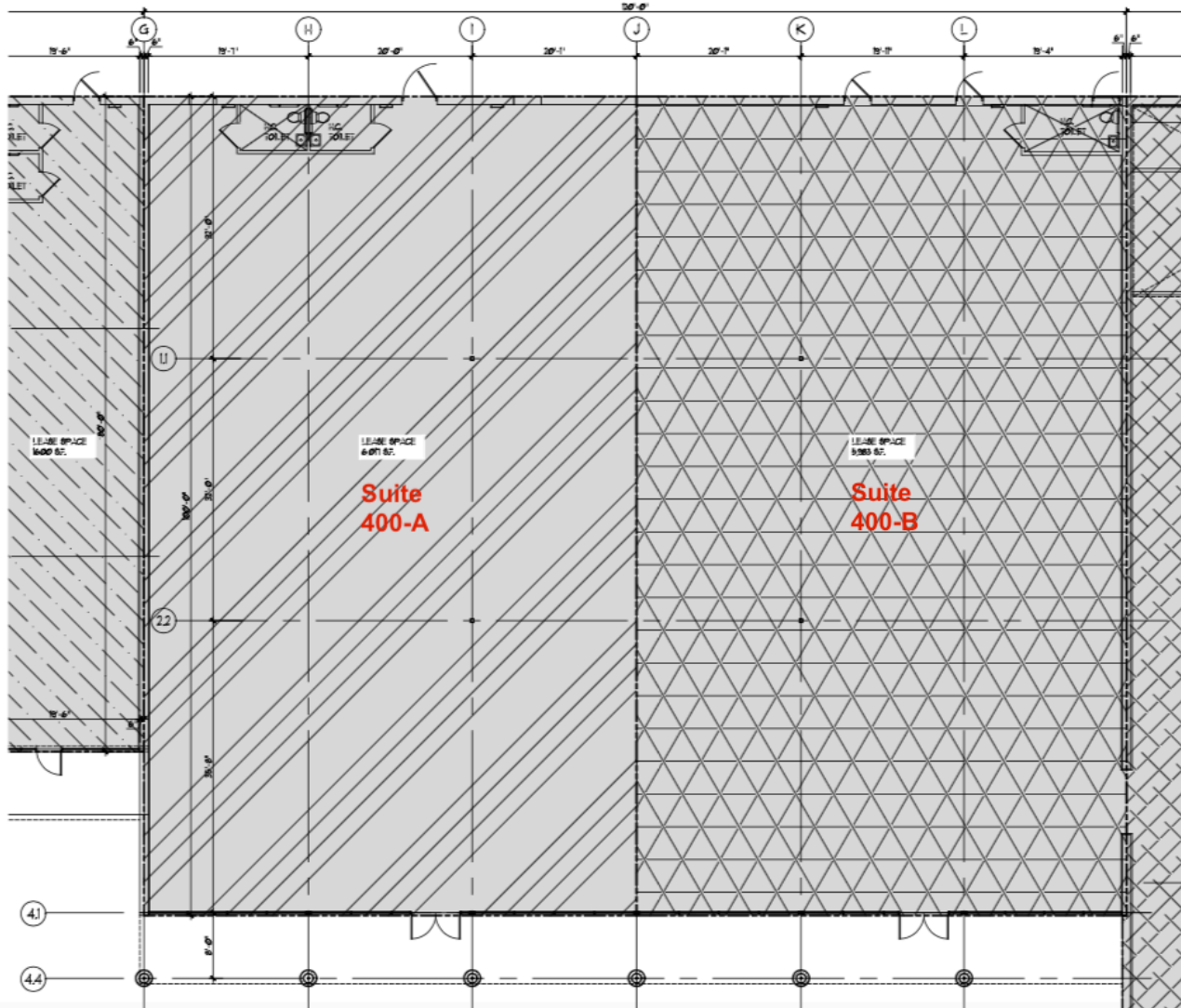

Suite	Sq. Ft.	Rent \$ SF / Yr.	CAM \$ . Ft. / Yr.	Total Per Mo (Rent+CAM)
400-B	5,983	\$6.00	\$3.00	<b>\$4,487.25</b>
400-A	6,017	\$6.00	\$3.00	<b>\$4,512.75</b>
400-AB	12,000	\$6.00	\$3.00	<b>\$9,000.00</b>

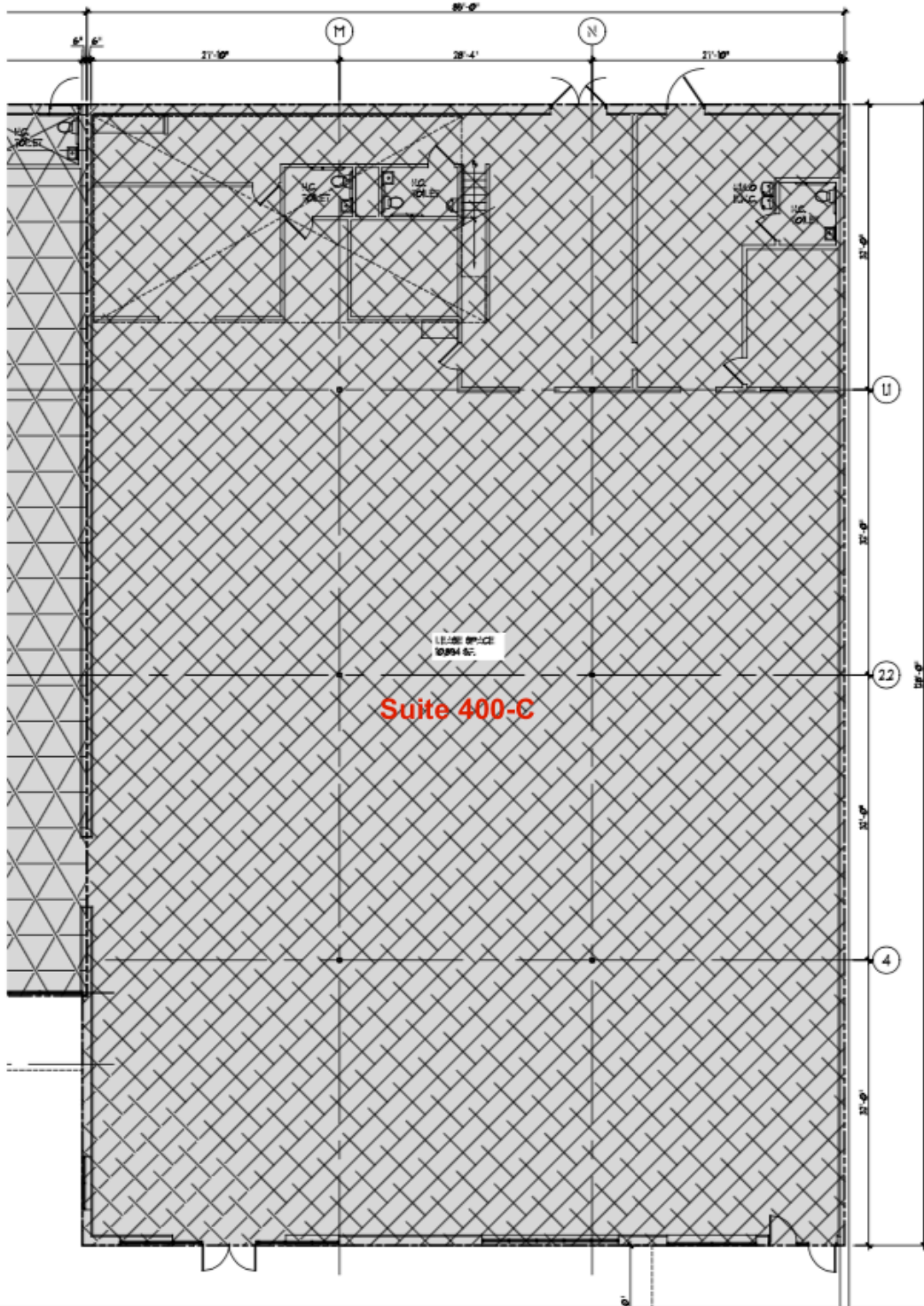

Suite	Sq. Ft.	Rent \$ SF / Yr.	CAM \$ . Ft. / Yr.	Total Per Mo (Rent+CAM)
400-C	10,894	\$6.00	\$3.00	<b>\$8,170.50</b>

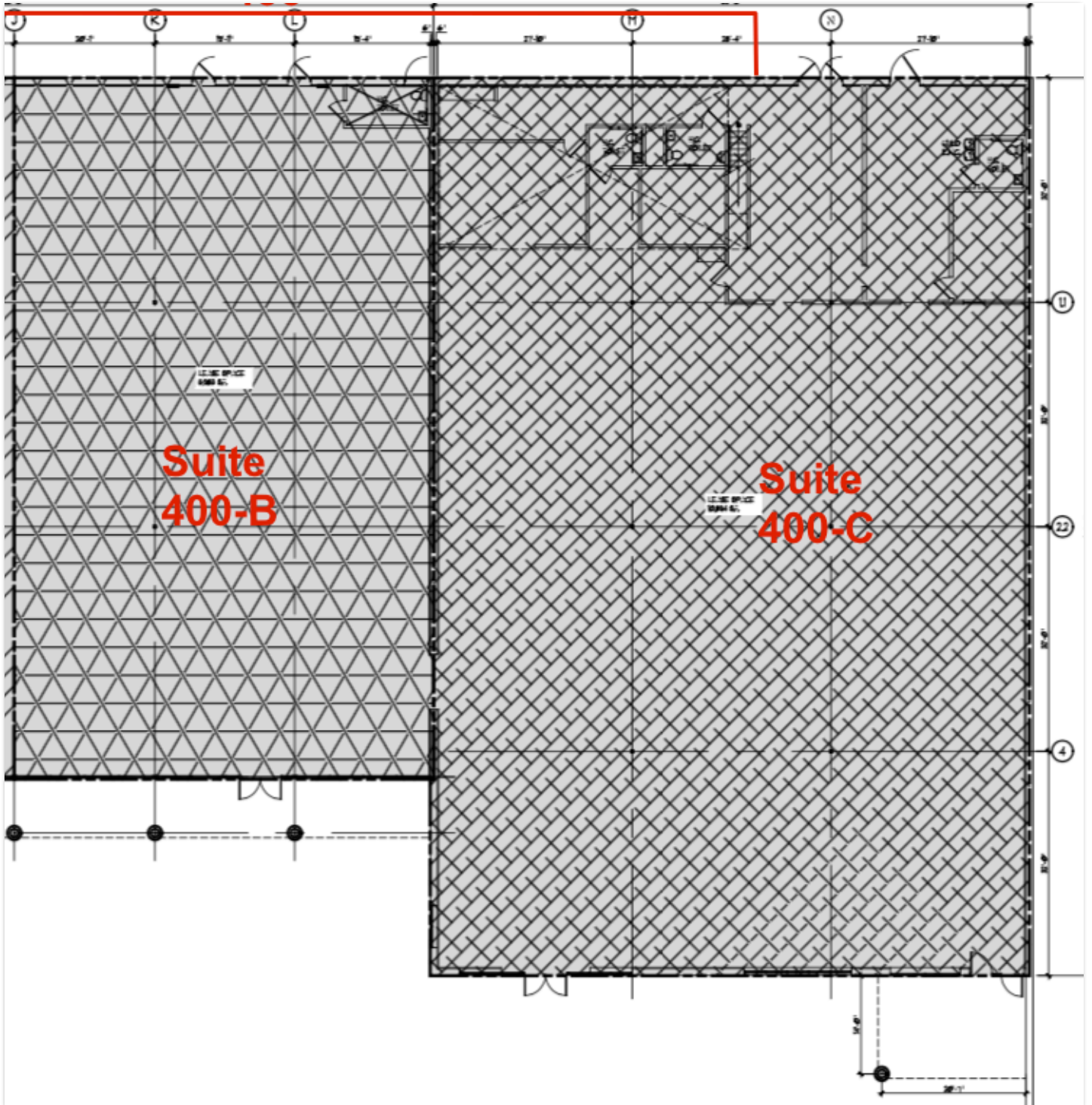

Suite	Sq. Ft.	Rent \$ SF / Yr.	CAM \$ . Ft. / Yr.	Total Per Mo (Rent+CAM)
400-BC	16,877	\$6.00	\$3.00	\$12,657.75

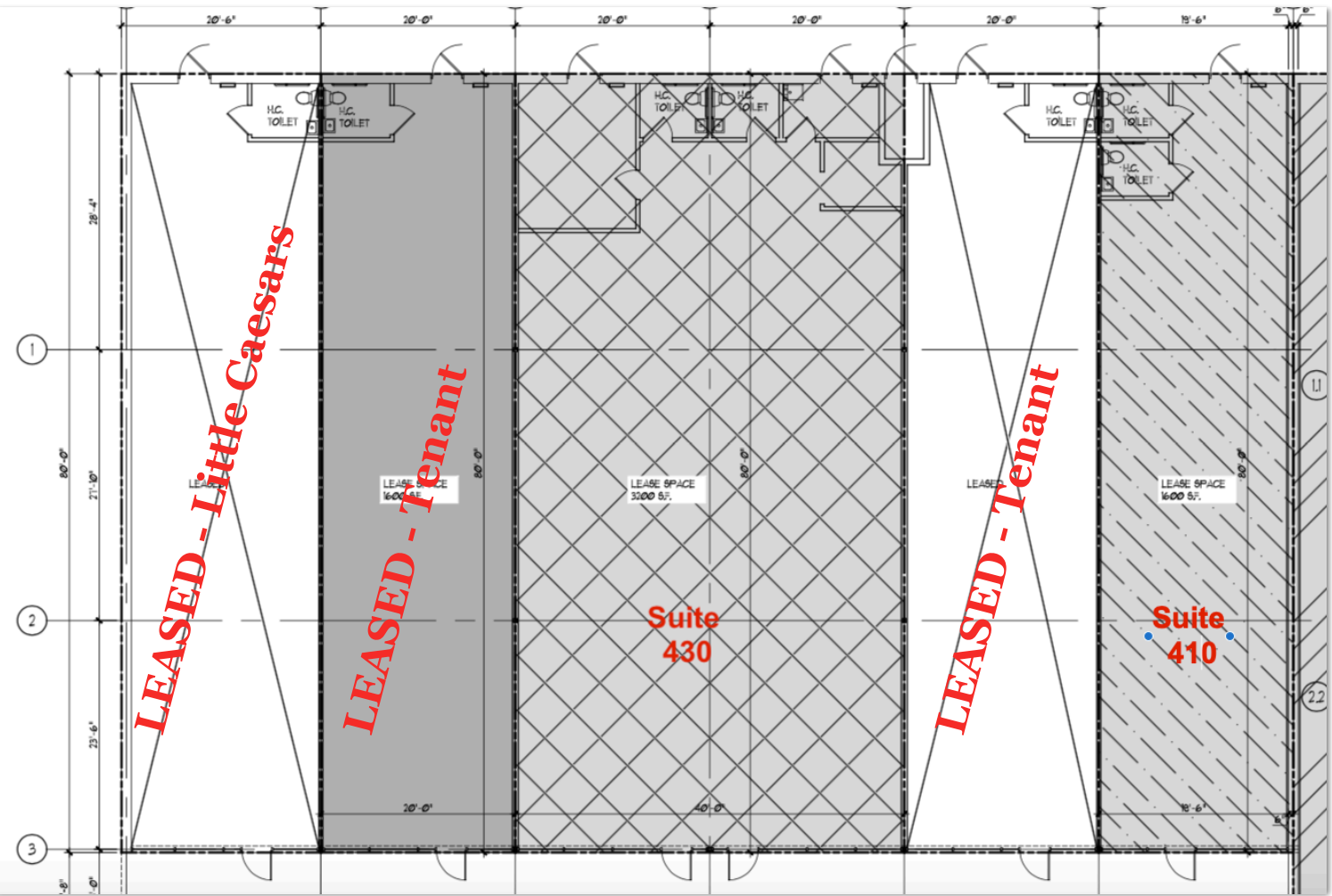

Suite	Sq. Ft.	Rent \$ SF / Yr.	CAM \$ . Ft. / Yr.	Total Per Mo (Rent+CAM)
410	1,600	\$6.00	\$3.00	<b>\$1,200.00</b>
430	3,200	\$6.00	\$3.00	<b>\$2,400.00</b>





# 716 Chicago Drive - Holland, MI

For Lease: Retail /Office

