

SAND HILL: NEW SHOPS AND RETAIL PADS AVAILABLE

NEC CONSTITUTION & MARKSCHEFFEL | COLORADO SPRINGS, COLORADO 80939

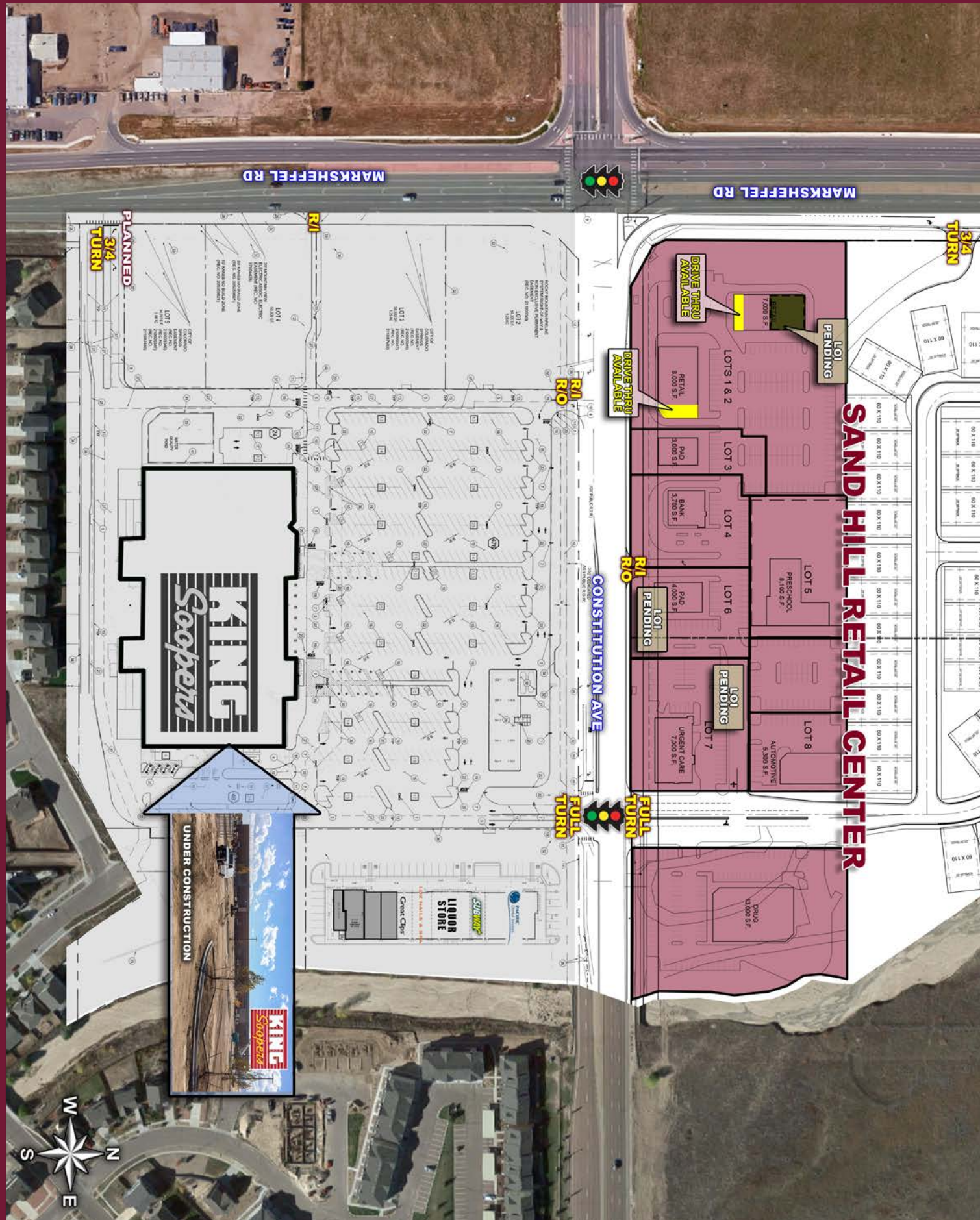

INFORMATION

- King Soopers shadow-anchored pads & shops
- Grocer expected to open Q3 2017
- Pads available Q1 2018 and shops Q2 2018
- Strong existing & planned residential densities
- Fantastic visibility and access
- All pads on Constitution facing King Soopers front door
- Significant monument signage at intersection

DEMOGRAPHICS

	1 MILE	2 MILE	3 MILE	5 MILE
Est. Population	9,677	30,561	55,818	150,869
Avg Household Inc	\$90,628	\$81,640	\$80,260	\$71,401
Employees	922	7,051	21,615	56,814
Businesses	86	601	1,520	5,048

Demographics Source: Applied Geographic Solutions 2016

TRAFFIC COUNTS

On Constitution Ave west of Markscheffel Rd	12,001 cars/day
On Constitution Ave east of Markscheffel Rd	9,082 cars/day
On Markscheffel Rd north of Constitution Ave	14,534 cars/day
On Markscheffel Rd south of Constitution Ave	5,156 cars/day

Source: Google Earth 2012



1301 Canyon Boulevard | Suite 228 | Boulder, Colorado 80302 | 303.534.0900 Fax: 303.831.1333 | www.sullivanhayes.com

SullivanHayes
B R O K E R A G E

we are
RETAIL
A MEMBER OF
CHAINLINKS
RETAIL ADVISORS

Michael DePalma
720.382.7597 | mdepalma@sullivanhayes.com
David Dobek
720.382.7598 | ddobek@sullivanhayes.com
Sean Kulzer
720.382.7596 | skulzer@sullivanhayes.com

NEC CONSTITUTION & MARKSCHEFFEL



The information contained herein has been compiled from sources believed to be reliable. However, SullivanHayes has not independently verified the same and makes no guarantee, warranty or representation about such information. Any opinions, assumptions or projections used are for illustrative purposes only and do not necessarily represent the current or future performance of the property. Site plans, renderings, aerials, marketing data, pricing and other terms are subject to change at any time. You and your tax, financial and legal advisors should make a thorough independent investigation of the property to determine its suitability to your needs. SullivanHayes, its broker associates and its salespersons, are or will be acting as agents of the seller/lessor with the duty to represent the interests of the seller/lessor. SullivanHayes will not act as your agent unless an agency agreement is signed and in effect.