

# For Lease

# 33-01 HUNTERS POINT AVE, LONG ISLAND CITY

**Sholom & Zuckerbrot Realty LLC**  
Established 1962

## Office Space, Industrial Space, Flex Space You Decide!

### The Swiss Army Knife of Real Estate

- ✓ 11,000 sq. ft. of space configured to meet your tenant's needs
- ✓ 11,000 sq. ft. of office space
- ✓ 5,000 sq. ft. of office with 6,000 sq. ft. of industrial
- ✓ 11,000 sq. ft. of industrial
- ✓ Parking available
- ✓ Walking distance to #7 subway
- ✓ Your Vision!

**Pricing Available Upon Request**

### Location

**Walking distance to 7 subway. At LIE, BQE, less than 5 minutes to Midtown Tunnel and 59<sup>th</sup> Street Bridge**



*For Further Information Please Contact Exclusive Building Agent:*

**John G.J. Ritter – Assoc. Broker**  
**(718) 371-0131 jritter@s-z.com**

**Kaufman Astoria Studios 35-11 35<sup>th</sup> Avenue, Long Island City, NY 11106 • (718) 392-5959 • Fax (718) 937-6546**  
**www.s-z.com**

Although all information is from sources deemed reliable, and no representation is made as to the accuracy thereof, it is submitted subject to errors, omissions, changes of price, prior sale, or withdrawal without notice

# For Lease

# 33-01 HUNTERS POINT AVE, LONG ISLAND CITY

**Sholom &  
Zuckerbrot Realty LLC**  
Established 1962

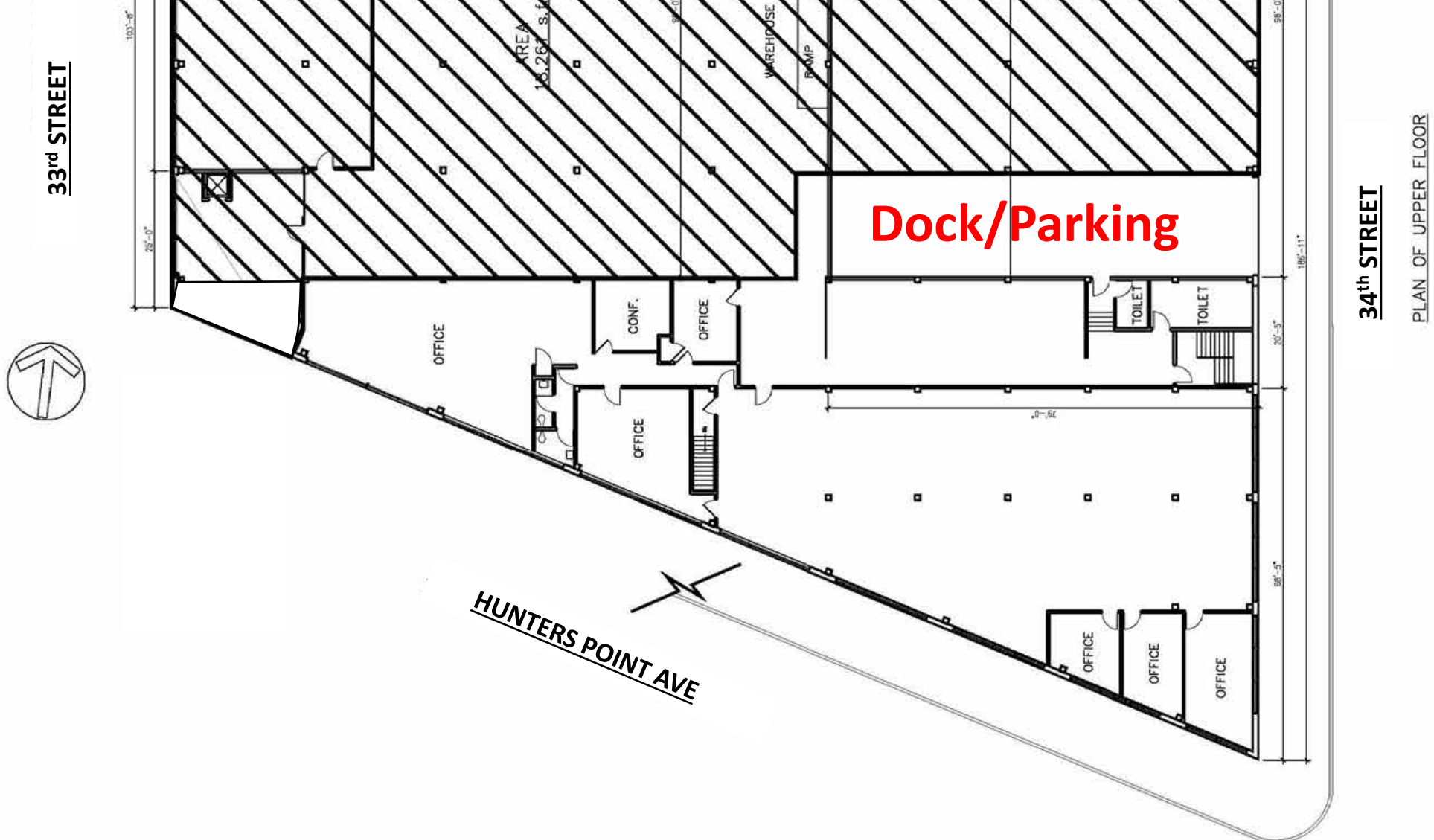

*For Further Information Please Contact Exclusive Building Agent:*

**John G.J. Ritter – Assoc. Broker**

**(718) 371-0131 [jritter@s-z.com](mailto:jritter@s-z.com)**

**Kaufman Astoria Studios 35-11 35th Avenue, Long Island City, NY 11106 • (718) 392-5959 • Fax (718) 937-6546**

**[www.s-z.com](http://www.s-z.com)**

Although all information is from sources deemed reliable, and no representation is made as to the accuracy thereof, it is submitted subject to errors, omissions, changes of price, prior sale, or withdrawal without notice



# For Lease

## 33-01 HUNTERS POINT AVE, LONG ISLAND CITY

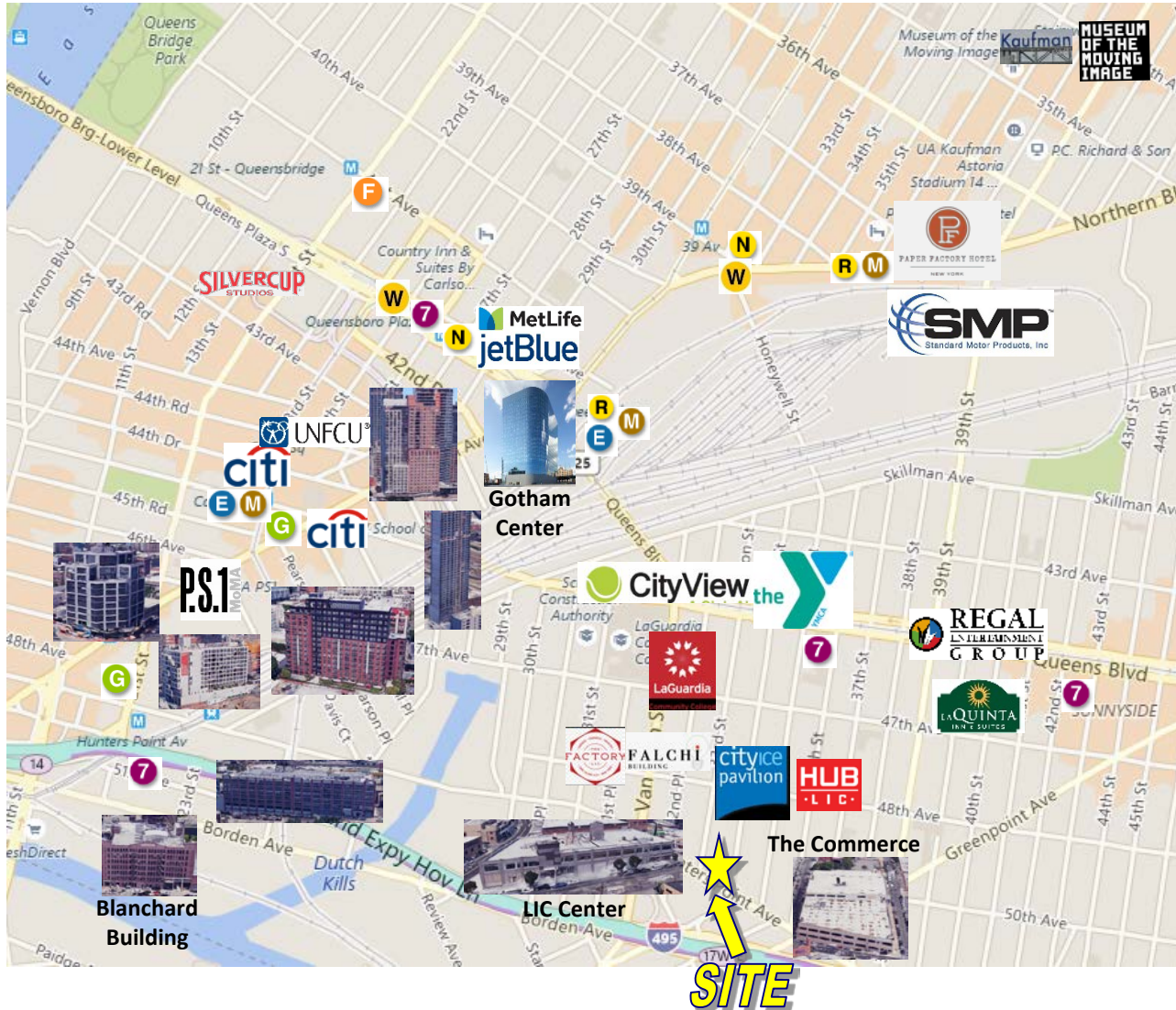

*For Further Information Please Contact Exclusive Building Agent:*  
**John G.J. Ritter – Assoc. Broker**  
**(718) 371-0131 jritter@s-z.com**

**Kaufman Astoria Studios 35-11 35th Avenue, Long Island City, NY 11106 • (718) 392-5959 • Fax (718) 937-6546**  
**www.s-z.com**

Although all information is from sources deemed reliable, and no representation is made as to the accuracy thereof, it is submitted subject to errors, omissions, changes of price, prior sale, or withdrawal without notice

# For Lease

# 33-01 HUNTERS POINT AVE, LONG ISLAND CITY

**Sholom & Zuckerbrot Realty LLC**  
Established 1962



*For Further Information Please Contact Exclusive Building Agent:*

**John G.J. Ritter – Assoc. Broker**  
**(718) 371-0131 [jritter@s-z.com](mailto:jritter@s-z.com)**

**Kaufman Astoria Studios 35-11 35<sup>th</sup> Avenue, Long Island City, NY 11106 • (718) 392-5959 • Fax (718) 937-6546**

**[www.s-z.com](http://www.s-z.com)**

Although all information is from sources deemed reliable, and no representation is made as to the accuracy thereof, it is submitted subject to errors, omissions, changes of price, prior sale, or withdrawal without notice