

1177 CORPORATE GROVE

Buffalo Grove, Illinois

15,300 SF
AVAILABLE FOR SALE OR LEASE



Building Specifications

Building Size:	15,300 SF
Land Size:	0.93 Acres
Office:	20%
Ceiling Height:	21'
Loading:	2 Interior Docks 1 Drive-in Door
Year Built:	1995
Sprinklered:	Yes
Lease Rate:	\$6.95 PSF Net
Sale Price:	Subject to Offer
Real Estate Taxes:	\$2.21 PSF (2017 Paid 2018)
CAM/OpEx:	Tenant's Responsibility

Comments:

- Professionally owned and managed
- Freestanding high image building
- Minutes to I-294/I-94



Industrial Real Estate Investments, Brokerage and Management

970 N. Oaklawn Avenue, Suite 300
Elmhurst, Illinois 60126
TEL: 630-333-1900
www.valueindustrialpartners.com

For Further Information, Please Contact:

BRIAN M. LISTON
Principal

bliston@valueindustrialpartners.com
630.333.1900

BRIAN P. GEDVILAS
Director of Leasing

bgedvilas@valueindustrialpartners.com
630.333.1900

Officers of the firm have an ownership interest in this property.
Submitted subject to error, change in status or withdrawal without notice.



1177 CORPORATE GROVE

Buffalo Grove, Illinois

LAYOUT

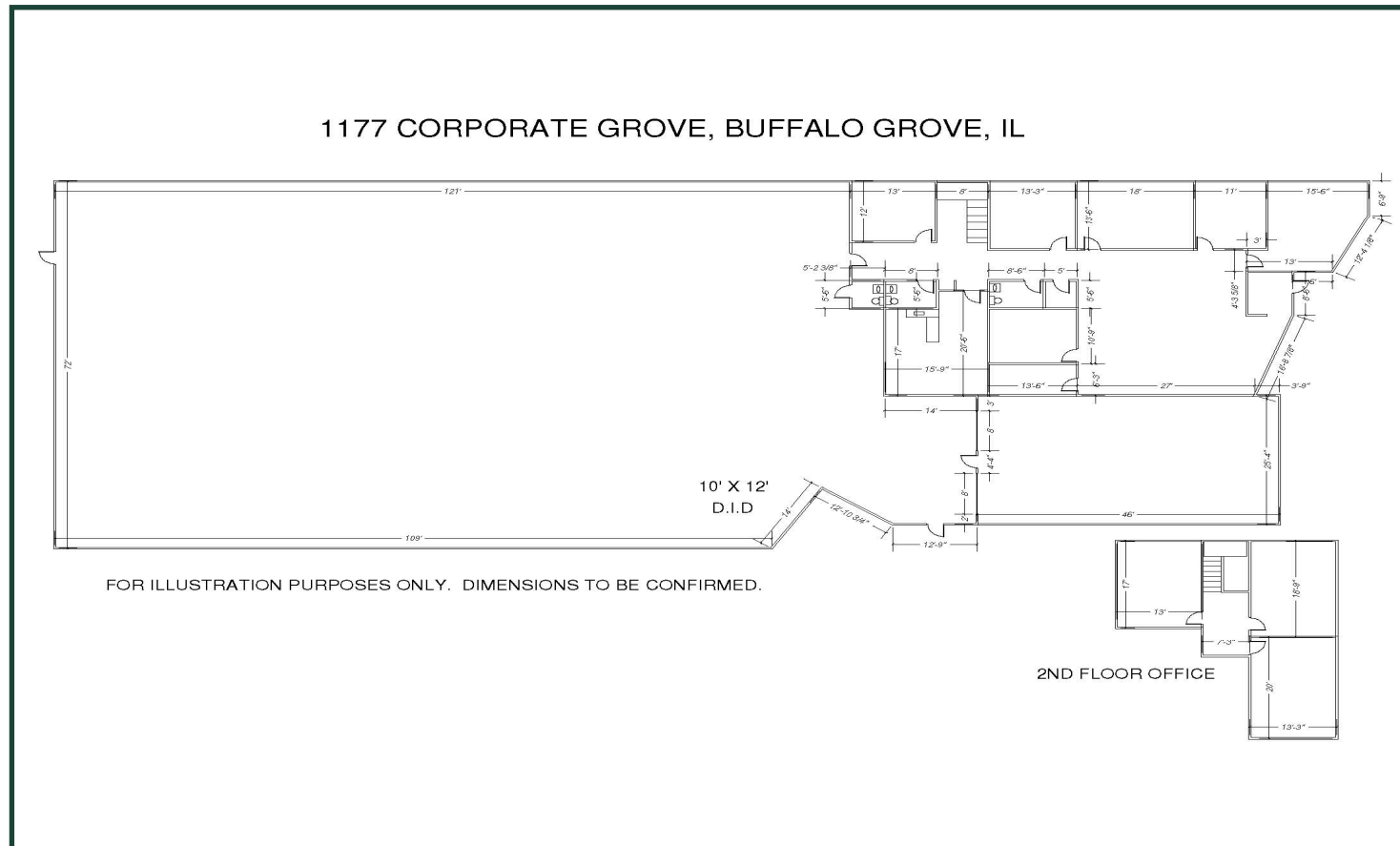

Industrial Real Estate Investments, Brokerage and Management

970 N. Oaklawn Avenue, Suite 300
Elmhurst, Illinois 60126
TEL: 630-333-1900
www.valueindustrialpartners.com

For Further Information, Please Contact:

BRIAN M. LISTON
Principal

bliston@valueindustrialpartners.com
630.333.1900

BRIAN P. GEDVILAS
Director of Leasing

bgedvilas@valueindustrialpartners.com
630.333.1900

Officers of the firm have an ownership interest in this property.
Submitted subject to error, change in status or withdrawal without notice.

1177 CORPORATE GROVE

Buffalo Grove, Illinois

MAP AERIAL

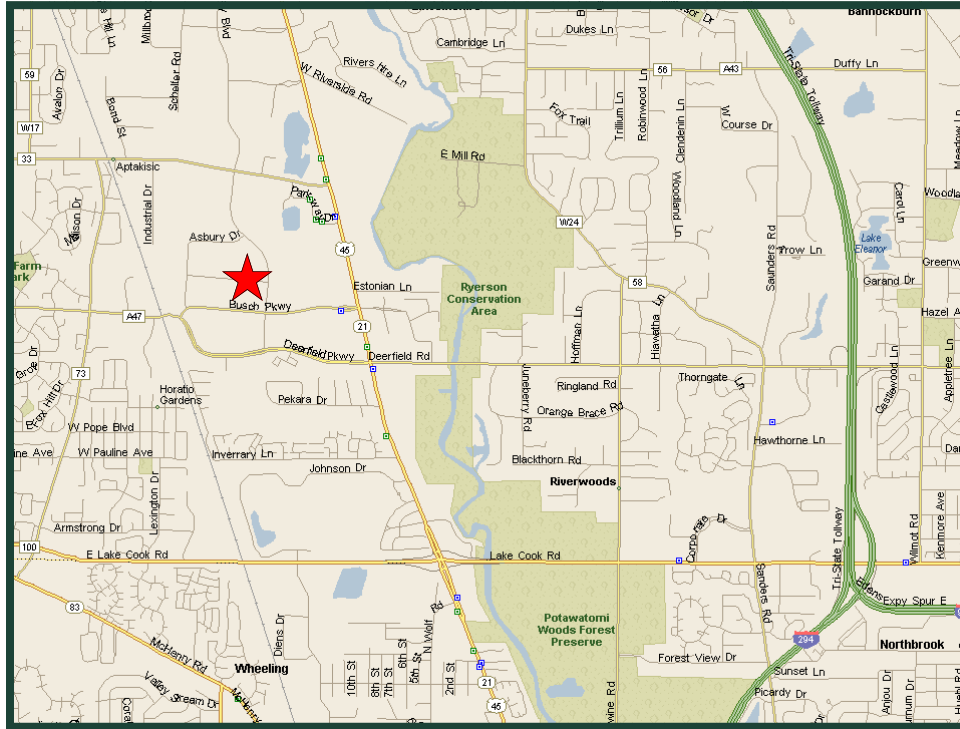

**VALUE
INDUSTRIAL
PARTNERS, LLC**

Industrial Real Estate Investments, Brokerage and Management

970 N. Oaklawn Avenue, Suite 300
Elmhurst, Illinois 60126
TEL: 630-333-1900
www.valueindustrialpartners.com

For Further Information, Please Contact:

BRIAN M. LISTON
Principal

bliston@valueindustrialpartners.com
630.333.1900

BRIAN P. GEDVILAS
Director of Leasing

bgedvilas@valueindustrialpartners.com
630.333.1900

Officers of the firm have an ownership interest in this property.
Submitted subject to error, change in status or withdrawal without notice.