

FOR LEASE

WILSONVILLE BUSINESS CENTER BUILDING 31

9025 SW HILLMAN COURT :: WILSONVILLE, OR 97070

Get out of the congestion of Beaverton and Hillsboro and discover the easily accessible and transit friendly flex/warehouse opportunities in Wilsonville, OR, at Wilsonville Business Center. Wilsonville Business Center offers immediate access to I-5 and the surrounding service areas of south Portland. It is convenient to a highly trained work force and an array of area amenities that provide essential services to the areas employment base.

LOCATION MAP



TRANSIT MAP

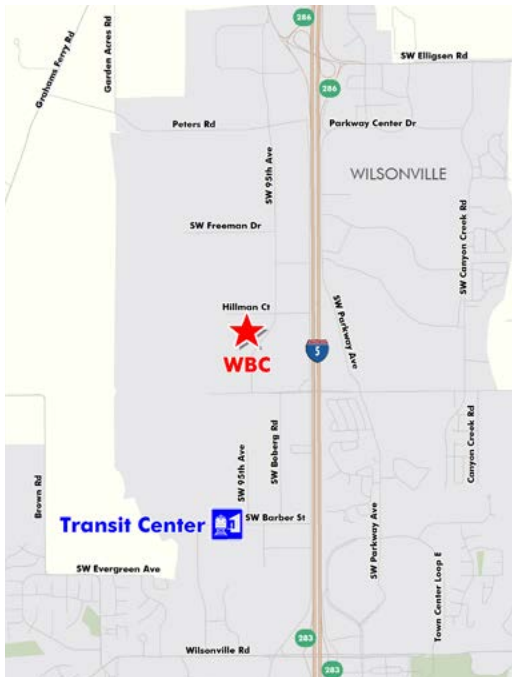

www.cbre.com/wbc

FEATURES:

- Corporate image and I-5 visibility
- Front door transit service to the project
- 16' clear height
- Up to 3/1,000 parking
- Grade level loading with common-dock access
- Easy access to I-5 and I-205
- Competitive lease rates (Call to request pricing sheet)

FOR MORE INFORMATION PLEASE CONTACT

Andy Kangas

503.221.4874

andy.kangas@cbre.com

www.cbre.com/andy.kangas

Preston C. Greene

503.221.4887

preston.greene@cbre.com

www.cbre.com/preston.greene

The brokers are licensed in the State of Oregon



FOR LEASE

WILSONVILLE BUSINESS CENTER - BUILDING 31

9025 SW HILLMAN COURT :: WILSONVILLE, OR 97070

GENERAL BUILDING SPECIFICATIONS:

BUILDING TOTAL
54,485 SF

SITE AREA:
144,570 SF

PARKING
146 SPACES - 2.8/1,000

CLEAR HEIGHT:
16'

ONE COMMON DOCK SERVES
THE BUILDING

SPACES AVAILABLE:

SPACE A

SUITE 3128 & 3132
11,583 SF shell
5,286 SF office

SPACE B

SUITE 3112
4,774 SF shell
2,443 SF office

WAREHOUSE

OFFICE

LEASED

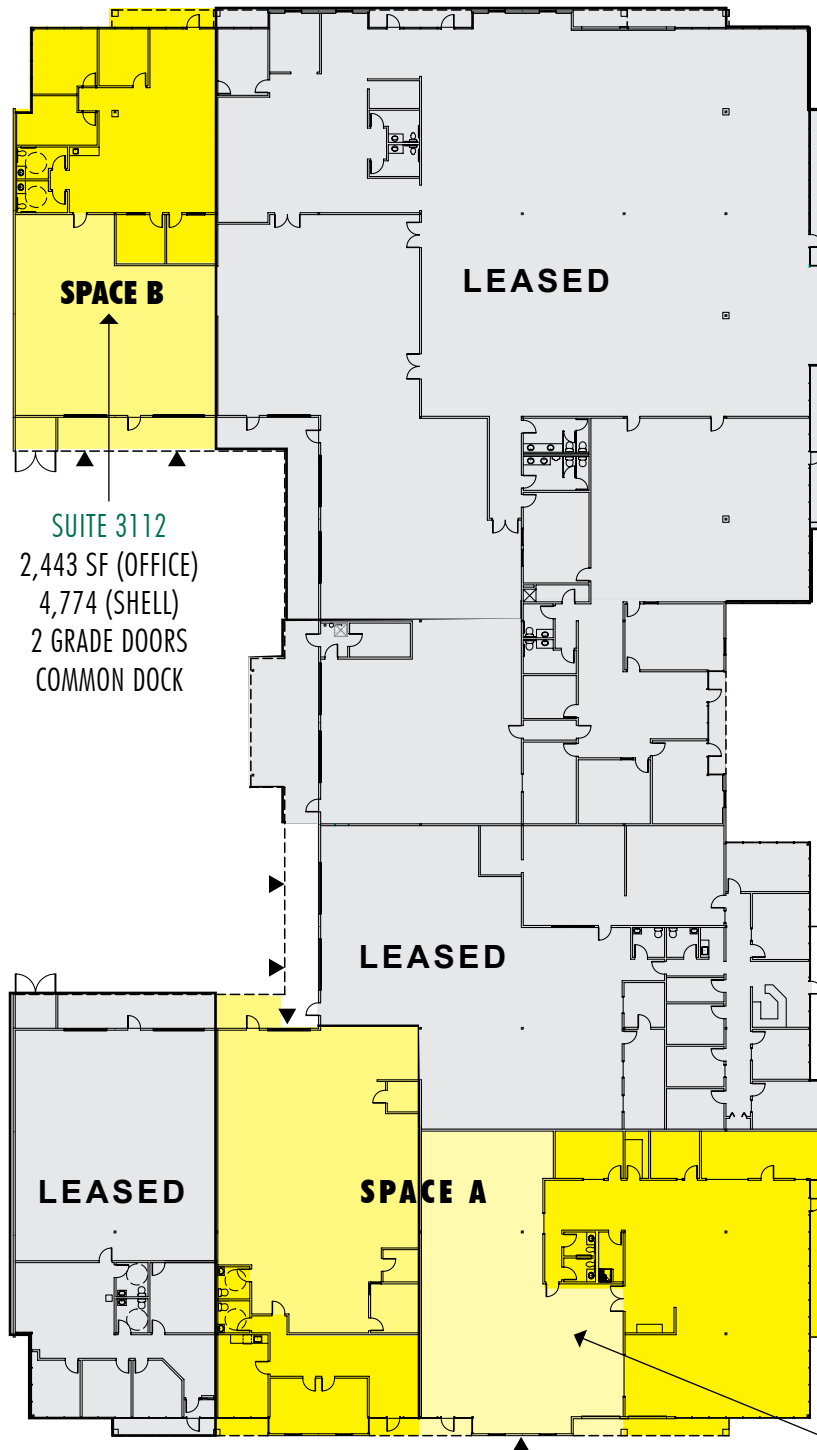

SUITE 3112
2,443 SF (OFFICE)
4,774 (SHELL)
2 GRADE DOORS
COMMON DOCK

SUITE 3128 & 3132
5,286 SF (OFFICE)
11,583 SF (SHELL)
2 GRADE DOORS
COMMON DOCK

CBRE | 1300 SW Fifth Ave. | Suite 3000 | Portland, OR 97201

© 2015 CBRE, Inc. This information has been obtained from sources believed reliable. We have not verified it and make no guarantee, warranty or representation about it. Any projections, opinions, assumptions or estimates used are for example only and do not represent the current or future performance of the property. You and your advisors should conduct a careful, independent investigation of the property to determine to your satisfaction the suitability of the property for your needs.

CBRE