

7,600 SF TOTAL



## 7,600 SF Office/Warehouse with 0.30 Acre Yard.

### Property Highlights

- Sales Price: ~~\$729,000~~  
**REDUCED! \$679,000**
- Lease Rate: \$0.65 NNN
- Size: 7,600 SF Total  
1,800 SF Office  
5,800 SF Warehouse
- Yard: 0.30 acres fenced
- Power: 3-phase
- Loading: GL 10' x 12' (8)  
Pull-through bays (2)
- Cranes: 1-ton jib cranes (2)
- Compressor: 10 hp, 2-stage, 120 gal,  
drops throughout bldg.
- Clear Height: 14'
- Zoning: M-2

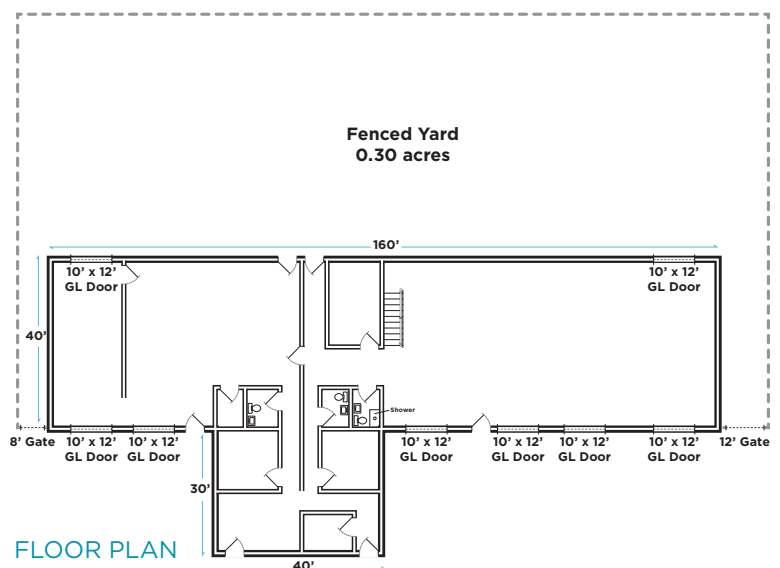

**Josh Wangsgard, MBA**  
Industrial/Investment Specialist  
+1 801 784 5322  
jwangsgard@comre.com

372 24<sup>th</sup> Street, Suite 320  
Ogden, Utah 84401  
Main +1 801 525 3000  
Fax +1 801 525 9596  
**comre.com**

*Independently Owned and Operated / A Member of the Cushman & Wakefield Alliance*

Cushman & Wakefield Copyright 2017. No warranty or representation, express or implied, is made to the accuracy or completeness of the information contained herein, and same is submitted subject to errors, omissions, change of price, rental or other conditions, withdrawal without notice, and to any special listing conditions imposed by the property owner(s). As applicable, we make no representation as to the condition of the property (or properties) in question. (path:G:\1 - Projects\Ogden\Wangsgard\_Josh\1 - Flyer\1235w3050s)



**CUSHMAN &  
WAKEFIELD**  
Commerce

FOR SALE OR LEASE

# Airgas Building & Yard

1235 West 3050 South / Ogden, Utah 84401



**Josh Wangsgard, MBA**  
Industrial/Investment Specialist  
+1 801 784 5322  
jwangsgard@comre.com

372 24<sup>th</sup> Street, Suite 320  
Ogden, Utah 84401  
Main +1 801 525 3000  
Fax +1 801 525 9596  
**comre.com**

*Independently Owned and Operated / A Member of the Cushman & Wakefield Alliance*

Cushman & Wakefield Copyright 2017. No warranty or representation, express or implied, is made to the accuracy or completeness of the information contained herein, and same is submitted subject to errors, omissions, change of price, rental or other conditions, withdrawal without notice, and to any special listing conditions imposed by the property owner(s). As applicable, we make no representation as to the condition of the property (or properties) in question. (path:G:\1 - Projects\Ogden\Wangsgard\_Josh\1 - Flyer\1235w3050s)