

# Crossroads Corporate Center

Premier Class "A" Office Campus

**FUTURE 39,018 SF OFFICE BUILDING**

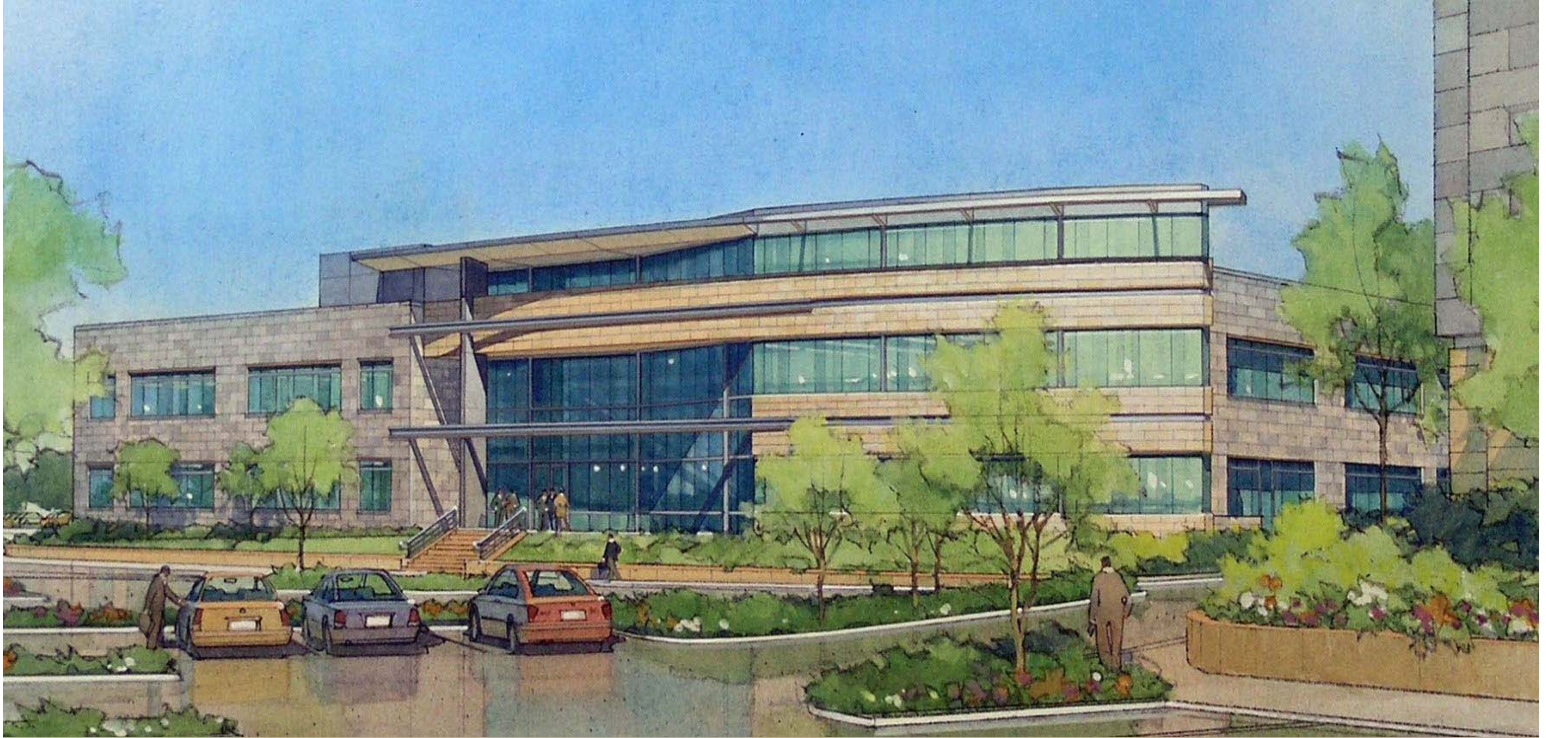

**25230 Hancock Avenue • Murrieta, CA**

## **PROPERTY FEATURES:**

- Prestigious ±273,121 SF master planned 4-building office campus
- "Golden Triangle" location with multiple access to the I-15 & I-215 Freeways
- Prominent building signage available
- Located minutes from county courthouse, hospital, banks and other services
- Visible from I-215 Freeway  
Excellent visibility from both the I-215 & I-15 Freeways
- Build-to-suit opportunities
- Abundant parking

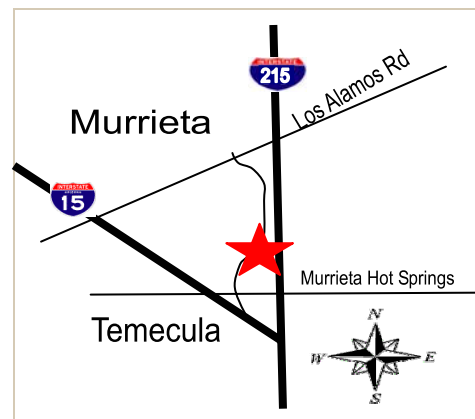

**Mary Piper**

**951.445.4516**

mpiper@lee-associates.com

**Rob Crisell**

**951.445.4513**

rcrisell@lee-associates.com

*Visit our website at*

[www.crossroadscorpcenter.com](http://www.crossroadscorpcenter.com)

# Crossroads Corporate Center

Premier ±273,121 SF  
Class "A" Office Campus

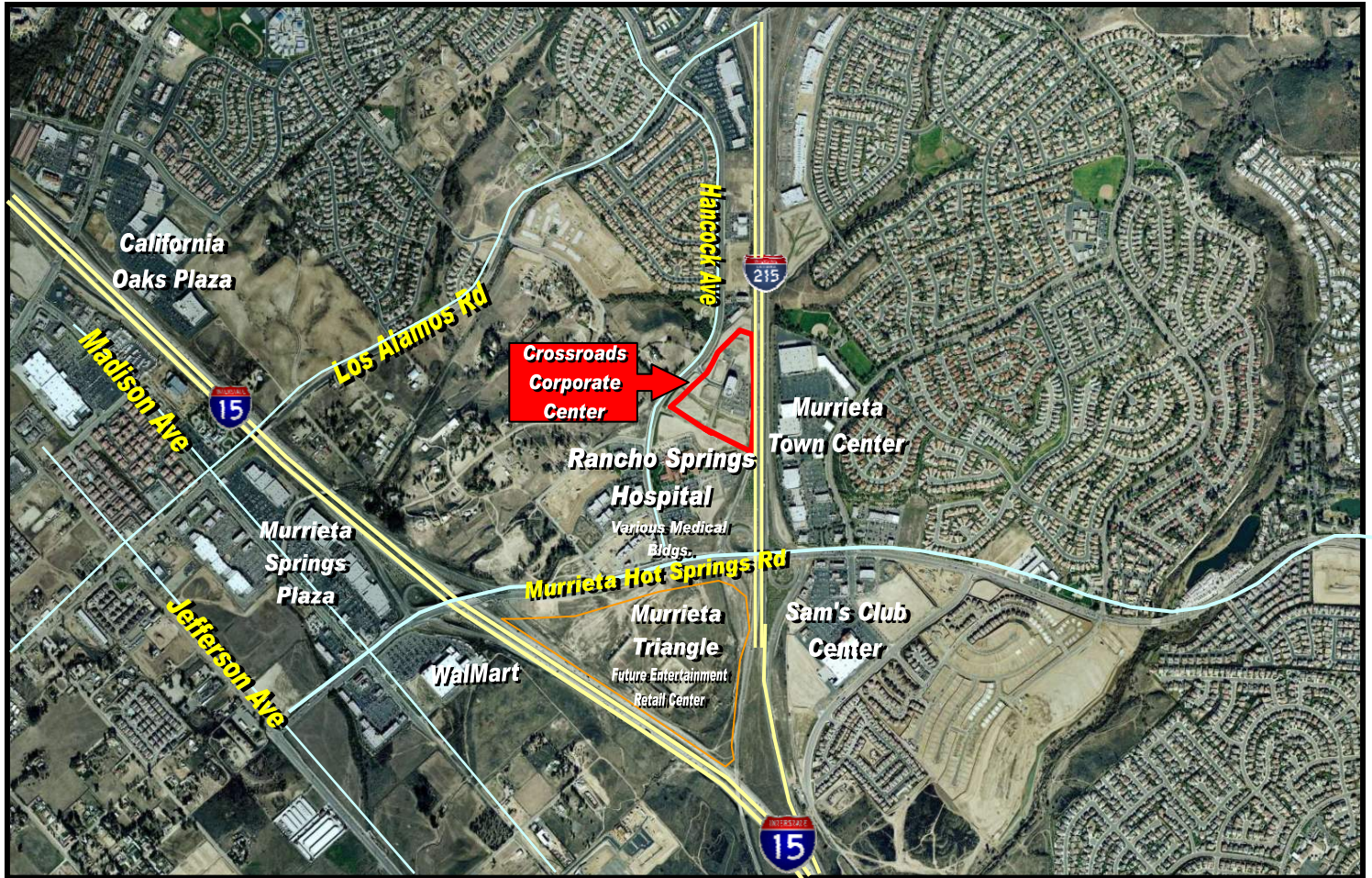

25220-25250 Hancock Avenue • Murrieta, CA



**Mary Piper**  
951.445.4516  
mpiper@lee-associates.com

**Rob Crisell**  
951.445.4513  
rcrisell@lee-associates.com

# Crossroads Corporate Center

Premier ±273,121 SF Class “A” Office Campus



**NOW  
LEASING**

25220 Hancock Ave.  
±76,500 S.F.  
Office Building

**100% Leased**

25240 Hancock Ave.  
±76,500 S.F.  
Office Building



25230 Hancock Ave.  
Future ±39,018 S.F.  
Office Building



25250 Hancock Ave.  
Future ±78,032 S.F.  
Office Building

**25220-25250 Hancock Avenue • Murrieta, CA**



**Water Feature & Outside Seating Area**



**Mary Piper**

**951.445.4516**

[mpiper@lee-associates.com](mailto:mpiper@lee-associates.com)

**Rob Crisell**

**951.445.4513**

[rcrisell@lee-associates.com](mailto:rcrisell@lee-associates.com)



**Lee &  
Associates**

25240 Hancock Avenue, #100 - Murrieta, CA 92562 | P: 951.445.4500 F: 951.445.4527 | [www.lee-associates.com](http://www.lee-associates.com)  
COMMERCIAL REAL ESTATE SERVICES no warranty or representation has been made to accuracy of the foregoing information. terms of sale or lease and availability are subject to change or withdrawal without notice.

# Crossroads Corporate Center

Premier ±273,121 SF Class "A" Office Campus



25220-25250 Hancock Avenue • Murrieta, CA

For Further Information, Please Contact:

**Mary Piper**  
**951.445.4516**  
mpiper@lee-associates.com

**Rob Crisell**  
**951.445.4513**  
rcrisell@lee-associates.com



**Lee &  
Associates**

25240 Hancock Avenue, #100 - Murrieta, CA 92562 | P: 951.445.4500 F: 951.445.4527 | www.lee-associates.com  
COMMERCIAL REAL ESTATE SERVICES no warranty or representation has been made to accuracy of the foregoing information. terms of sale or lease and availability are subject to change or withdrawal without notice.