

Talmadge Town Center

4038 Talmadge Rd, Toledo, OH 43623
Lucas County



HIGHLIGHTS

For Lease
County: Lucas
Type: Retail
Total SF: 28,693
Market: Toledo

CONTACT

Aaron J Wiens
419-843-6265
awiens@tolsonent.com

Talmadge Town Center is conveniently and perfectly located at the hard corner of one of Toledo's busiest intersections at Talmadge Road and Sylvania Ave, in fact the intersection carries a stunning 71,000 cpd combined. Located as an out parcel to the renowned Franklin Park Mall with over 10 million visitors annually, this site sits in the heart of the hottest retail corridor in all of Lucas County. A powerful and unparalleled combination of superior demographics, stellar signage and visibility, a plethora of the nation's hottest retailers and restaurants nearby accented by the regional draw of this shopping district makes Talmadge Town Center a destination that will remain best of the best for years and years to come. Tolson...Great Retail Space

DEMOGRAPHICS

	1-MILE	3-MILE	5-MILE
Population	10,168	88,958	224,602
Households	4,634	37,484	92,957
Average Household Income (\$)	71,860	66,133	61,727
Median Household Income (\$)	49,499	49,932	46,003

RETAILERS INCLUDE



Talmadge Town Center

4038 Talmadge Rd, Toledo, OH 43623

Lucas County

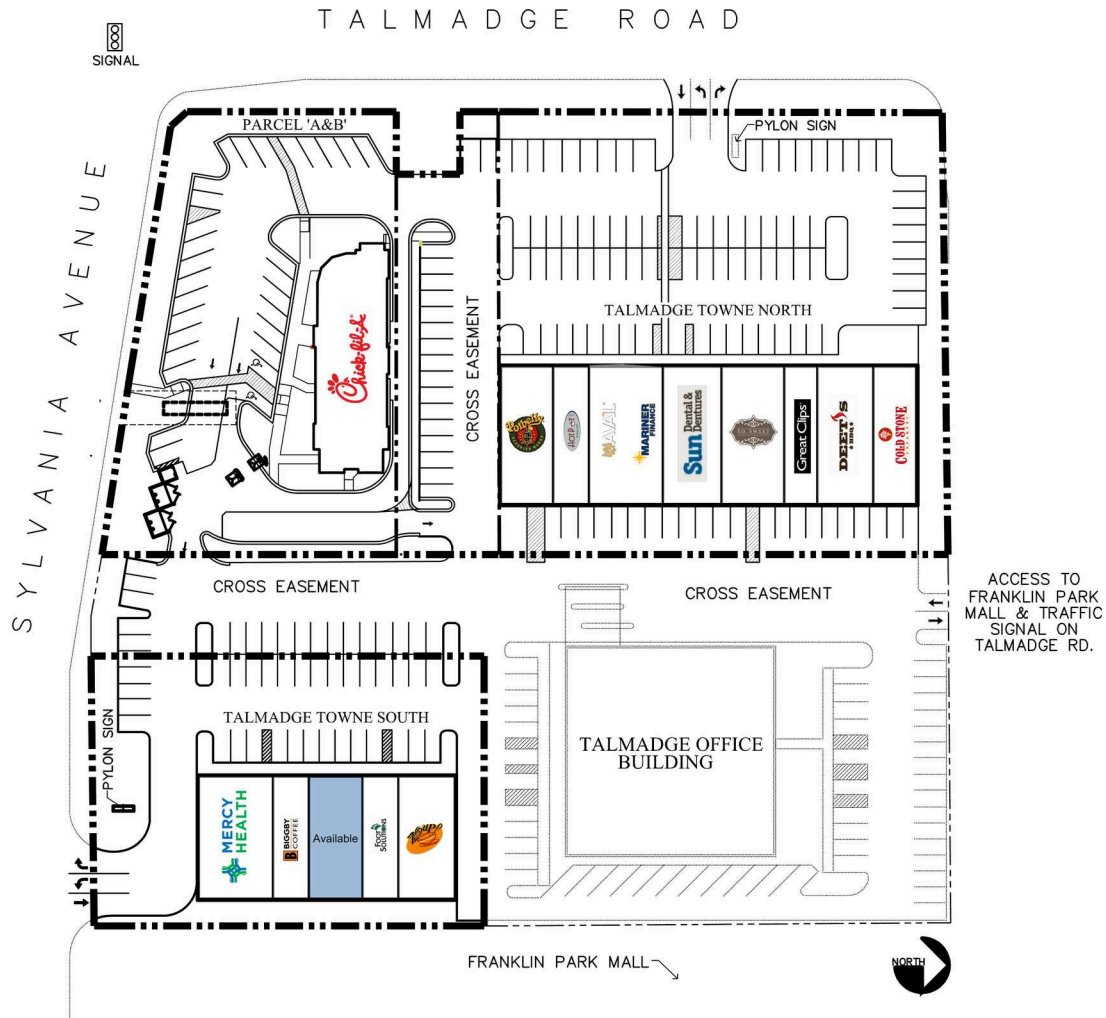

1/2	Mercy Health	2,825 SF	9B	Mariner Finance	1,520 SF
3	BIGGBY COFFEE	1,400 SF	10	Sun Dental	2,620 SF
4	Available	2,100 SF	11	So Sweet Bakery	2,800 SF
5	Foot Solutions	1,400 SF	12	Great Clips	1,456 SF
6	Zoup!	2,453 SF	13	Deet's BBQ	2,500 SF
7	Potbelly Sandwich Works	2,500 SF	14	Cold Stone Creamery	1,920 SF
8	Hot Pot and Asian Grill	1,600 SF	15	Chick-Fil-A	4,554 SF
9A	Avail Vapor	1,520 SF			