

**PRIME
WILLIAMSBURG
CORNER
AVAILABLE**

40 NORTH 4TH STREET



LOCATION:

Southeast corner of North 4th Street and Kent Ave

SIZE:

Space A:

Approximately 900 sf Ground
Approximately 900 sf Patio
Approximately 1,500 sf Lower Level

FRONTAGE:

Approximately 47 feet on North 4th Street
Approximately 20 feet on Kent Avenue

POSSESSION:

Immediate

COMMENTS:

- ADA compliant
- Dedicated elevator in place
- All spaces can be combined
- Across from high-density new residential developments, including 184 Kent, Northside Piers and the Edge
- Over 3,500 of new residential apartments and hotel rooms currently In development

NEIGHBORS:

Orange Theory, Soul Cycle, Music Hall of Williamsburg, Duane Reade, Brooklyn Denim Company, J.Crew, Madewell, Levis, G Star Raw, Sabon, Scotch & Soda, Urban Out fitters, Sandro, Brooklyn Rea/Smorgasburg, Blue Bottle Coffee, Mole, Pudge Knuckles, Radegast Hall & Biergarten and La Nonna, Bright Horizons, Kidville, Trader Joes (coming soon)

**Newmark Grubb
Knight Frank**

Retail

www.ngkf.com/retail



40 NORTH 4TH STREET

GROUND FLOOR

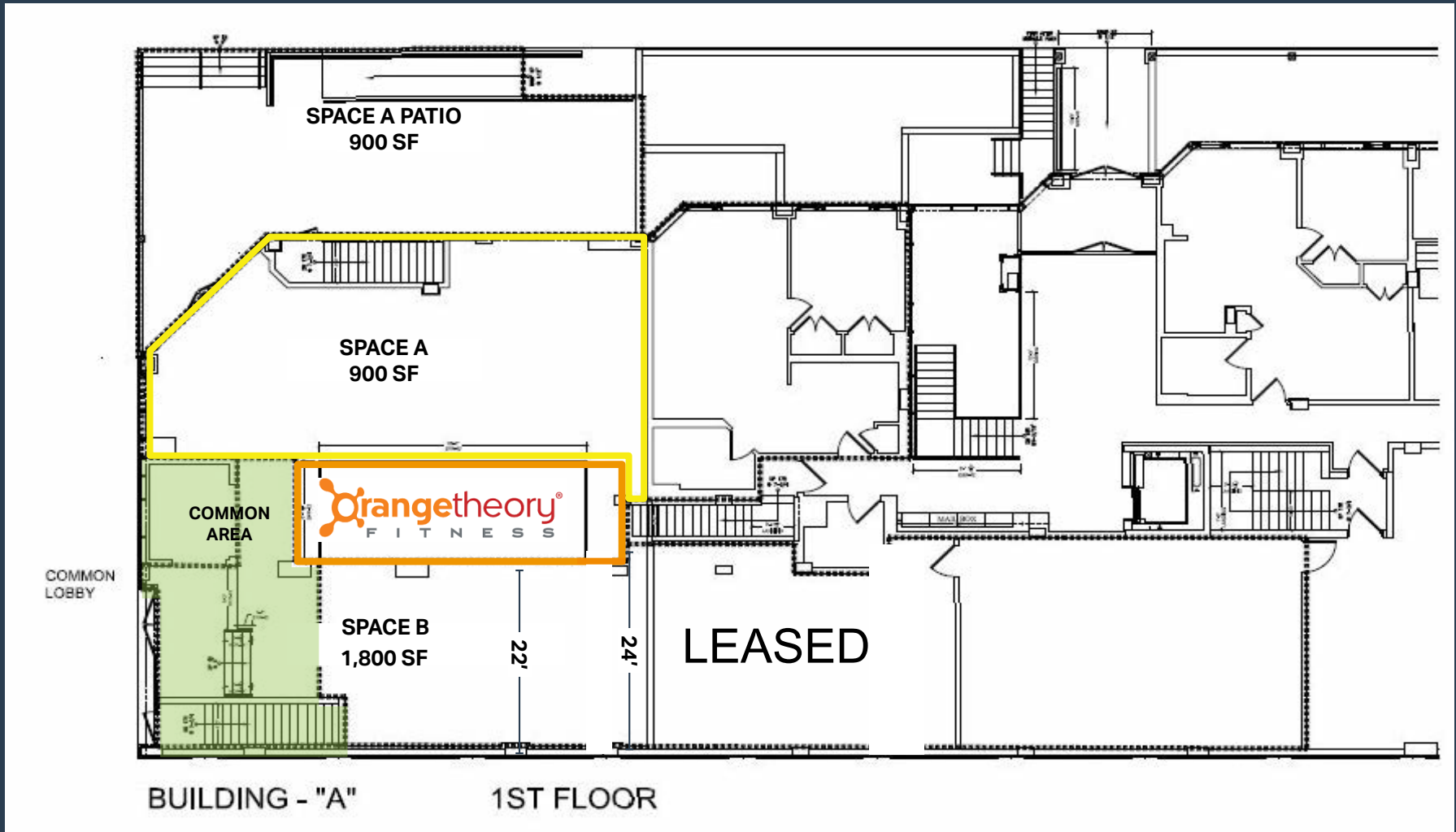

40 NORTH 4TH STREET

CELLAR

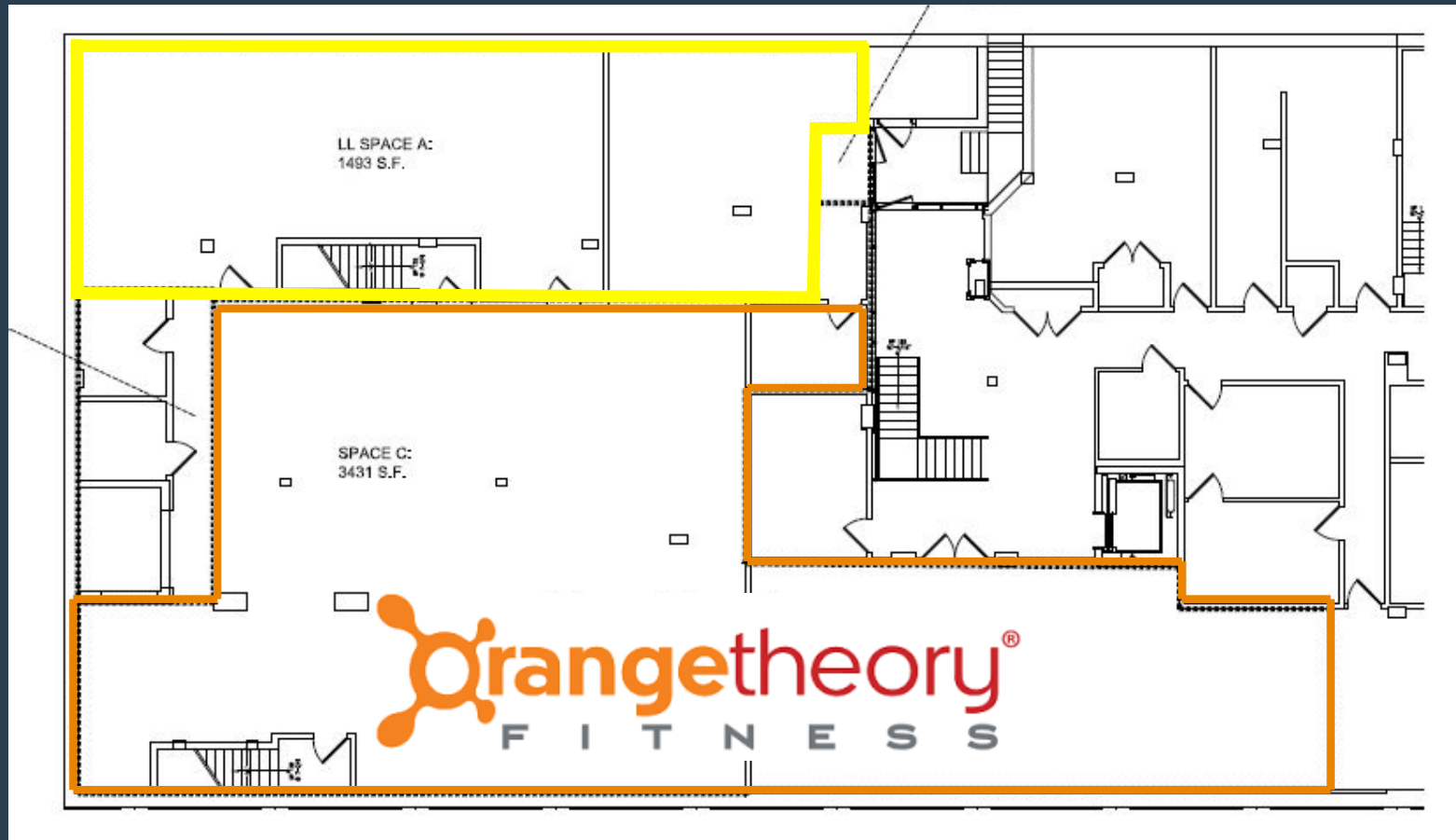

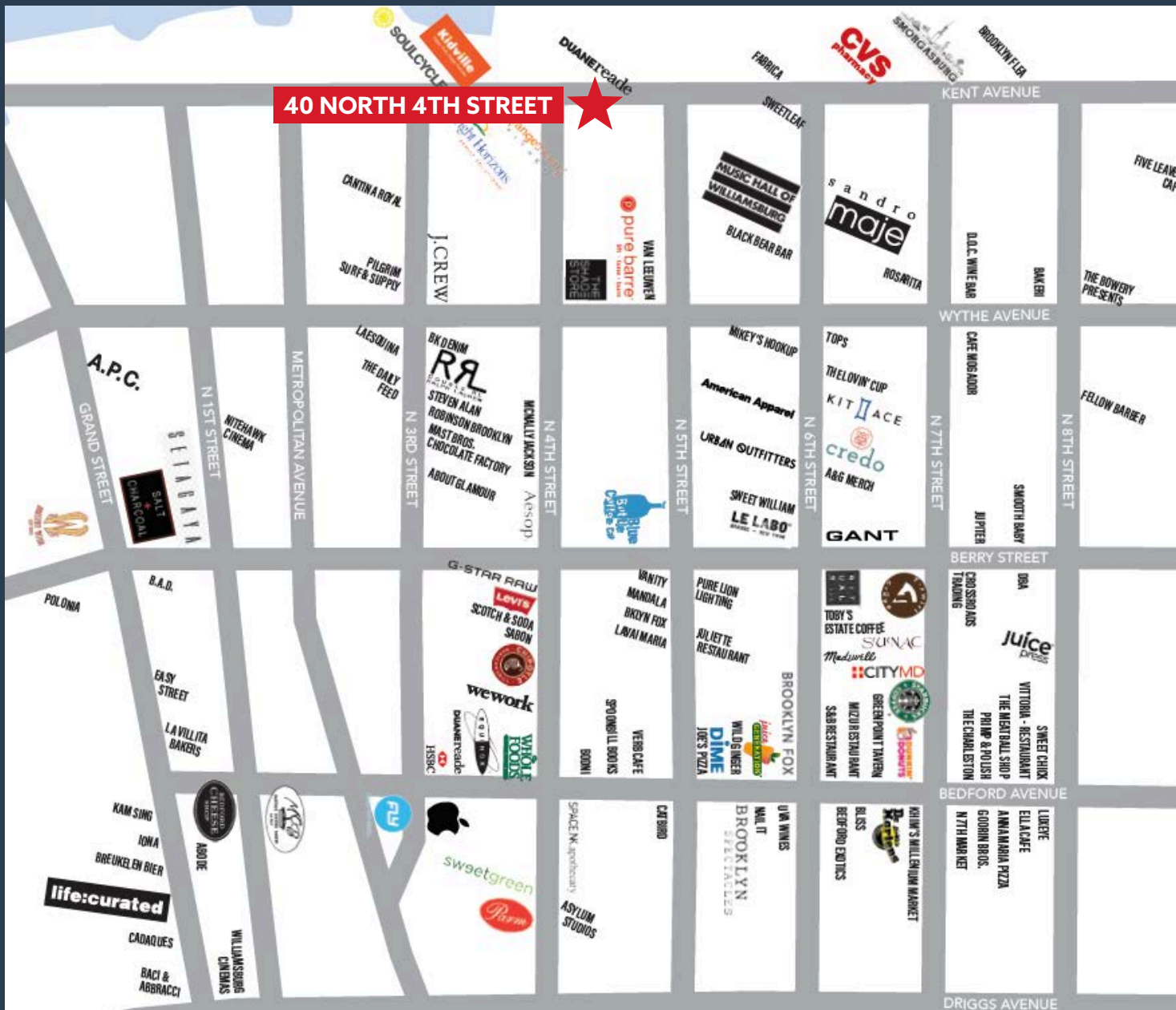

**Newmark Grubb
Knight Frank**
Retail
www.ngkf.com/retail



FOR FURTHER INFORMATION, PLEASE CONTACT OUR EXCLUSIVE AGENTS:

HYMIE M. DWECK
212.372.2060
hdweck@ngkf.com

JOSEPH COLISTA
212.372.2191
jcolista@ngkf.com