

GORDON

COMMERCIAL REAL ESTATE BROKERAGE

3101 TELEGRAPH AVENUE, SUITE 2, BERKELEY

Newly Renovated Therapy Office



SECOND FLOOR THERAPY SPACE FOR LEASE

SIZE: ± 158 rsf | **LEASE RATE:** \$1,200/month IG

CONTACT:

Lori Rosenthal • 510 524-2344 • lori@gordoncommercial.com • DRE# 01946676



PRIVATE THERAPY OFFICE AVAILABLE. Corner building across from Whole Foods Market, and 3 blocks to Alta Bates Summit Medical Center. Near Downtown and UC Berkeley.

PROPERTY FEATURES

- Corner suite with excellent natural light from windows on two sides
- Beautifully renovated space with soothing color palette, new carpet, and several skylights
- Shared amenities include:
 - Well-equipped kitchen with refrigerator, microwave, granite counter, Keurig coffeemaker
 - Waiting room and 2 ADA restrooms
 - Keypad entry door, ADA elevator, and enclosed stairway
- HVAC, new electrical with dimmer lights
- 3 on-site parking spaces – first-come, first-served basis, and convenient street parking
- Medically zoned
- Zoned C-1 (General Commercial)

WALK SCORE 92
BIKE SCORE 99
(walkscore.com)



LOCATION HIGHLIGHTS

- High-visibility corner building, with multiple AC Transit bus line stops nearby
- Walking distance from Ashby BART, and easy commute by bike or bus
- Ford GoBike Station across the street
- 3 blocks from Alta Bates Summit Medical Center
- High traffic counts: Telegraph Avenue connects Downtown Oakland to UC Berkeley, intersecting HWY-13 (Ashby Avenue), HWY-24, and I-580
- Co-tenants includes Blue Oak Therapy Center and Pacifica Family Maternity Center
- Centrally located within a local employment area containing ±28 office buildings as well as numerous retail establishments in the immediate vicinity of the property. The variety of private medical groups in the area benefit from referral systems and medical co-tenancy
- 5 blocks to the Elmwood Retail District with many popular cafés, restaurants, unique shops, movie theater, library, and more

FLOOR PLAN

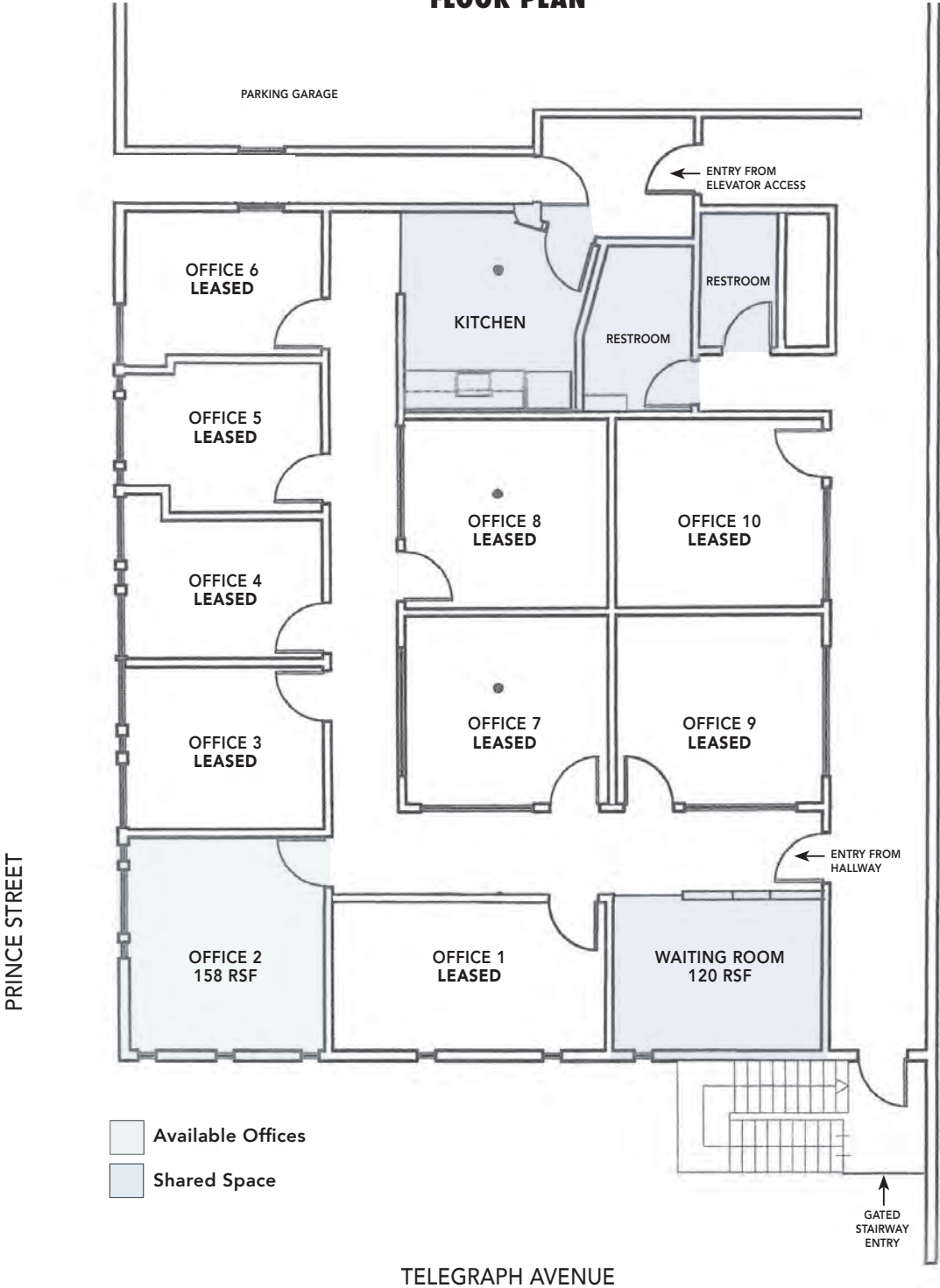

This drawing is intended to be used as an aid for planning. Though care was taken in drawing this floor plan, accuracy is not guaranteed.

PHOTOS



PHOTOS





NEARBY AMENITIES:

- Whole Foods Market
- Ashby Flowers
- Walgreens
- Sports Basement
- CVS
- Wells Fargo
- Focal Point Opticians
- Berkeley Bowl Marketplace
- The Smokehouse Burgers
- Donato & Co. Restaurant
- CP Shades
- Espresso Roma



3101 TELEGRAPH AVENUE is centrally located within a local employment area containing ± 28 office buildings as well as numerous retail establishments in the immediate vicinity of the property. The variety of private medical groups in the area benefit from referral systems and medical co-tenancy.

MEDICAL OFFICES IN THE VICINITY INCLUDE: Direct Urgent Care, Berkeley Orthodontics, Aloha Pediatric Dentistry, Berkeley Endodontics, PET/CT Imaging of Berkeley, East Bay Pediatrics, Berkeley Patients Care Collective, Total Health Dental Care, Refresh Dental and Bayside Medical Group.

NEIGHBORHOOD PHOTOS



The information contained herein has been provided by the owner of the property or other sources we deem reliable. We have no reason to doubt its accuracy, but we cannot guarantee it. All information should be verified prior to leasing.