

NORTH OAK MARKETPLACE

4820-4914 N OAK TRAFFICWAY, KANSAS CITY, MO 64118



KAYLA GILCHRIST

(913) 945-3745

kaylag@reececommercial.com

ALLISON MORAN

(913) 945-3758

allison.moran@reececommercial.com

REECE COMMERCIAL REAL ESTATE

8005 W 110th St, Ste 150

Overland Park, KS 66210

NORTH OAK MARKETPLACE

- 1,385, 1,550, 2,655 SF Spaces Available
- Anchored by Price Chopper, Big Lots and Goodwill
- Power Center Located at NE Vivion Rd & N Oak Trafficway
- Traffic Counts: NE Vivion - 15,446, N Oak Trafficway - 27,669, Hwy 71 - 89,613
- Direct Access off I-29, Hwy 69, & Hwy 283
- Please Contact for Pricing

PROPERTY INFORMATION



The information in this package has been obtained from sources believed reliable. While we do not doubt its accuracy we have not verified it and make no guarantee, warranty or representation about it. It is your responsibility to independently confirm its accuracy and completeness. Any projections, opinions, assumptions, or estimates used are for example only and do not represent the current or future performance of the property. You and your advisors should conduct a careful, independent investigation of the property to determine to your satisfaction the suitability of the property for your needs. © 2019

FLOOR PLANS

PROPERTY INFORMATION

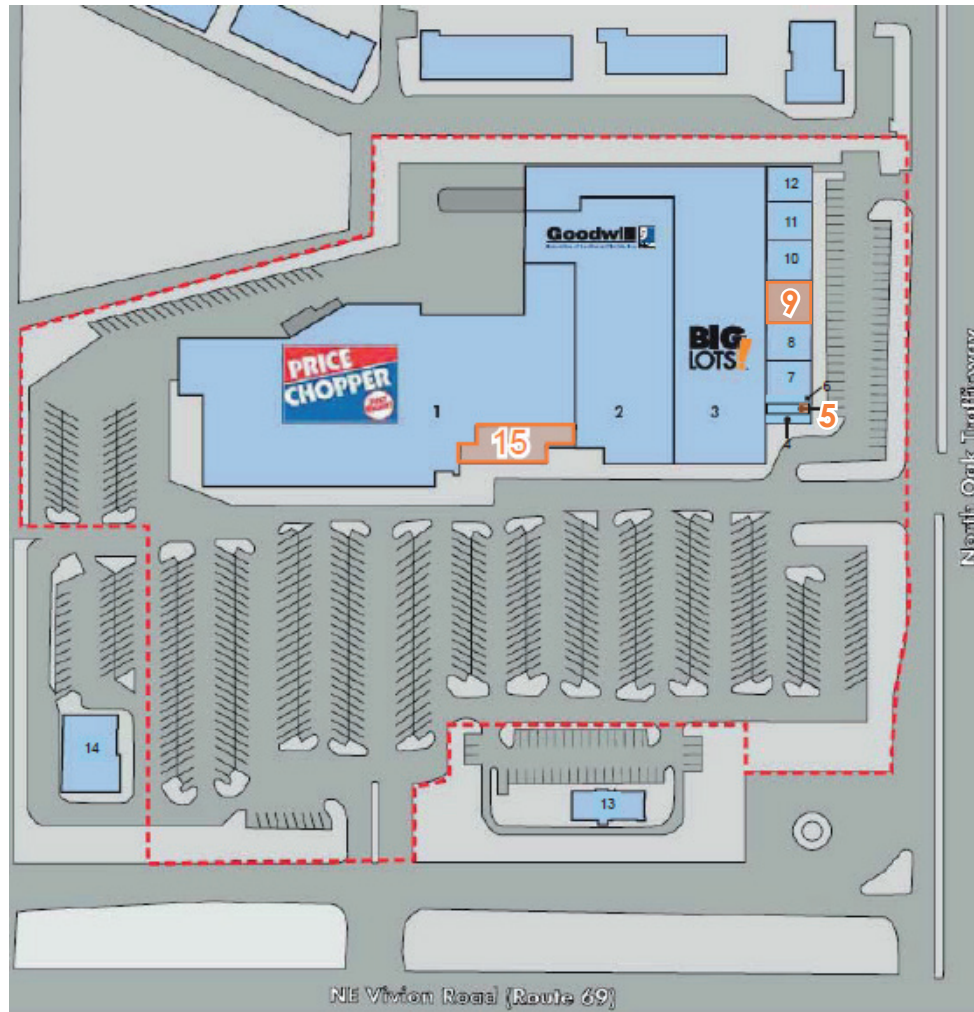

Unit	Tenant	Available SF
1	Price Chopper	
2	Goodwill	
3	Big Lots	
4	Phone Medic	
5	Available	1,385
6	Sprint	
7	Jackson Hewitt	
8	Fantastic Sam's	
9	Available	1,550
10	Loan N Go	
11	Glamour Nail	
12	Sport Clips	
13	Taco Bueno	
14	US Bank	
15	Available	2,655*

*New, White-Box Condition

The information in this package has been obtained from sources believed reliable. While we do not doubt its accuracy we have not verified it and make no guarantee, warranty or representation about it. It is your responsibility to independently confirm its accuracy and completeness. Any projections, opinions, assumptions, or estimates used are for example only and do not represent the current or future performance of the property. You and your advisors should conduct a careful, independent investigation of the property to determine to your satisfaction the suitability of the property for your needs. © 2019

