

## Retail/Industrial/Office Land For Sale 2210 West 3000 South Heber City, Utah

### Property Highlights

- Lot #1: 1.74 acres Sales price: \$685,000
- Lot #3: 3.38 acres Sales price: \$1,325,000
- Great highway exposure
- Perfect location for east access to Provo and Salt Lake City



**Ralph Riedel, ccim**  
Executive Director - Investment  
+1 801 303 5466  
ralph.riedel@cushwake.com

170 South Main Street Suite 1600  
Salt Lake City, UT 84101  
Main +1 801 322 2000  
Fax +1 801 322 2040  
[cushmanwakefield.com](http://cushmanwakefield.com)



**CUSHMAN &  
WAKEFIELD**

FOR SALE

# Weathervane Land For Sale

2210 West 3000 South / Heber City, Utah

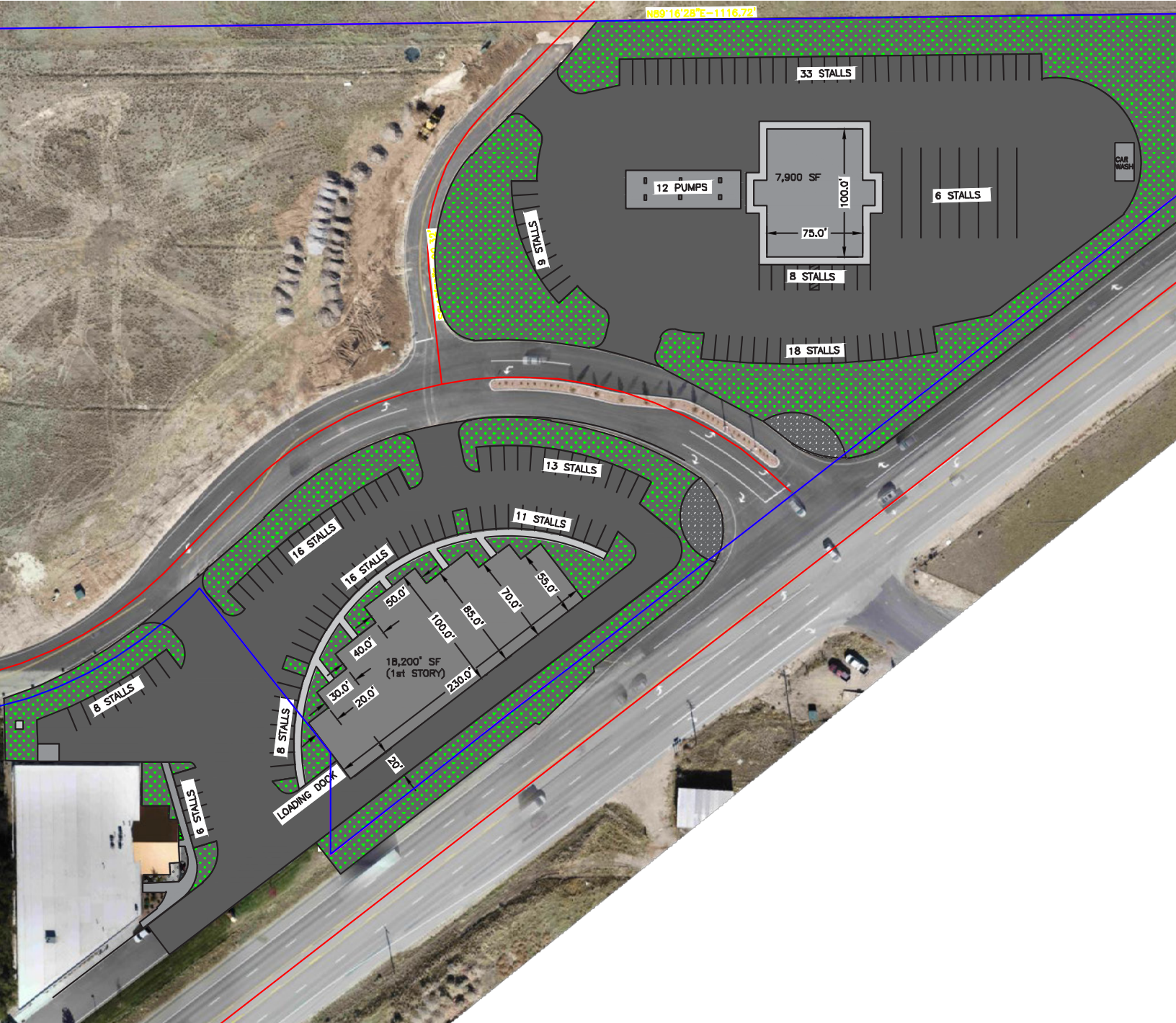

**Ralph Riedel, ccim**  
 Executive Director - Investment  
 +1 801 303 5466  
 ralph.riedel@cushwake.com

170 South Main Street Suite 1600  
 Salt Lake City, UT 84101  
 Main +1 801 322 2000  
 Fax +1 801 322 2040  
**cushmanwakefield.com**

Cushman & Wakefield Copyright 2018. No warranty or representation, express or implied, is made to the accuracy or completeness of the information contained herein, and same is submitted subject to errors, omissions, change of price, rental or other conditions, withdrawal without notice, and to any special listing conditions imposed by the property owner(s). As applicable, we make no representation as to the condition of the property (or properties) in question. (path: M:\1 - Projects\Riedel\_Ralph\1 - Flyers\Weathervane\_Heber\WeathervaneLandForSale\_Heber\_Flyer.indd)