

FOR LEASE
OFFICE BUILDING



PALACE BUILDING
7437 RIVER STREET SE, ADA, MI 49301

PROPERTY HIGHLIGHTS

- Proposed 3rd floor office space with 5,743 RSF available in the first quarter of 2021
- Great views overlooking the Thornapple River and Riverfront Park
- First class Zeytin Restaurant anchors the first floor
- Join several new corporate offices relocating to Ada Village to enjoy all the amenities this village has offer
- 2021 CAM estimated at \$6.50/sf/yr

OFFERING SUMMARY

Lease Rate: \$19.50 SF/yr (NNN)
 Year Built: 2018
 Building Size: 5,814 SF
 Zoning: Commercial

DEMOGRAPHICS

	1 MILE	3 MILES	5 MILES
Total Households	859	5,673	12,801
Total Population	2,659	16,473	36,747
Average HH Income	\$126,000	\$130,695	\$128,291

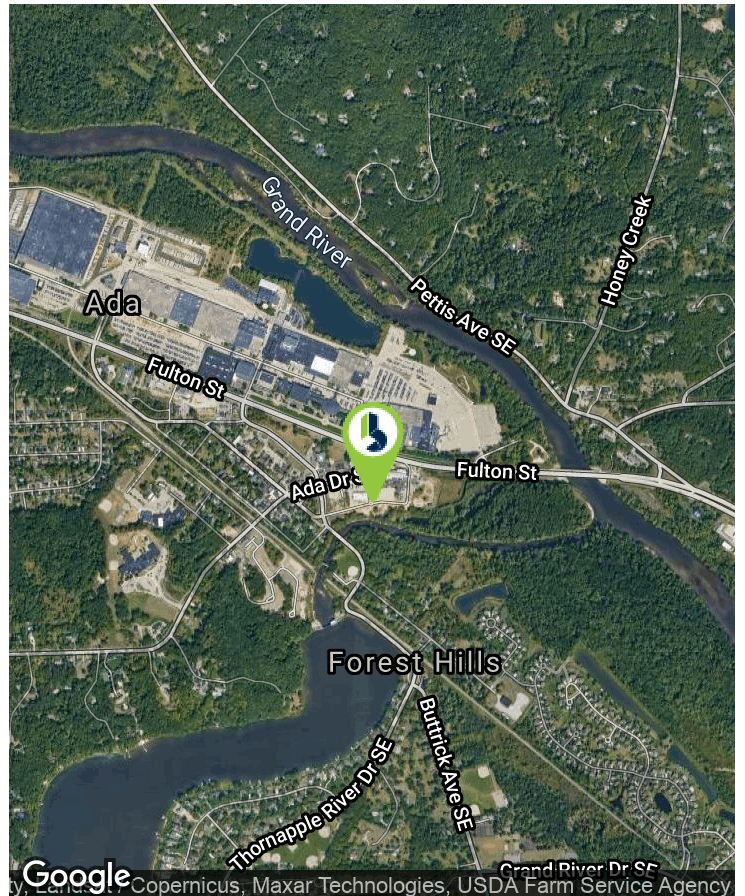

AVAILABLE SPACES

7437 RIVER ST. SE | 7437 RIVER ST. SE, ADA, MI 49301 | FOR LEASE

LEASE TYPE | NNN **TOTAL SPACE** | 5,743 SF **LEASE TERM** | Negotiable **LEASE RATE** | \$19.50 SF/yr



AVAILABLE

SUITE	SIZE	TYPE	RATE
E	5,743 SF	NNN	\$19.50 SF/yr

SITE PLAN

7437 RIVER ST. SE | 7437 RIVER ST. SE, ADA, MI 49301 | FOR LEASE

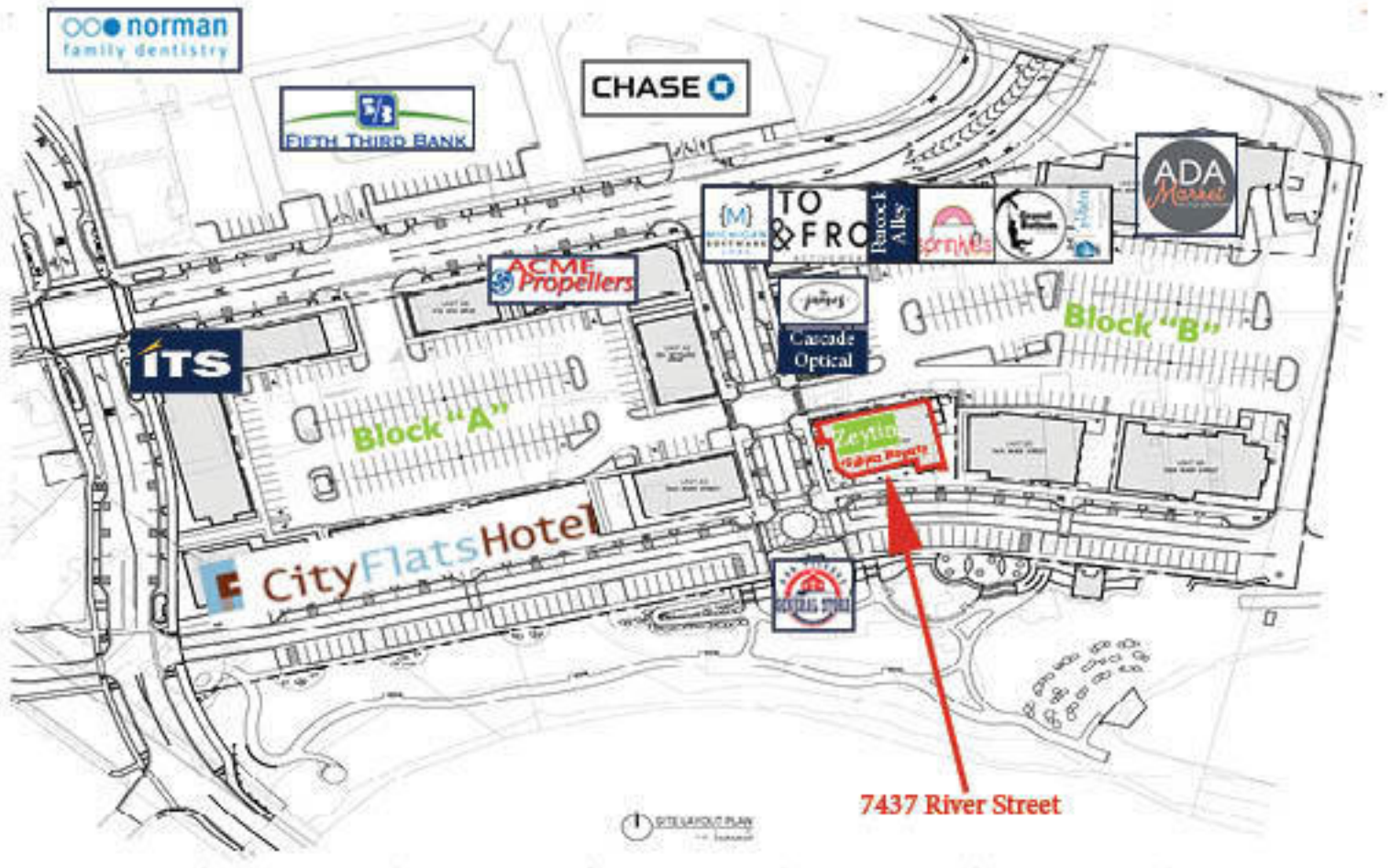

PROPOSED FOR FALL 2020: THIRD FLOOR

7437 RIVER ST. SE | 7437 RIVER ST. SE, ADA, MI 49301 | FOR LEASE



JEFF TUCKER
Senior Managing Director, Brokerage | Principal
616.881.9321
jtucker@bradleyco.com

©2020 Bradley Company, LLC and affiliates. Use of any third party name or mark is for informational purposes only and does not indicate sponsorship or endorsement by such party. Not all information has been independently verified, and the presenting broker makes no guarantee about its accuracy. Any projections, opinions, or estimates are for example only. Before completing a real estate transaction, you and your advisors should conduct an independent investigation of the property to determine its suitability for your needs.