

1393 Wheaton

Troy, MI



- ◆ Suite 500 - 2,410sf
- ◆ Constructed in 1988
- ◆ Available office/incubator warehouse/flex space
- ◆ Conveniently located off of I-75 at Rochester Road (Exit 67)
- ◆ Close to lodging, dining and shopping facilities
- ◆ Great I-75 signage exposure
- ◆ 18' clearance
- ◆ 1 grade door in each unit
- ◆ Owned and managed by JFK Investment Co.

Geoff Hill 248.350.1492 gill@ngkf.com
Paul Gyarmati 248.357.6566 pgyarmati@ngkf.com



**Newmark Grubb
Knight Frank**

27725 Stansbury Blvd, Suite 300, Farmington Hills, MI 48334

Procuring broker shall only be entitled to a commission calculated in accordance with the rates approved by our principal only if such procuring broker executes a brokerage agreement acceptable to us and our principal and the conditions as set forth in the brokerage agreement are fully and unconditionally satisfied. Although all information furnished regarding property for sale, rental, or financing is from sources deemed reliable, such information has not been verified and no express representation is made nor is any to be implied as to the accuracy thereof and it is submitted subject to errors, omissions, change of price, rental or other conditions, prior sale, lease or financing, or withdrawal without notice and to any special conditions imposed by our principal.

I-75 Tech Park
1393 Wheaton Dr
Troy, MI 48083-1916



1393 Wheaton Dr

Availability Information

Total Vacant	2,410 sf	For Lease/For Sale	For Lease
Total Available	2,410 sf	Direct Lease Rate	\$10.00 MGRS
Min/Max Available	2,410 sf		
TI Allowance / sf		Asking Sale Price	
Direct Avail	Bldg 1393 Ste 500	2,410 rsf	Divisible: 2,410 rsf \$10.00 - \$10.00 MGRS

Expense Information

Expense Total		Insurance	
Electric		CAM	
Taxes			

Property Information

Property Size	19,761 sf	Property Type / Subtype	Industrial/R&D/Flex
Alternate Size		Owner/Tenant Status	Multi-tenant
Lot/Land Size		Construction Status	Completed
Parking Ratio		Construction Type	
Number of Bldgs/Floors	1/1	Zoning	Lt. Ind
Construction Date	1/1/1989	Map Location	
Last Update	3/31/17	Parcel Number	20-26-176-013
Property ID	419247	Logistics Class:	

Property Specifications

Clear Height Max	18.00	Office Space	
Clear Height Min	18.00	Parking Description	
# of Private Offices		Heating Type	Gas
Grade Doors	2	Cranes	No
Dock Doors	0	Rail	No
Parking Spaces	255	Sprinkler	Yes
Power Amps	200	NGKF Exclusive	Yes
Power Volts	480		
Power Phase	3		

Location Description

I-75 & Rochester Rd.

Comments

Clean, well kept 5 building office/warehouse complex located at the end of Wheaton Ave. Some units offer I-75 signage. 1 grade door in each unit.

Contact Information

Relationship	Company Name	Contact Name	License #	Direct/Company Phone
Lease Agent	Newmark Grubb Knight Frank MI Detroit	Geoff Hill		248.350.1492 / 248.350.9500
Lease Agent	Newmark Grubb Knight Frank MI Detroit	Paul Gyarmati		248.357.6566 / 248.350.9500

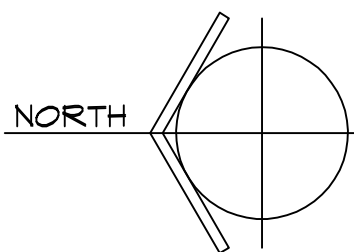
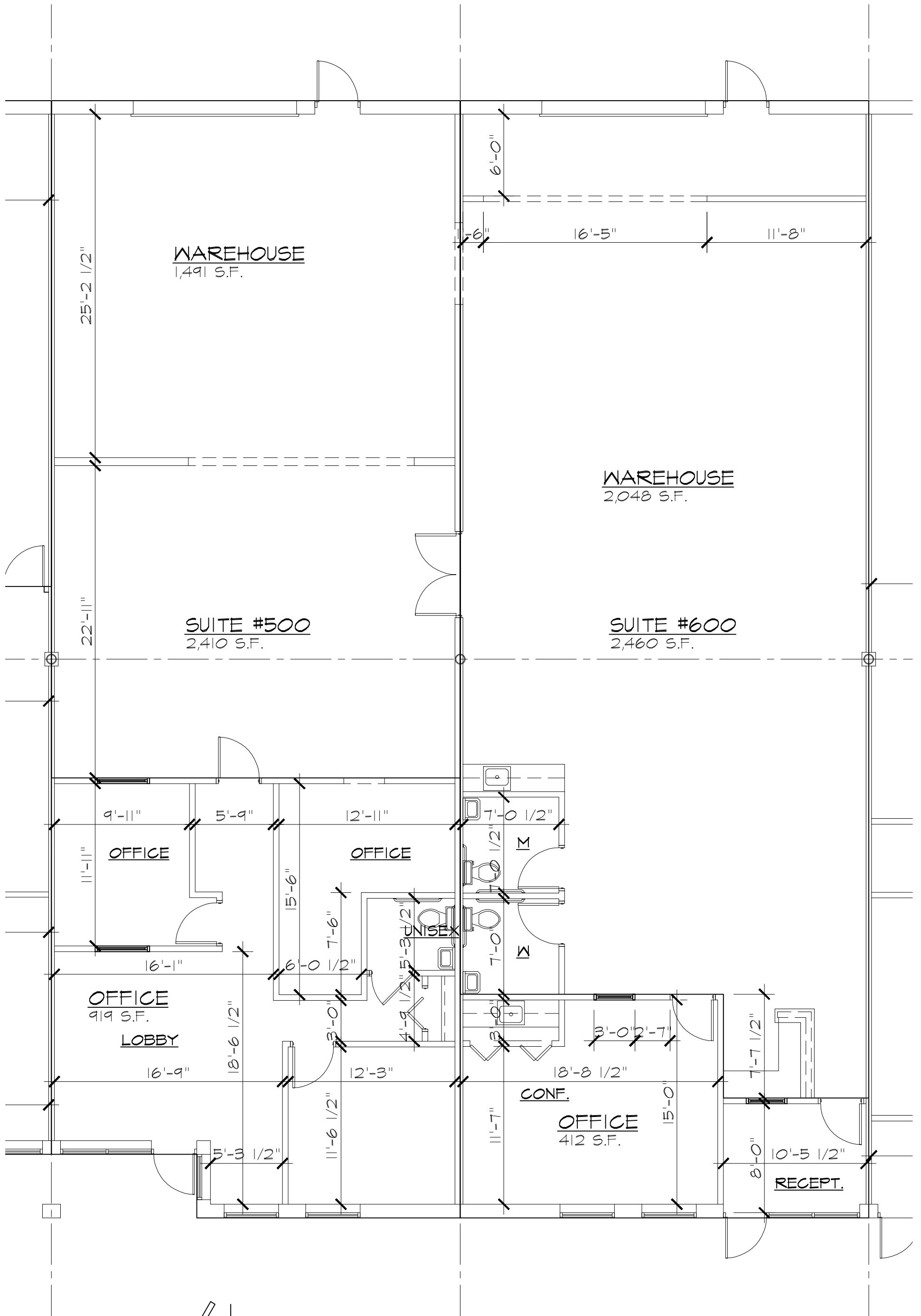

1393 WHEATON AVE. 500/600

1/8" = 1'-0"