

FOR SALE 3.71 AC COMMERCIAL

1860 Belmont Loop Woodland, WA 98674



*Offered at
\$900,000*

Kelly D. Shea

2016 Top Producer

Kelly@CBCIndustrialProperties.com

360.823.5110 Direct / 360.921.3710 Cell

See Kelly's Listings >



JENKINS & ASSOCIATES



300 W 15th St., Ste 201
Vancouver, WA 98660

Coldwell Banker Commercial and the Coldwell Banker Commercial Logo are registered service marks licensed to Coldwell Banker Real Estate LLC. Each Office is Independently Owned and Operated. We deem the information provided reliable, but it is not guaranteed. All potential investors and tenants must take appropriate measures to verify all of the information set forth herein before entering into a Purchase or Lease.

Cowlitz County Parcel Information



- **3.71 AC**
- **2 Tax Parcels**
- **On I-5 at Exit 22 Woodland**
- **Within Woodland City Limits**
- **Zoned Commercial C-2**
- **All Public Utilities Available at Street**
- **Easy Access & Visibility**



Possible Parcel Use

358- 10'x20' Storage Units

600 SF Managers Office

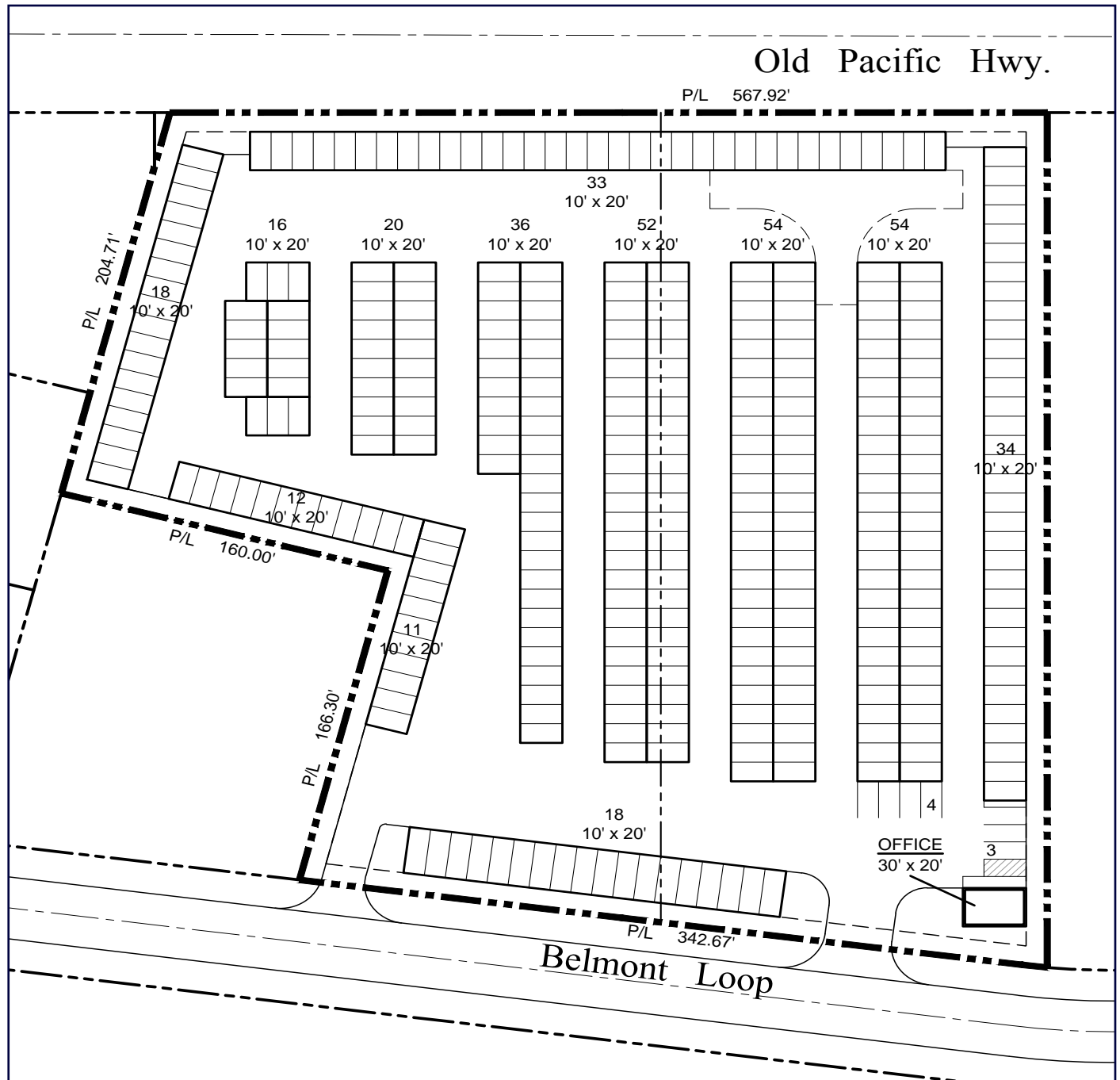

Regional Hwys Map

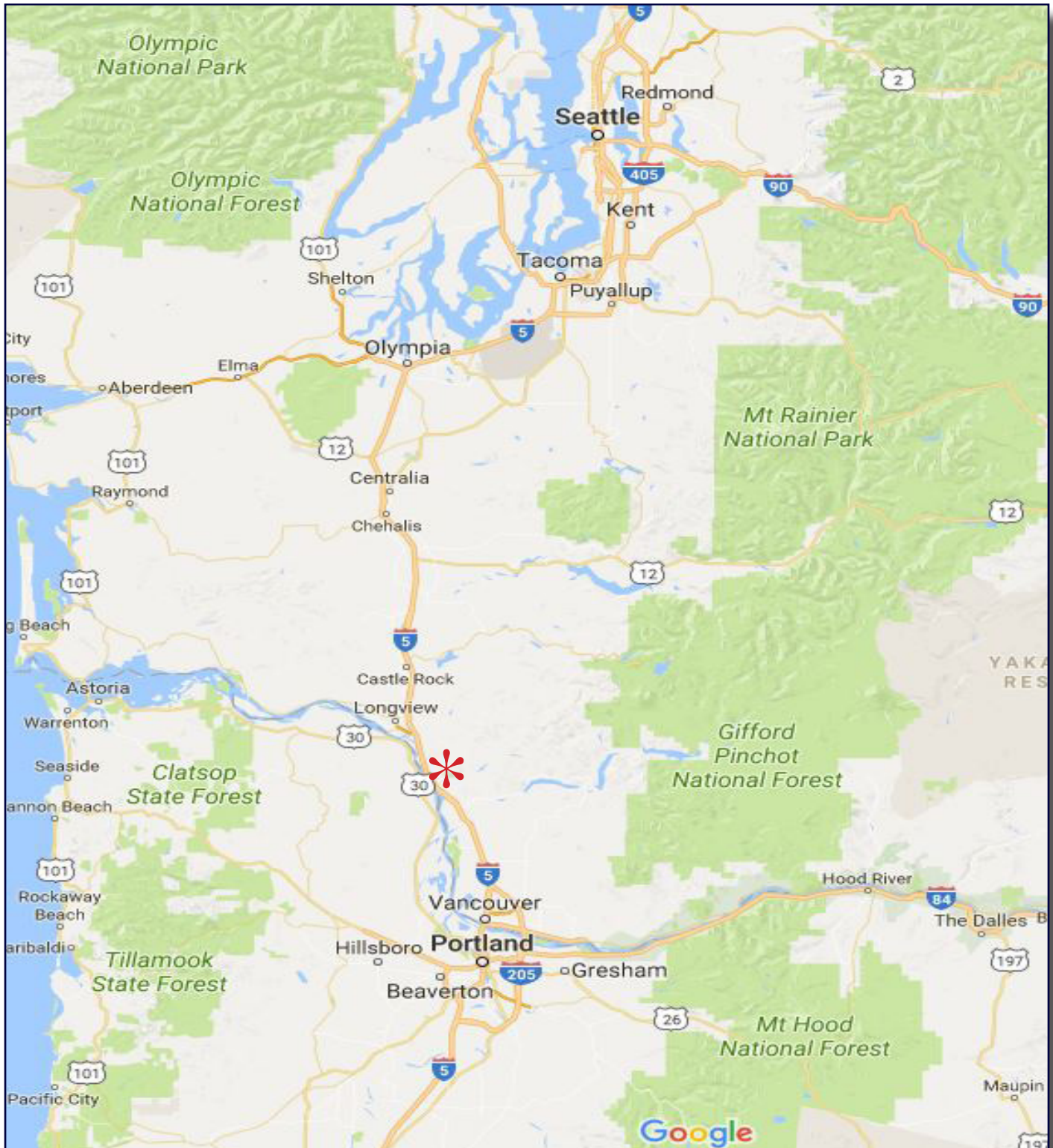

Vancouver 21 Miles ~ Olympia 85 Miles ~ Seattle 145 Miles
30 Minutes to Portland Int Airport