

- 4 blocks to the 7 train
- Minutes to the Midtown tunnel and 59th St Bridge
- Close Proximity Hunterspoint Avenue LIRR

AVAILABILITIES

| FLOORS | SIZE | FLOORS | SIZE |
|-----------|------------|--------------|-----------|
| P. GROUND | 10,419 RSF | P. GROUND | 2,388 RSF |
| P. GROUND | 7,953 RSF | P. GROUND | 696 RSF |
| P. GROUND | 2,415 RSF | P. 2ND FLOOR | 6,444 RSF |

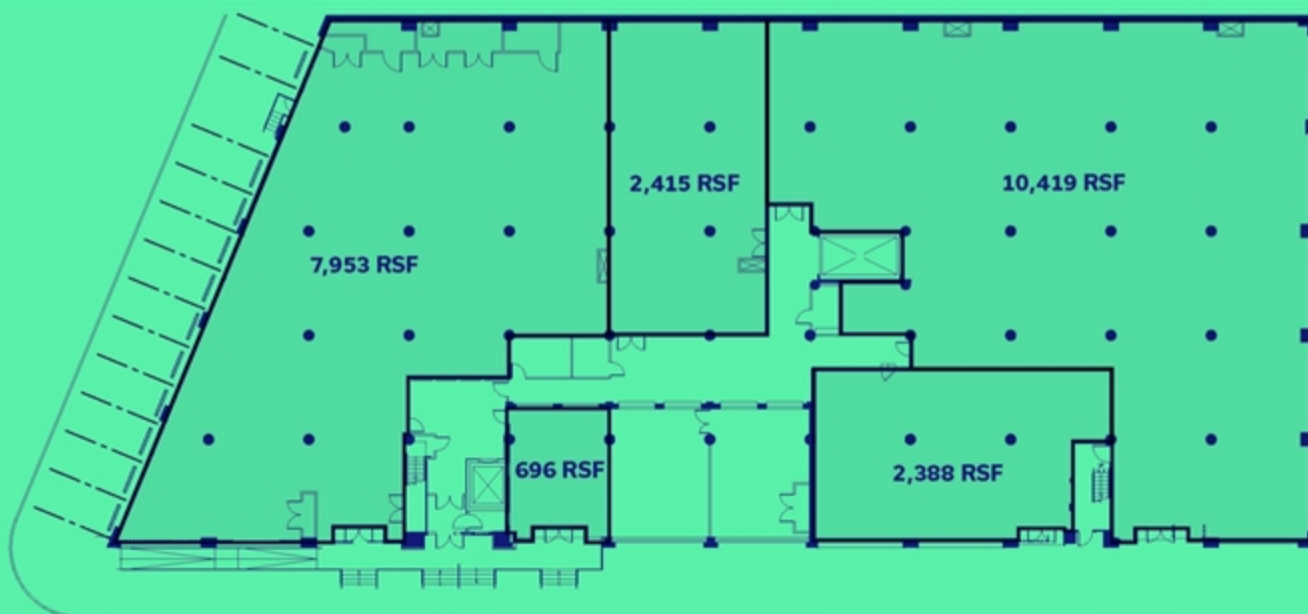

GROUND FLOOR

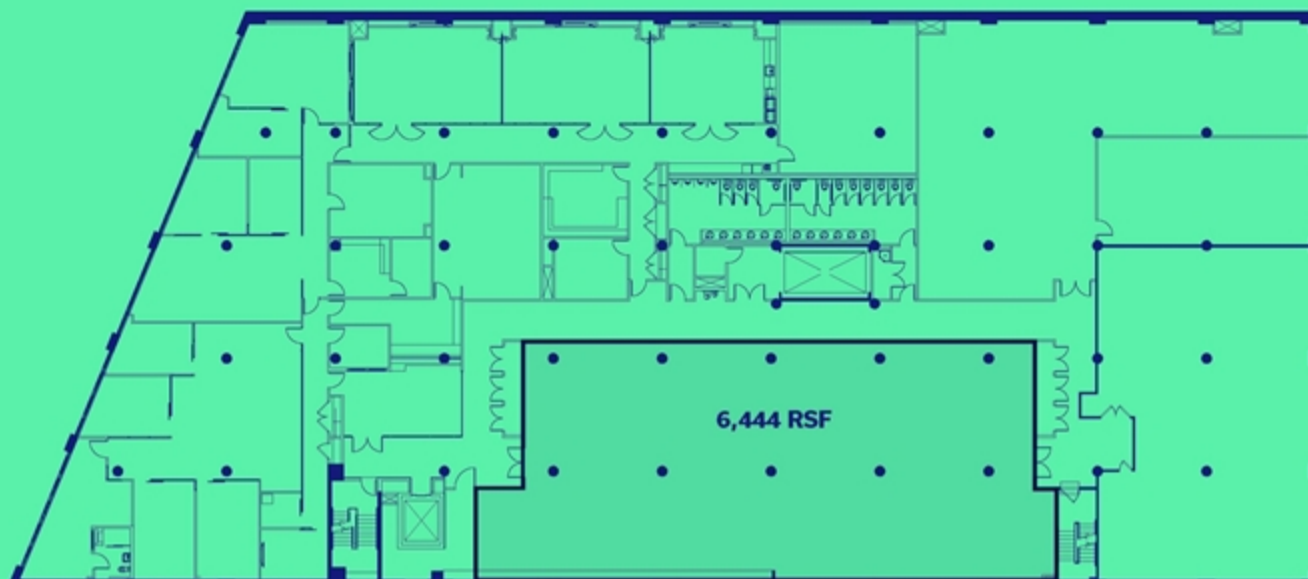

2ND FLOOR

HIGHLIGHTS

- New construction
- Spaces in white boxed condition
- Immediate Possession
- 12' Ceiling Heights
- Signage and branding opportunity
- Ground Floor Spaces Has Own Entry
- Loading Docks available
- Recently upgraded building infrastructure
- Large windows with great light



For more information:

New York Headquarters
125 Park Ave.
New York, NY 10017
t 212-372-2000

nrmk.com

BRIAN S. WATERMAN
Executive Vice Chairman
212-372-2299
brian.waterman@nrmk.com

DAVID BERKE
Senior Managing Director
t 212-372-2478
david.berke@nrmk.com

HOWARD J KESSELER JR.
Executive Managing Director
t 212-372-2110
howard.kessler@nrmk.com

ALEXANDER KESSELER
Associate
t 212-372-0706
alexander.kessler@nrmk.com