

# CLOVER BUILDING

A 3-story, 60,171 SF office building ideally located within Bellevue's 520 tech corridor



## Leasing Information

**Gary Guenther, SIOR** | 425.450.1154 | garyg@kiddermathews.com  
**Jeff Chaney** | 425.450.1127 | jchaney@kiddermathews.com  
**Celeste Rietveld** | 425.450.1145 | crietveld@kiddermathews.com

Property owned by:



Exclusively represented by:



# CLOVER BUILDING

Excellent visibility with the only signage opportunity on the 520 tech corridor

## Property Highlights

14450 NE 29th Place, Bellevue

Located in the core of 520 tech corridor, close to Microsoft campus and immediately adjacent to 520 bike trail

Tenant lounge with Canteen Market

New workout facility

Abundant covered and surface parking (3.5/1,000 SF)

Fiber optics and Storage available

## Lease Rates

SUITE	RSF	RATE	AVAILABLE
117	2,140	\$33.00/SF, FS	Available
220	7,352 (Divisible)	\$33.00/SF, FS	Available

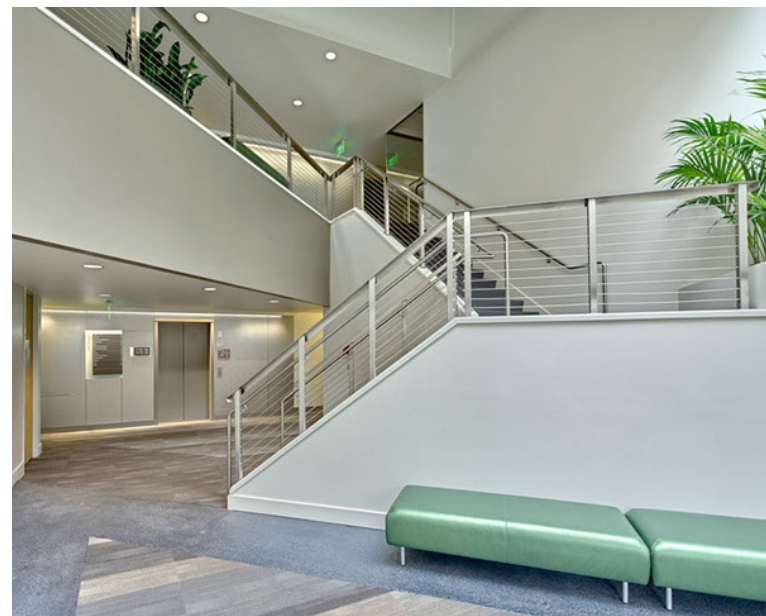

## Leasing Information

**Gary Guenther, SIOR**  
425.450.1154  
garyg@kiddermathews.com

**Jeff Chaney**  
425.450.1127  
jchaney@kiddermathews.com

**Celeste Rietveld**  
425.450.1145  
crietveld@kiddermathews.com

[kiddermathews.com](http://kiddermathews.com)

This information supplied herein is from sources we deem reliable. It is provided without any representation, warranty or guarantee, expressed or implied as to its accuracy. Prospective Buyer or Tenant should conduct an independent investigation and verification of all matters deemed to be material, including, but not limited to, statements of income and expenses. Consult your attorney, accountant, or other professional advisor.

Property owned by:



Exclusively represented by:





# CLOVER BUILDING

## Ideally Located



### Leasing Information

**Gary Guenther, SIOR**  
425.450.1154  
garyg@kiddermathews.com

**Jeff Chaney**  
425.450.1127  
jchaney@kiddermathews.com

**Celeste Rietveld**  
425.450.1145  
crietveld@kiddermathews.com

[kiddermathews.com](http://kiddermathews.com)

This information supplied herein is from sources we deem reliable. It is provided without any representation, warranty or guarantee, expressed or implied as to its accuracy. Prospective Buyer or Tenant should conduct an independent investigation and verification of all matters deemed to be material, including, but not limited to, statements of income and expenses. Consult your attorney, accountant, or other professional advisor.



Property owned by:



Exclusively represented by:

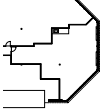

# CLOVER BUILDING

	SUITE	RSF	FLOOR PLAN	AVAILABLE
	117	2,140	<a href="#">*Click here to see the floor plan</a>	Available
	220	7,352 (divisible)	<a href="#">*Click here to see the floor plan</a>	Available

## Leasing Information

**Gary Guenther, SIOR**  
425.450.1154  
garyg@kiddermathews.com

**Jeff Chaney**  
425.450.1127  
jchaney@kiddermathews.com

**Celeste Rietveld**  
425.450.1145  
crietveld@kiddermathews.com

**kiddermathews.com**

This information supplied herein is from sources we deem reliable. It is provided without any representation, warranty or guarantee, expressed or implied as to its accuracy. Prospective Buyer or Tenant should conduct an independent investigation and verification of all matters deemed to be material, including, but not limited to, statements of income and expenses. Consult your attorney, accountant, or other professional advisor.

Property owned by:



Exclusively represented by:

