



2075 Corte Del Nogal
Carlsbad, CA



Features

4,120 SF available (Divisible to 2,060 SF)

60% office / 40% warehouse

2 roll up doors

3.0/1,000 parking ratio

Lease rate: \$1.25/SF + CAM (CAM = \$0.15)

Contact

Russ Jabara
858.369.3053
rjabara@kiddermathews.com
LIC #01315296

Dave Pinegar
858.369.3052
davep@kiddermathews.com
LIC #00856143

Floor Plan

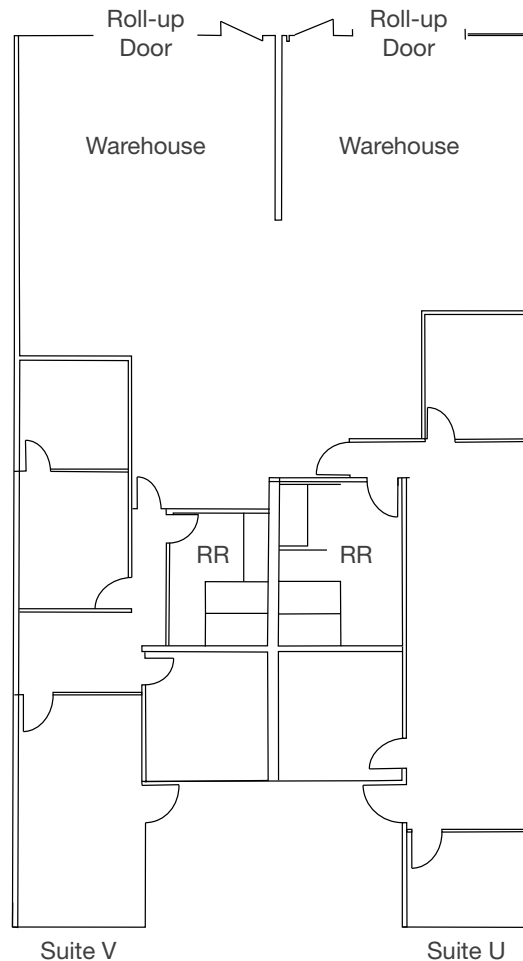

Suite	Total SF	Suite Description	Rent	Available
U+V	4,718	5 private offices, conference room, 2 restrooms	\$1.25/SF + CAM	Now

\$0.15 CAM Fee

Contact

Russ Jabara
858.369.3053
rjabara@kiddermathews.com
LIC #01315296

Dave Pinegar
858.369.3052
davep@kiddermathews.com
LIC #00856143

Aerial

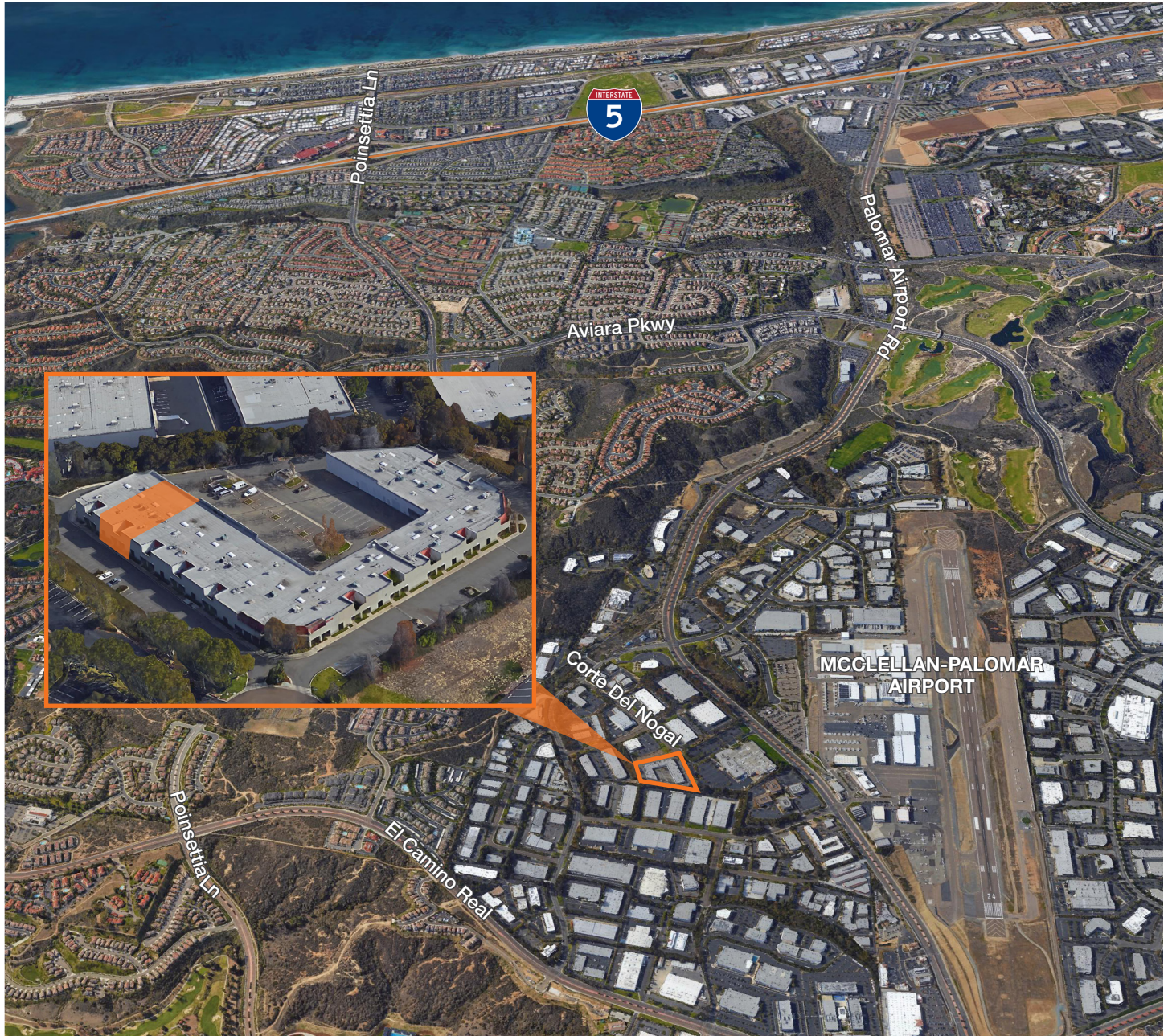

Contact

Russ Jabara
858.369.3053
rjabara@kiddermathews.com
LIC #01315296

Dave Pinegar
858.369.3052
davep@kiddermathews.com
LIC #00856143