

Southgate Shopping Center
Retail Space and Ground
Lease Available

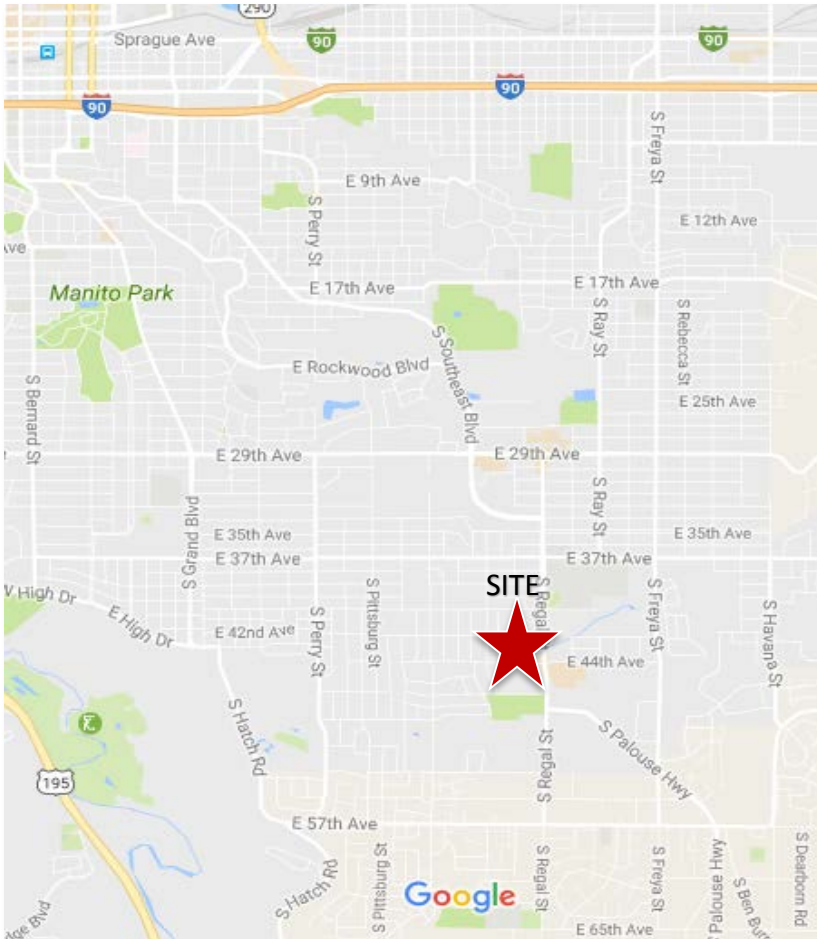

4508-4600 S. Regal St.

Spokane, Washington 99223

Property Features:

- Space Available:
 - 3,500 SF (Pad Site)
 - \$5,000/ Month
 - 720 SF (Former U-Haul)
 - \$22.00/SF NNN
 - 121 SF (Former Drive Thru Juice/ Coffee Stand)
 - \$2,500/ Month NNN
- Population Within 3 Miles: 61,622
- Population Within 5 Miles: 118,583
- Great Exposure with 23,800 Cars Per Day on Regal
- Nearby Tenants:
 - Rite Aid, Shopko, Target, Ace Hardware, Jiffy Lube, AT&T, Wendy's, McDonalds, Verizon Wireless, Trader Joe's, etc.

For More Information, Contact:

Chris Bell, SIOR

+1 509 622 3538 • cbell@naiblack.com

NO WARRANTY OR REPRESENTATION, EXPRESS OR IMPLIED, IS MADE AS TO THE ACCURACY OF THE INFORMATION CONTAINED HEREIN, AND THE SAME IS SUBMITTED SUBJECT TO ERRORS, OMISSIONS, CHANGE OF PRICE, RENTAL OR OTHER CONDITIONS, PRIOR SALE, LEASE OR FINANCING, OR WITHDRAWAL WITHOUT NOTICE, AND OF ANY SPECIAL LISTING CONDITIONS IMPOSED BY OUR PRINCIPALS NO WARRANTIES OR REPRESENTATIONS ARE MADE AS TO THE CONDITION OF THE PROPERTY OR ANY HAZARDS CONTAINED THEREIN OR ANY TO BE IMPLIED.

Black Commercial, Inc.
801 W Riverside, Suite 300
Spokane, WA 99201
+1 509 623 1000
naiblack.com

Southgate Shopping Center
Retail Space and Ground
Lease Available



SOUTHGATE SHOPPING CENTER

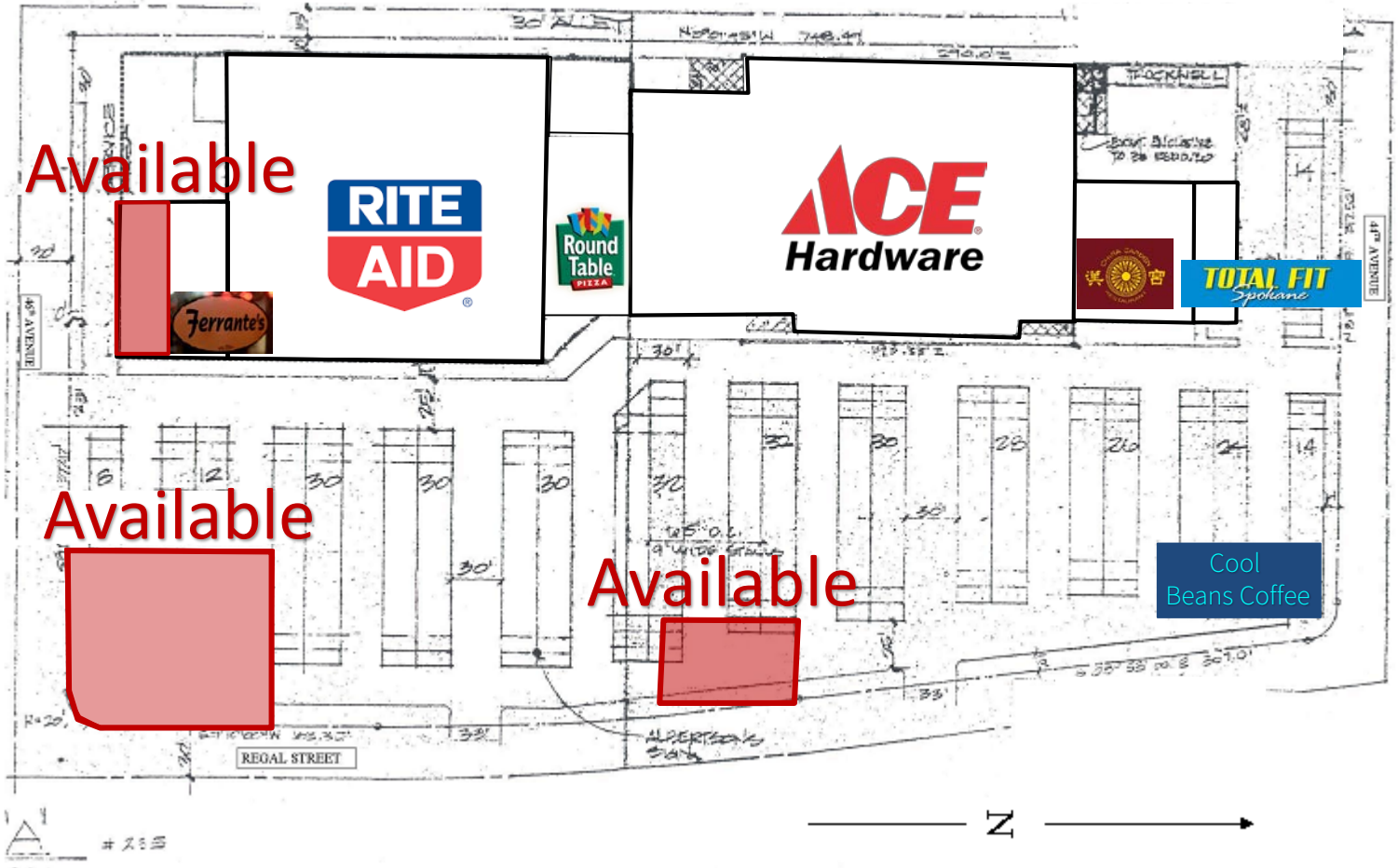

For More Information, Contact:

Chris Bell, SIOR

+1 509 622 3538
cbell@naiblack.com

NO WARRANTY OR REPRESENTATION, EXPRESS OR IMPLIED, IS MADE AS TO THE ACCURACY OF THE INFORMATION CONTAINED HEREIN, AND THE SAME IS SUBMITTED SUBJECT TO ERRORS, OMISSIONS, CHANGE OF PRICE, RENTAL OR OTHER CONDITIONS, PRIOR SALE, LEASE OR FINANCING, OR WITHDRAWAL WITHOUT NOTICE, AND OF ANY SPECIAL LISTING CONDITIONS IMPOSED BY OUR PRINCIPALS. NO WARRANTIES OR REPRESENTATIONS ARE MADE AS TO THE CONDITION OF THE PROPERTY OR ANY HAZARDS CONTAINED THEREIN OR ANY TO BE IMPLIED.

Black Commercial, Inc.
801 W Riverside, Suite 300
Spokane, WA 99201
+1 509 623 1000
naiblack.com