

# port washington, ny

## 65 shore road

gold coast development outparcel | available for ground lease



DEMOGRAPHICS	1 MILE	3 MILES	5 MILES
Population	18,619	55,583	160,953
Median HHI	\$106,475	\$122,932	\$97,726
Daytime Population	16,946	53,879	169,054

Available	+/- 3,000 square feet (retail/bank pad opportunity)
Asking Rent	Upon request
Extras	approximately \$11.35 per square foot
Area Retail	Stop & Shop, Home Goods, Burger King, Petland Discounts, Sherwin Williams, Rite Aid, ACE Hardware, West Marine, HSBC, Roslyn Savings Bank and many more
Comments	<ul style="list-style-type: none"><li>• prime retail opportunity in the heart of Long Island's famed Gold Coast</li><li>• Stop &amp; Shop anchored center</li><li>• can do drive-thru</li></ul>

**For More Information:**

Stu Fagen | Executive Vice President | fagen@sabre.life | T 516 874 8070 x1503

Jayson Siano | Managing Principal | siano@sabre.life | T 516 874 8070 x1501

**sabre.life**



# port washington, ny

65 shore road

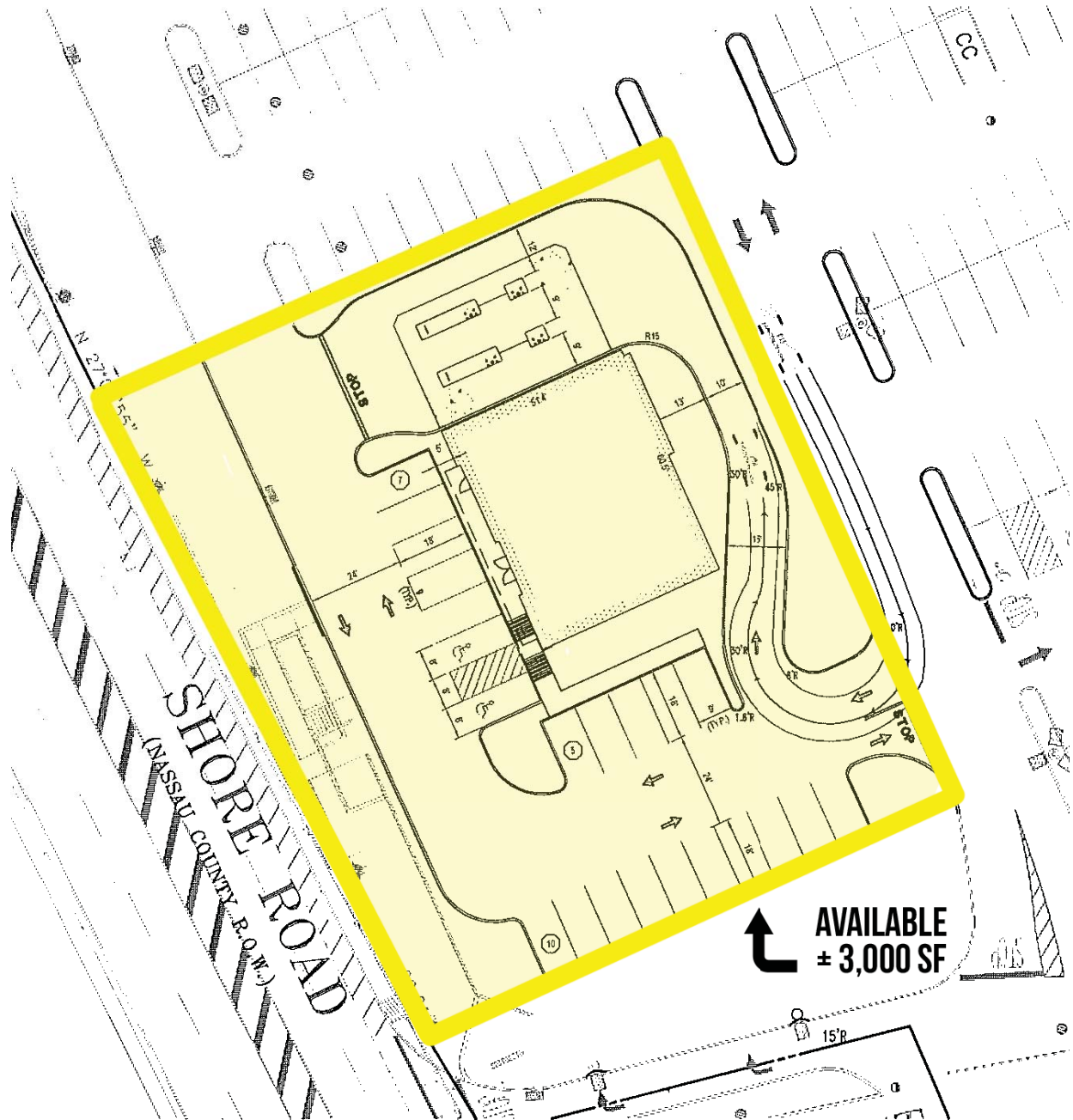

**For More Information:**

Stu Fagen | Executive Vice President | fagen@sabre.life | T 516 874 8070 x1503

Jayson Siano | Managing Principal | siano@sabre.life | T 516 874 8070 x1501

**sabre.life**





# port washington, ny

## 65 shore road



### For More Information:

**Stu Fagen** | Executive Vice President | [fagen@sabre.life](mailto:fagen@sabre.life) | T 516 874 8070 x1503

**Jayson Siano** | Managing Principal | [siano@sabre.life](mailto:siano@sabre.life) | T 516 874 8070 x1501

Sabre Real Estate Group, LLC

500 Old Country Road Garden City NY 11530

500 Route 17 South Hasbrouck Heights NJ 07604

**sabre.life**

© Sabre Real Estate Group, LLC. This information has been obtained from sources believed reliable. We have not verified it and make no guarantee, warranty or representation about it. Any projections, opinions, assumptions or estimates used are for example only and do not represent the current or future performance of the property. You and your advisors should conduct a careful, independent investigation of the property to determine to your satisfaction the suitability of the property for your needs.

# SABRE