



FOR LEASE

OFFERING SUMMARY

YEAR BUILT	2000
BUILDING SIZE	±10,995 SF
AVAILABILITY	
Suite A-1	2,653 SF
LEASE RATE	\$25.00/SF (MG)
TENANT IMPROVEMENTS	Negotiable
PARKING	5:1,000 SF
APN	200-76-006Y
ZONING	C-O, City of Glendale

PROPERTY HIGHLIGHTS

Medical or office suite available within 10,995 SF professional office building. The property features nicely manicured landscaping with ample covered and uncovered parking.

- **Monument signage available**
- **Situated between 3 major hospitals**
- **Strong traffic counts**
- **125,000 population within a 3-mile radius**

Kevin Helland
D 480 423 7942
C 623 293 1543
kevin.helland@avisonyoung.com

Nicholas Pelusio
D 480 423 7903
C 602 505 3010
nicholas.pelusio@avisonyoung.com

2720 E Camelback Road
Suite 150
Phoenix, AZ 85016
avisonyoung.com

EXTERIOR PHOTOS



INTERIOR PHOTOS



SITE PLAN

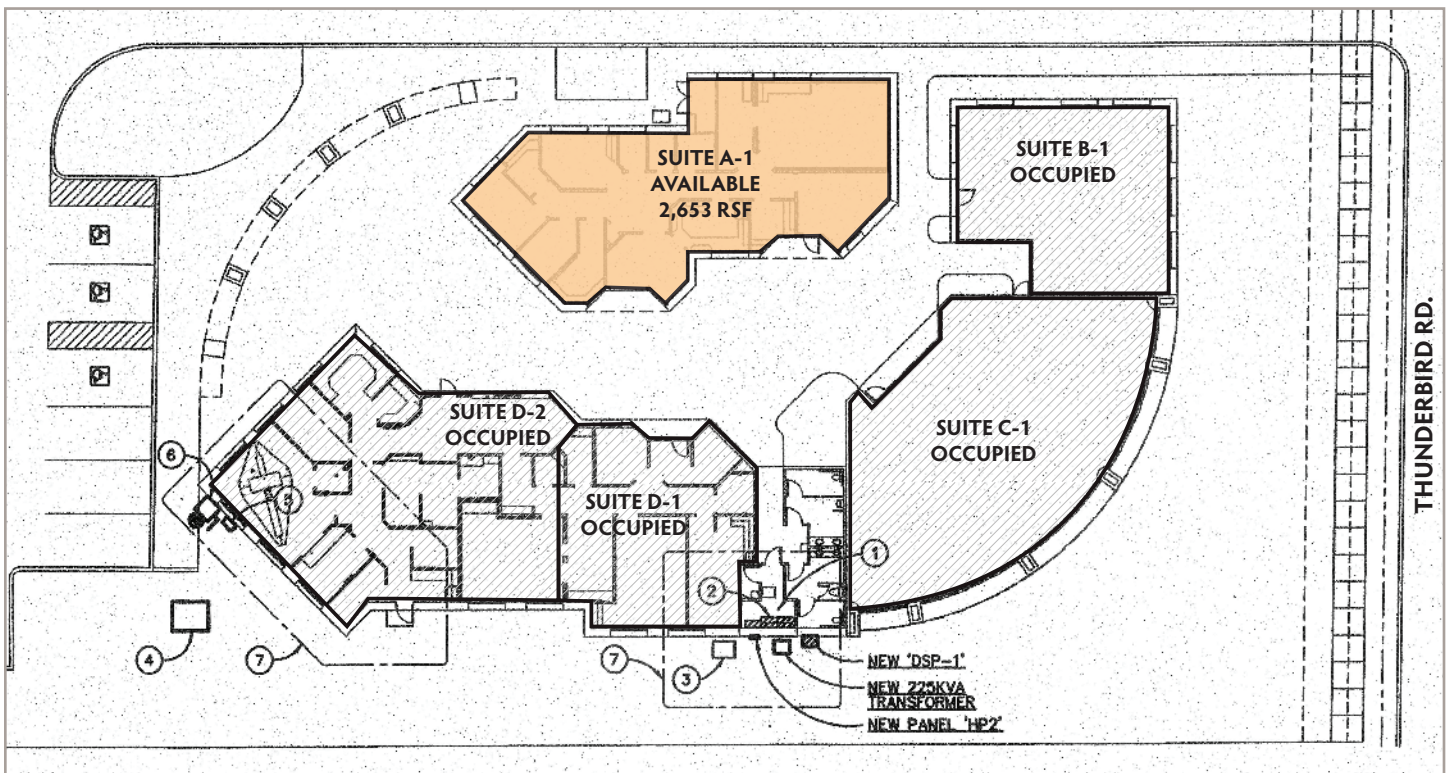

SUITE A-1
2,653 SF



REGIONAL MAP



AERIAL

