

PRIME RETAIL SPACE ADJACENT TO KOHL'S

Richmond, VA 23235 | 11331 Midlothian Tpke | Midlothian Tpke & Courthouse Rd | #1401 Midlothian



AVAILABLE SF:
24,100 SF

FRONTAGE:
98' 0"

ZONING:
GENERAL BUSINESS

RATES:
CALL FOR DETAILS

AREA ANCHORS



- 24,100 SF of Jr. Anchor Space located adjacent to Kohl's & Target
- Located across the street from Chesterfield Towne Center, which is the largest enclosed mall in Richmond
- Center benefits from multiple points of ingress and egress
- Located in affluent submarket with Average Household Income of \$103,628 within 3 miles

DEMOGRAPHICS	1 MILE	3 MILES	5 MILES	TRAFFIC COUNTS	
2018 Population Density	3,642	60,135	131,161	Midlothian Turnpike	52,000
2018 Daytime Population	17,463	61,241	134,186	Branchway Rd	6,300
2018 Average HH Income	97,935	103,628	100,659	Research Rd	5,600
2018 Median HH Income	79,542	81,200	75,233		



FOR MORE INFORMATION, CONTACT EXCLUSIVE AGENT(S):
KAREN MIKULSKI • karen.mikulski@tscg.com • 757.722.2500
CHRISTINA MAYHUGH • christina.mayhugh@tscg.com • 804.673.1100



PRIME RETAIL SPACE ADJACENT TO KOHL'S

Richmond, VA 23235 | 11331 Midlothian Tpke | Midlothian Tpke & Courthouse Rd | #1401 Midlothian

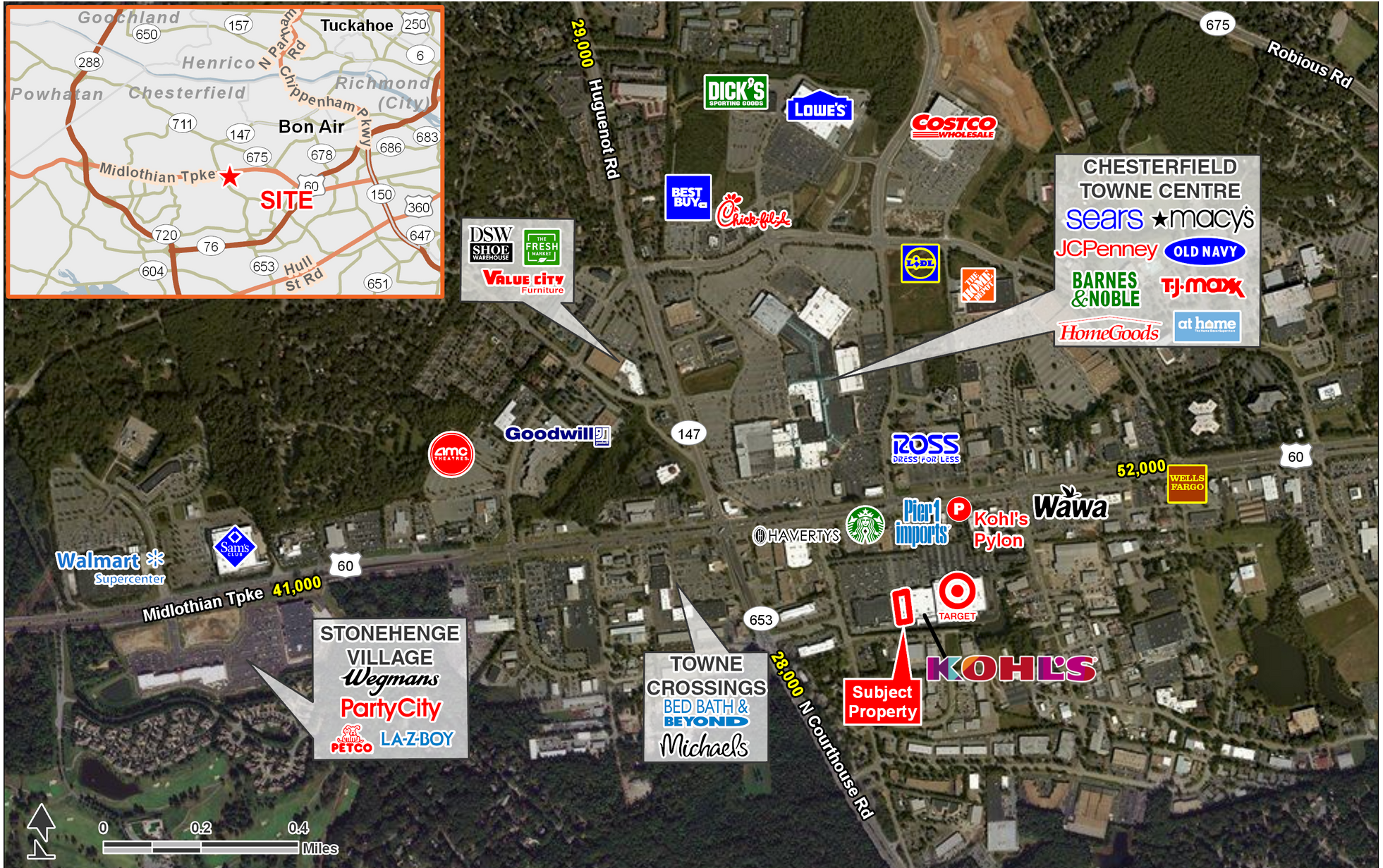

FOR MORE INFORMATION, CONTACT EXCLUSIVE AGENT(S):
 KAREN MIKULSKI • karen.mikulski@tscg.com • 757.722.2500
 CHRISTINA MAYHUGH • christina.mayhugh@tscg.com • 804.673.1100



Demographics: Esri 2018 No warranty expressed or implied has been made as to the accuracy of the information provided herein, no liability assumed for error or omissions.

PRIME RETAIL SPACE ADJACENT TO KOHL'S

Richmond, VA 23235 | 11331 Midlothian Tpke | Midlothian Tpke & Courthouse Rd | #1401 Midlothian

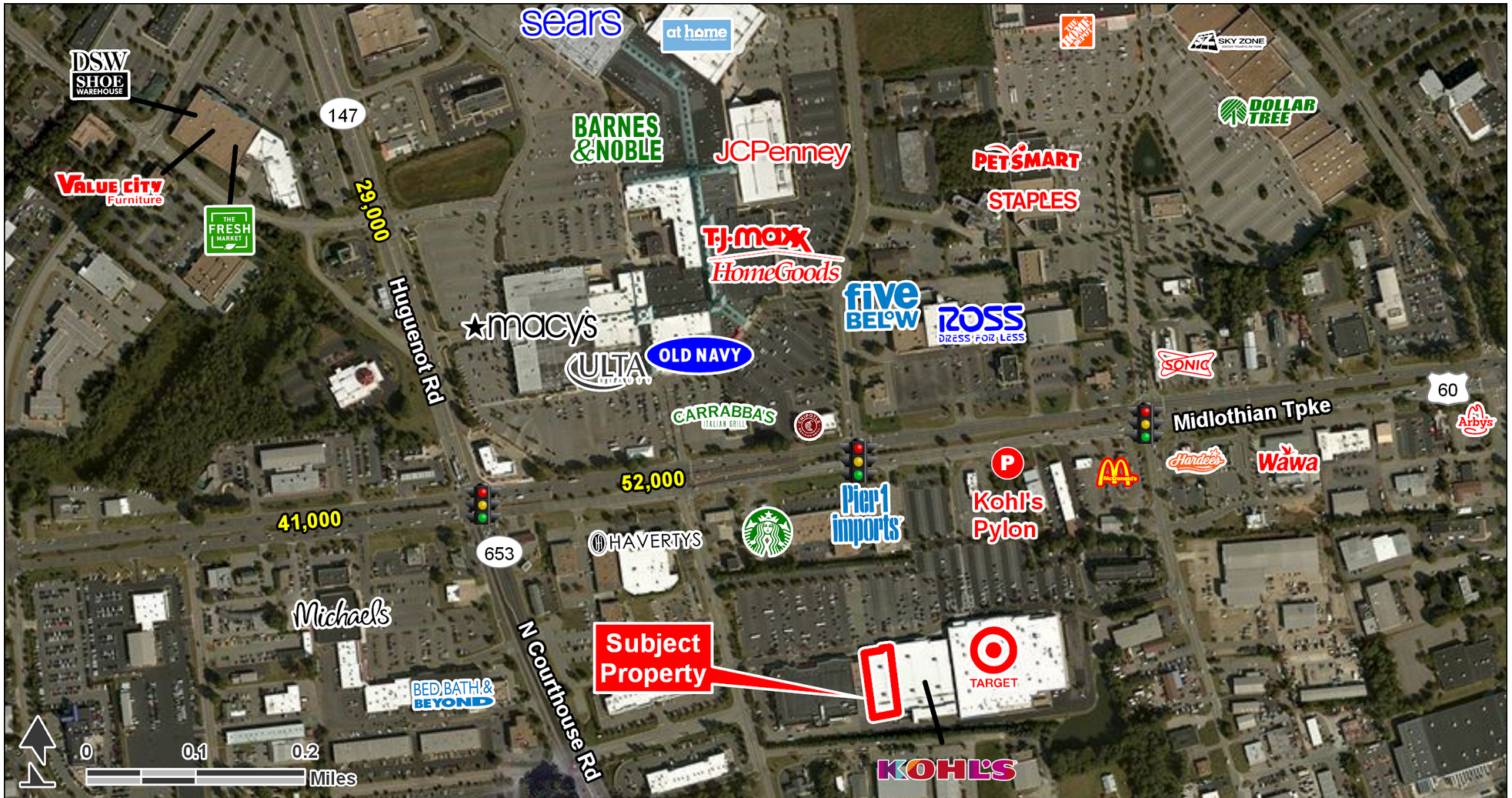

FOR MORE INFORMATION, CONTACT EXCLUSIVE AGENT(S):
KAREN MIKULSKI • karen.mikulski@tscg.com • 757.722.2500
CHRISTINA MAYHUGH • christina.mayhugh@tscg.com • 804.673.1100



Demographics: Esri 2018 No warranty expressed or implied has been made as to the accuracy of the information provided herein, no liability assumed for error or omissions.

PRIME RETAIL SPACE ADJACENT TO KOHL'S

Richmond, VA 23235 | 11331 Midlothian Tpke | Midlothian Tpke & Courthouse Rd | #1401 Midlothian

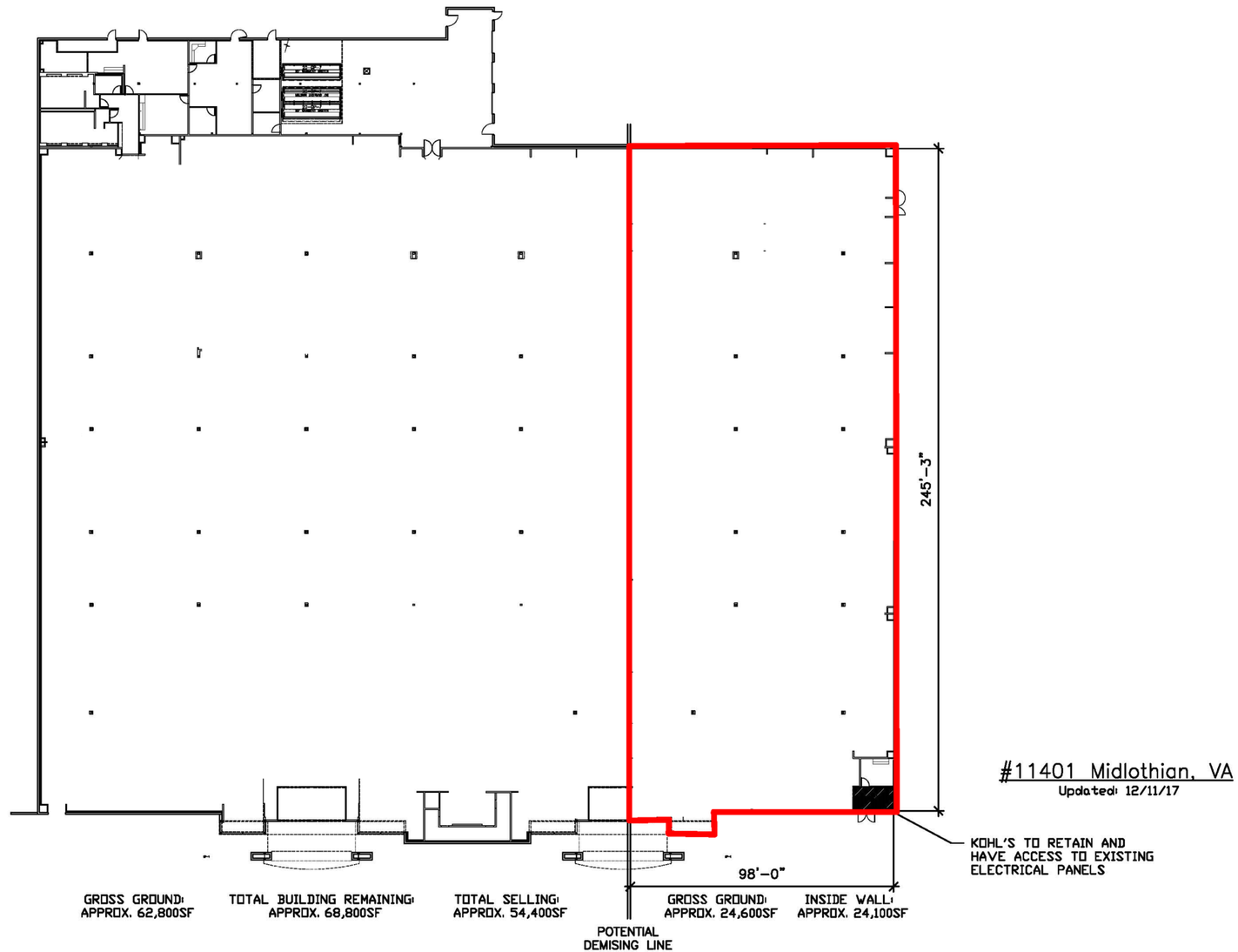

FOR MORE INFORMATION, CONTACT EXCLUSIVE AGENT(S):
KAREN MIKULSKI • karen.mikulski@tscg.com • 757.722.2500
CHRISTINA MAYHUGH • christina.mayhugh@tscg.com • 804.673.1100

