

# 111 4TH AVENUE

BETWEEN EAST 11TH & EAST 12TH STREETS | UNION SQUARE

**ksr**  
KASSIN SABBAGH REALTY



# 111 4TH AVENUE

BETWEEN EAST 11TH & EAST 12TH STREETS | UNION SQUARE

## SIZE

Ground Floor **4,122 SF**

### Optional divisions

Space A **1,292 SF**

Space B **2,830 SF**

## CEILING HEIGHT

20'

## FRONTAGE

40'

## TRANSPORTATION

L N Q R W 4 5 6

## ASKING RENT

Upon Request

## POSSESSION

Arranged

## COMMENTS

- Space can be divided
- Food uses accepted

## OPTIONAL DIVISIONS

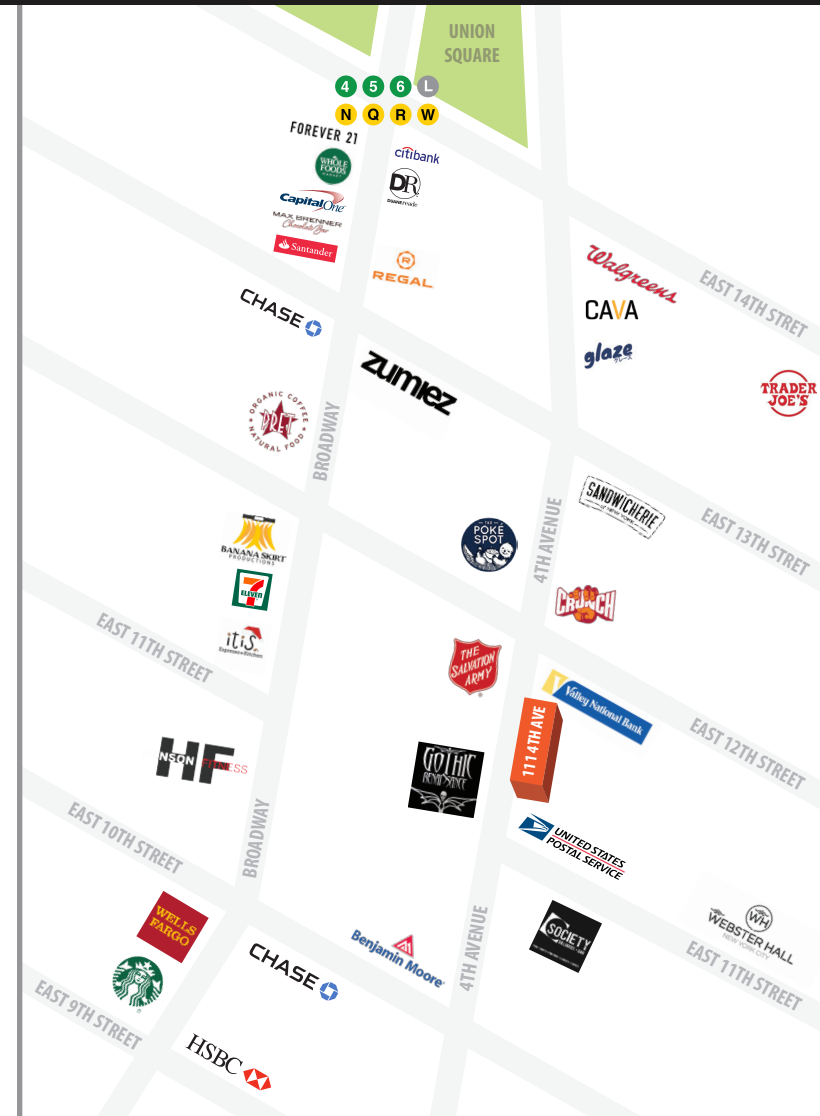
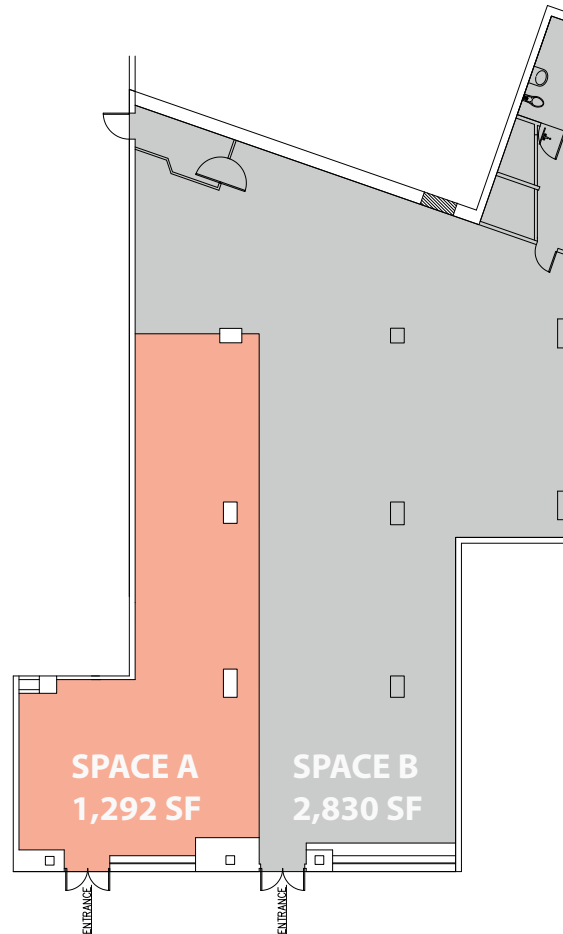

**KASSIN SABBAGH REALTY**  
1385 Broadway 22nd floor  
New York, NY 10018  
(212) 417 - 9217  
www.ksrny.com

CONTACT OUR BROKER(S) FOR MORE INFORMATION

**ALBERT HALAWANI**

AHalawani@ksrny.com

**347.204.6578**