



AERO | KEARNY MESA

9797 AERO DRIVE



PROPERTY OVERVIEW



NOW LEASING

9797 AERO is new throughout, perfect for users seeking a progressive work environment in Central San Diego. Open and inviting, the building features overhead roll-up doors that welcome the outdoors into ground floor tenant interiors and a new fitness center. There is a spacious outdoor gathering area, beckons as open air collaborative space or a friendly place to relax. AERO is walking distance to numerous restaurants and retail shops, right off the I-15 and miles ahead of the market.

PROPERTY HIGHLIGHTS

- Multi-million dollar renovation
- New entry and two-story atrium lobby
- Outdoor area
- Wi-Fi throughout
- Fitness Center with lockers and showers
- Walking distance to restaurants and retail
- 23,500 SF floor plates
- Covered parking
- Electric car charging station
- Freeway visibility, prominent signage opportunity



THIRD FLOOR

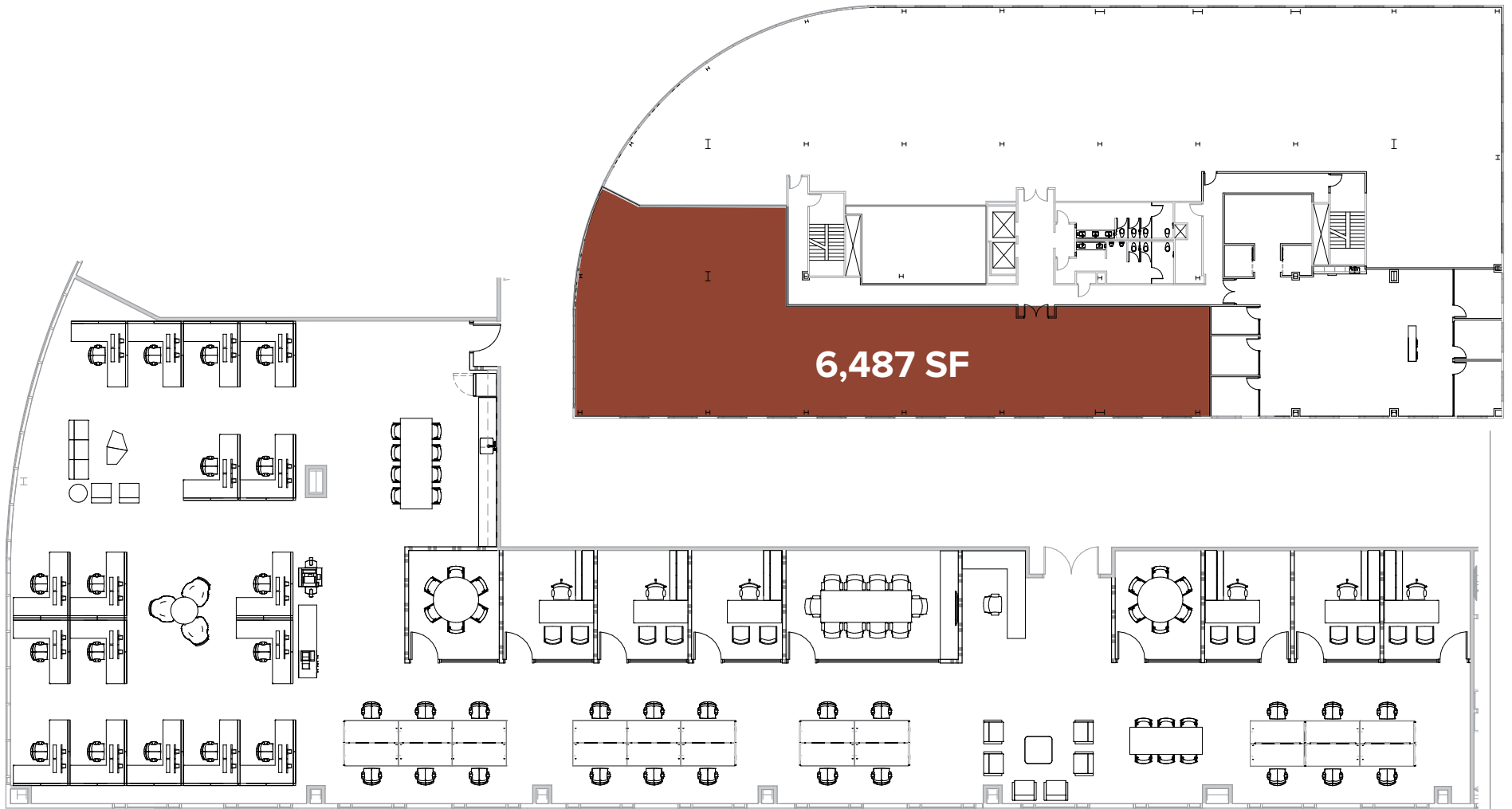

Hypothetical Space Plan

DEREK HULSE
derek.hulse@cushwake.com
858.677.5370
Lic #01740180





FOR MORE INFORMATION, PLEASE CONTACT

DEREK HULSE
derek.hulse@cushwake.com
858.677.5370
Lic #01740180

