

**NEW LISTING!**

# Shrewsbury Central Park

820 Boston Turnpike Road, Shrewsbury, MA



*High exposure building right on  
Route 9, halfway between  
Routes 20 and 140, just six miles  
from Interstate 495.*

**Office \* R&D \* Warehouse \* Manufacturing**

**2 Loading Docks & 1 Drive-In Door**

**Plenty of Parking**

**18' Clear Height**

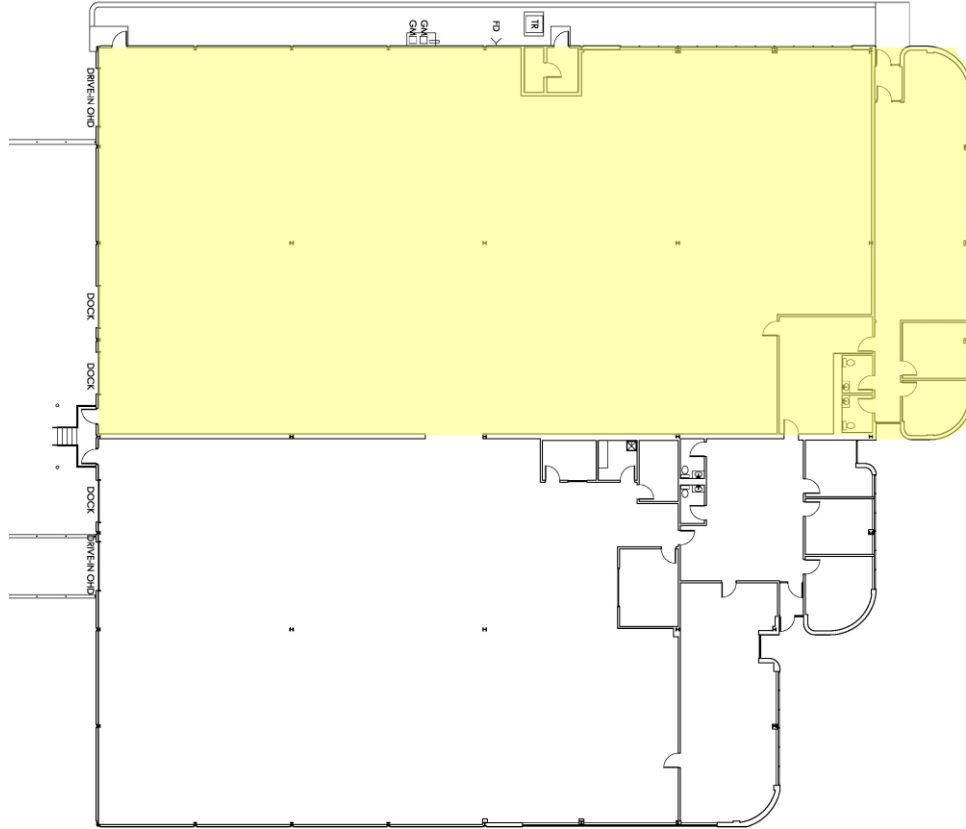

# **BROKERS PROTECTED Full Commissions Paid**

**For more information and to schedule a viewing, please call:**

# **Cutler**

**Management Corp**

**(508) 792-1111 x-101**

*Proudly celebrating 40 years!*



**or visit our website:**

**[www.cutlermanagement.com](http://www.cutlermanagement.com)**

We believe this information to be accurate. We are not, however responsible for errors or omissions, prior sales, leases or price changes, and we reserve the right to withdraw this property from the market without notice.