



- Several retail spaces available at Eight Street Center
- Former Goodfellas' space is 14,400 SF. Can be divided to offer two 7,200 SF spaces.
- This space has two overhead doors in the rear. Conveyor belt in rear leads to additional 2,400 SF upper level.
- Former Pro-Care Health Services space available. 5,000 SF up front with additional 2,000 SF of storage space available in the rear.
- Neighboring tenants included Family Dollar, Rent-A-Center, Jamie's Place, C&R Carpetmill Outlet, McLeod Telecomm.



WILL HAYES

E-MAIL: willhayes@josephcamper.com | CELL: 309-643-0717



DEMOGRAPHICS (2017 EST.)

	1 MILE RADIUS	3 MILE RADIUS	5 MILE RADIUS
POPULATION	10,410	36,146	49,951
HOUSEHOLDS	3,049	10,341	14,858
INCOME	\$57,004	\$64,603	\$66,637

PROPERTY DETAILS

PROPERTY TYPE	RETAIL/OFFICE
ZONING	COMMERCIAL BUSINESS
YEAR BUILT	1977
SPACES AVAILABLE	1416 - #1 - 2,000 SF #2 - 5,000 SF 1414 - 7,200 SF 1412 - 7,200 SF
LEASE PRICE	\$5.50 PSF NNN
NNN AMOUNT	\$2.00 PSF

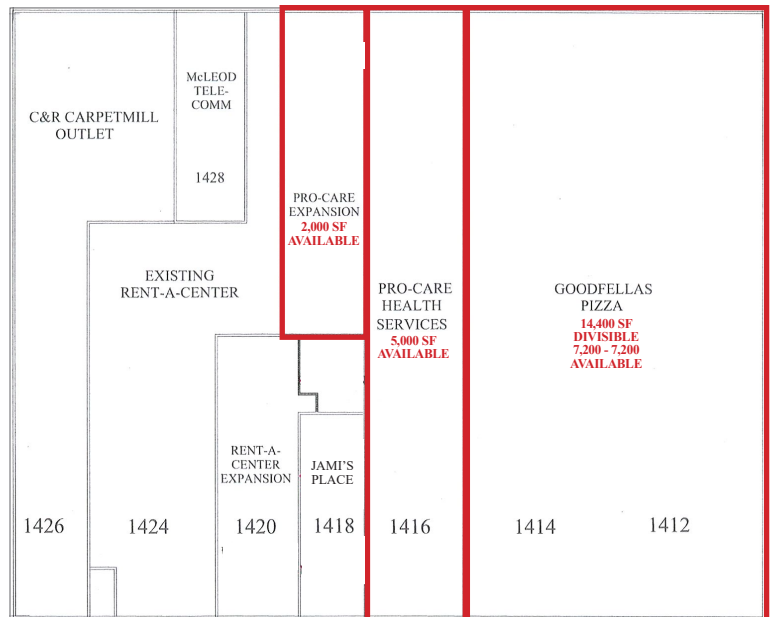

WILL HAYES

E-MAIL: willhayes@josephcamper.com | CELL: 309-643-0717