

Center of Commerce - Bldg 907

3001-3005 Mercy Drive

Orlando, FL 32808

FOR LEASE



Features:

- ◆ Total Size: 137,540 SF
- ◆ Availability:

Suite	Size	Office	OH Doors
3001	85,610	7,446	18 Dock / 2 Ramped to 2' / 2 9' x 10' grade level door
- ◆ Available May 1, 2017
- ◆ Ceiling Height: 26'
- ◆ Column Spacing: 42'W x 40'D
- ◆ Building Depth: 200'
- ◆ Constuction: Concrete Tilt Wall
- ◆ Truck Court: 133'-150' including a 50' concrete apron
- ◆ Parking: 1.2/1,000
- ◆ Misc: Outside fenced storage available

Financial Information:

- ◆ Base Rent: \$5.45 psf NNN
- ◆ Operating Expenses: \$1.64 psf



4700 Millenia Blvd
Suite 200
Orlando, FL 32839
ph: 321.281.8500 fx: 321.281.8519
www.lee-associates.com

Tom McFadden, SIOR

321.281.8501

tmcfadden@lee-associates.com

William "Bo" Bradford, CCIM, SIOR

321.281.8502

bbradford@lee-associates.com

All information furnished regarding property for sale, rental or financing is from sources deemed reliable, but no warranty or representation is made to the accuracy thereof and same is submitted to errors, omissions, change of price, rental or other conditions prior to sale, lease or financing or withdrawal without notice. No liability of any kind is to be imposed on the broker herein.

Center of Commerce - Bldg 907

3001-3005 Mercy Drive

Orlando, FL 32808

FOR LEASE

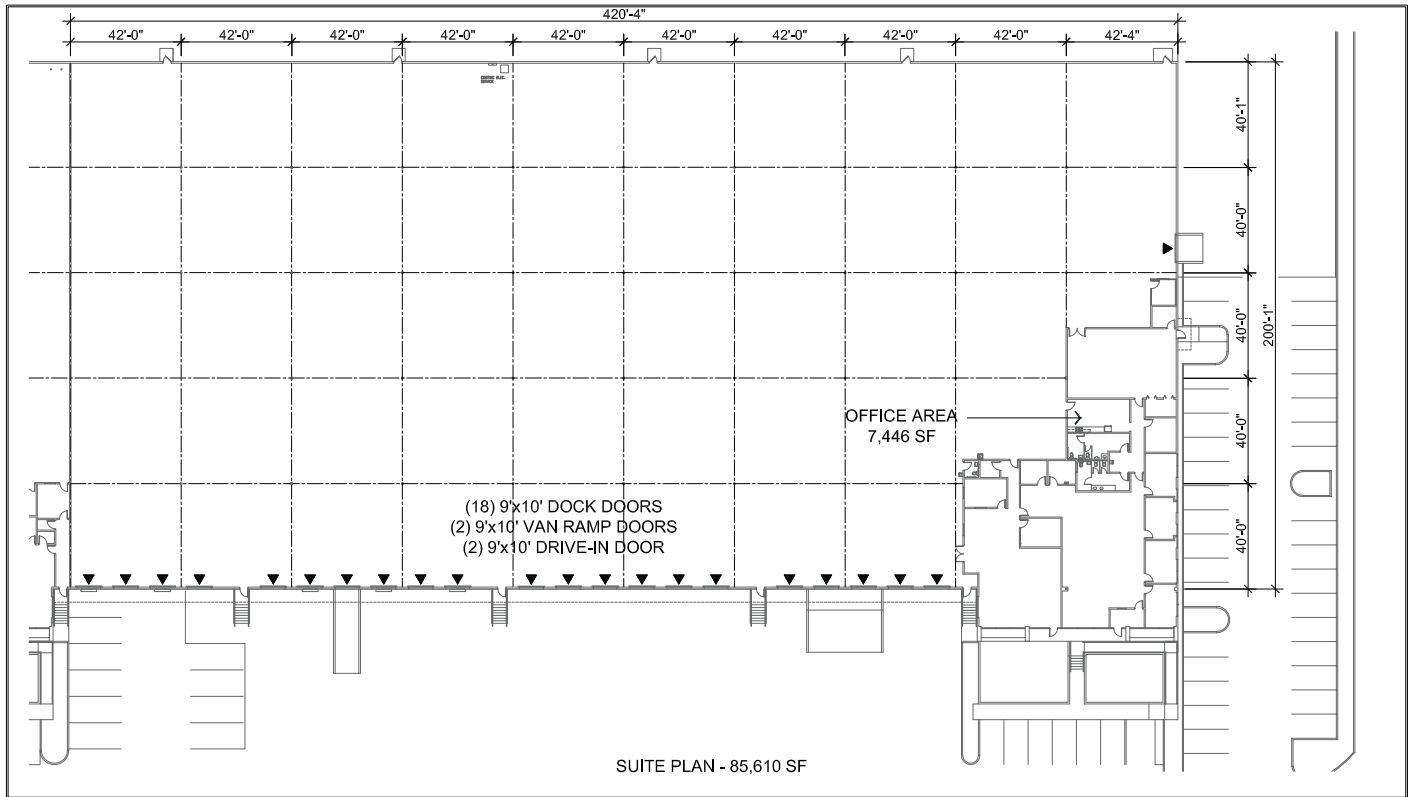

SCALE: 1/32" = 1'-0"

FEBRUARY 1, 2017

300-01 MERCY DRIVE
SUITE PLAN
ORLANDO, FLORIDA

00000



transportation:

- ◆ Lee Road
- ◆ Orange Blossom Trail
- ◆ Interstate 4
- ◆ SR 408 (East/West Expressway)



4700 Millenia Blvd
Suite 200
Orlando, FL 32839
ph: 321.281.8500 fx: 321.281.8519
www.lee-associates.com

All information furnished regarding property for sale, rental or financing is from sources deemed reliable, but no warranty or representation is made to the accuracy thereof and same is submitted to errors, omissions, change of price, rental or other conditions prior to sale, lease or financing or withdrawal without notice. No liability of any kind is to be imposed on the broker herein.

Tom McFadden, SIOR

321.281.8501

tmcfadden@lee-associates.com

William "Bo" Bradford, CCIM, SIOR

321.281.8502

bbradford@lee-associates.com