

FOR LEASE

# WILLIAM PACA INDUSTRIAL PARK

1305

**CONTINENTAL DRIVE**  
Abingdon, MD 21009



## BUILDING SPECIFICATIONS

- + 60,000 SF Available
- + Suites A-C: 23,360 SF
  - 1,800 SF of office
  - 9 docks, 1 ramped drive-in
  - 400 AMPS @ 277/480V
  - 400 AMPS @ 120/208V
- + Suites D-H: 36,640 SF
  - 3,690 SF of office
  - 13 docks
  - 400 AMPS @ 277/480V
  - 250 AMPS @ 120/208V
- + Building is expandable by 30,000± SF
- + 24' clear ceiling height
- + 41' x 45' column spacing
- + Fully Conditioned Warehouse
- + LED Lights
- + 1200 AMPS 277/480V
- + Fenced loading area with 22± trailer drop spaces



## CONTACT US

### JUSTIN MOHLER

Senior Vice President  
+1 410 244 3116  
justin.mohler@cbre.com

### JON CASELLA

Senior Vice President  
+1 410 244 3127  
jonathan.casella@cbre.com

### CBRE, Inc.

100 E Pratt Street  
Suite 1700  
Baltimore, MD 21202

[www.cbre.com/baltimore](http://www.cbre.com/baltimore)

**CBRE**

# FOR LEASE WAREHOUSE SPACE

1305  
CONTINENTAL DRIVE  
Abingdon, MD 21009

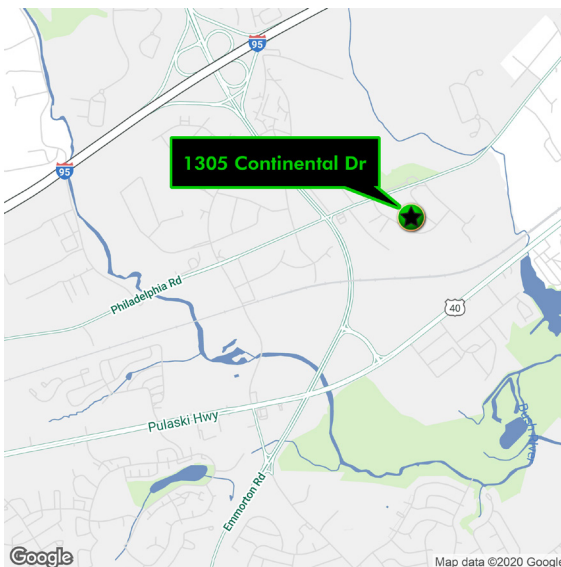
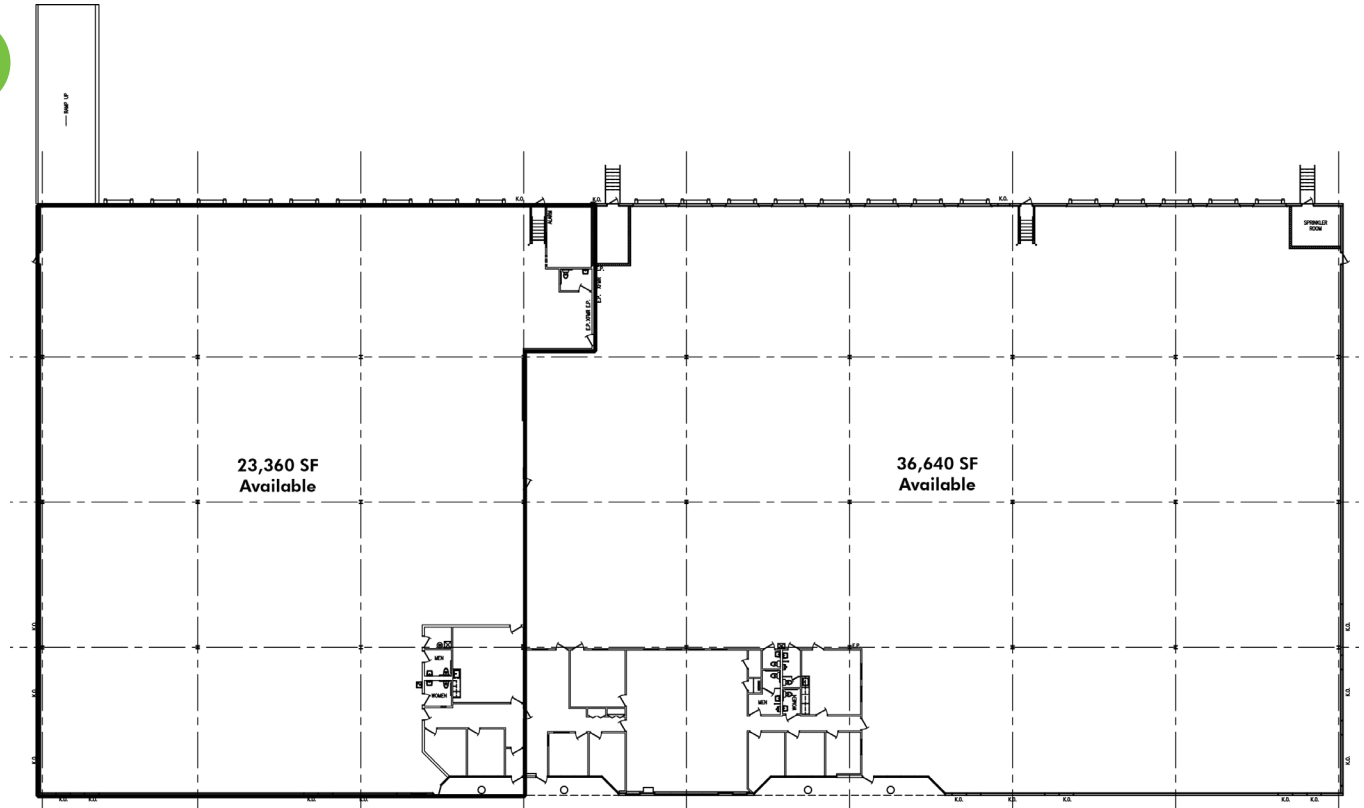

## TRAVEL DISTANCES

- 0.9 miles to I-95
- 9 miles to Aberdeen Proving Ground
- 13 miles to I-695
- 20 miles to the Port of Baltimore
- 34 miles to BWI Airport

© 2020 CBRE, Inc. The information contained in this document has been obtained from sources believed reliable. While CBRE, Inc. does not doubt its accuracy, CBRE, Inc. has not verified it and makes no guarantee, warranty or representation about it. It is your responsibility to independently confirm its accuracy and completeness. Any projections, opinions, assumptions or estimates used are for example only and do not represent the current or future performance of the property. The value of this transaction to you depends on tax and other factors which should be evaluated by your tax, financial and legal advisors. You and your advisors should conduct a careful, independent investigation of the property to determine to your satisfaction the suitability of the property for your needs. Photos herein are the property of their respective owners and use of these images without the express written consent of the owner is prohibited.

[www.cbre.com/baltimore](http://www.cbre.com/baltimore)

**CBRE**