

RETAIL SPACE AVAILABLE FOR LEASE

1511-1515 N. MAIN STREET, WHEATON, ILLINOIS



BUILDING SPECIFICATIONS

BUILDING SIZE:	14,458 SF
AVAILABLE SPACE:	Unit 1511: 1,534 SF Unit 1515: 1,320 SF
TRAFFIC VOLUME:	20,900 vehicles per day
ZONING:	C3 (General Business District)
LEASE RATE:	\$20.00 psf

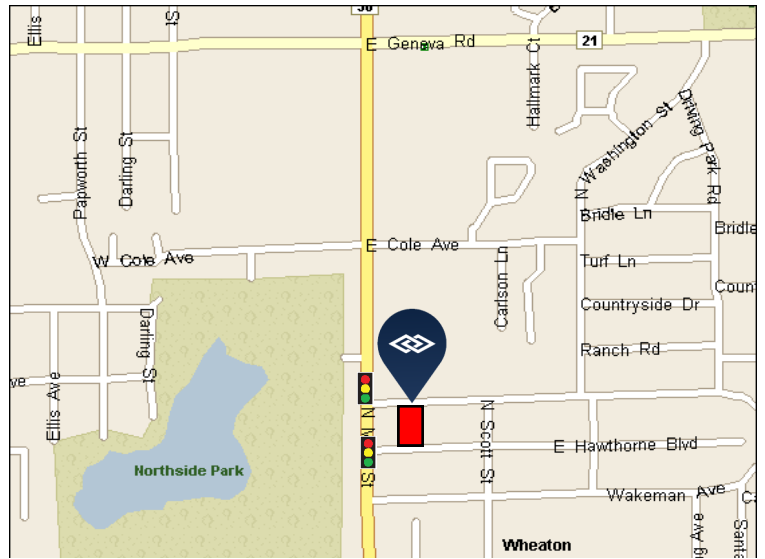

FEATURES

- Charming Main Street location
- Located between Roosevelt Road and Geneva Road
- Parking in front and rear
- Easy access. Traffic light at Main Street and Parkway Drive

**FOR ADDITIONAL
INFORMATION,
PLEASE CONTACT:**

MANDY LEWANDOWSKI
Associate
(630) 993-3851
mandy@darwinrealty.com

RETAIL SPACE AVAILABLE FOR LEASE

1511-1515 N. MAIN STREET, WHEATON, ILLINOIS

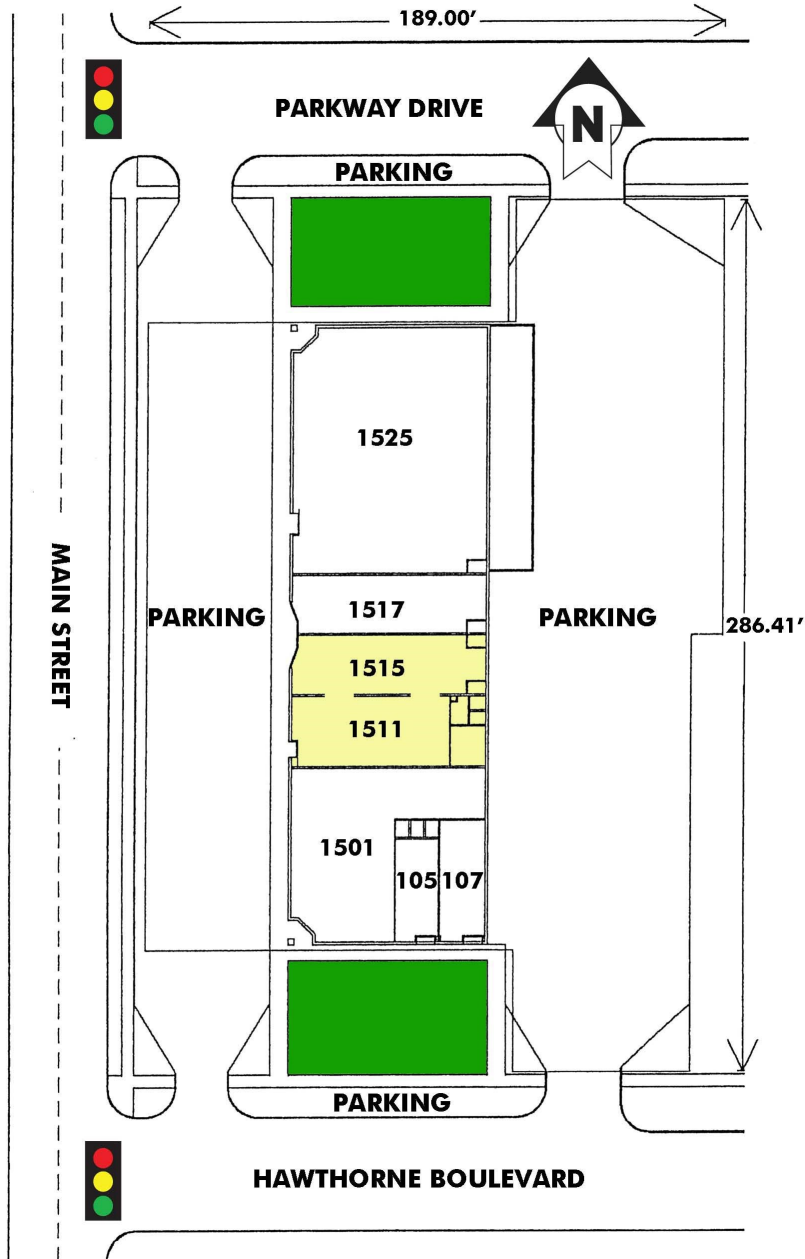

**FOR ADDITIONAL
INFORMATION,
PLEASE CONTACT:**

MANDY LEWANDOWSKI
Associate
(630) 993-3851
mandy@darwinrealty.com