



# Raymore Galleria Shops | 100% Occupied

## NNN LEASE REAL ESTATE INVESTMENT SALE

301-315 N. Dean Avenue, Raymore, MO | A Kansas City Suburb



RAYMORE GALLERIA  
17.30 +/- ACRES  
ZONED COMMERCIAL

RAYMORE GALLERIA  
SHOPPING CENTER

**SITE**

## SALE PRICE: \$2,850,000 | CAP RATE: 7.13%

### 11,945 SF Retail Strip Center in a 400,000 SF Power Center

#### Investment Summary

Sales Price:	\$2,850,000
CAP Rate:	7.13%
NOI (Current):	\$203,362
Building Size:	11,945 SF
Lot Size:	1.79 Acres
Year Built:	2007

- 100% occupied, retail shopping center, total of 5 tenants
  - NPC/Pizza Hut - 1,300+ unit franchisee
  - Slim 4 Life - corporate lease
  - Big Biscuit - 16 unit regional breakfast chain
  - Vapor Maven - 65+ unit franchise
  - Gallery Nails - well established with long term lease
- Anchored by Lowe's, Sam's Club, and Walmart Supercenter
- Signalized intersection with great visibility and access
- Located in Raymore, Missouri - one of Kansas City's fastest growing submarkets
- Other nearby tenants include Qdoba, Panda Express, Kay Jewelers, MOD Pizza, Firehouse Subs, Wendy's, Firestone, and Big O Tires

[CLICK HERE TO VIEW MORE LISTING INFORMATION](#)

**For More Information Contact:** *Exclusive Agents*  
 MAX KOSOGLAD | 816.412.7363 | [mkosoglad@blockandco.com](mailto:mkosoglad@blockandco.com)  
 DAVID BLOCK | 816.412.7400 | [dblock@blockandco.com](mailto:dblock@blockandco.com)



All information furnished regarding property for sale or lease is from sources deemed reliable, but no warranty or representation is made as to the accuracy thereof and the same is subject to errors, omissions, changes of prices, rental or other conditions, prior sale or lease or withdrawal without notice.



# Raymore Galleria Shops | 100% Occupied

NNN LEASE REAL ESTATE INVESTMENT SALE  
301-315 N. Dean Avenue, Raymore, MO | A Kansas City Suburb

11,945 SF Retail  
Strip in a 400,000  
SF Power Center

## SITE PLAN

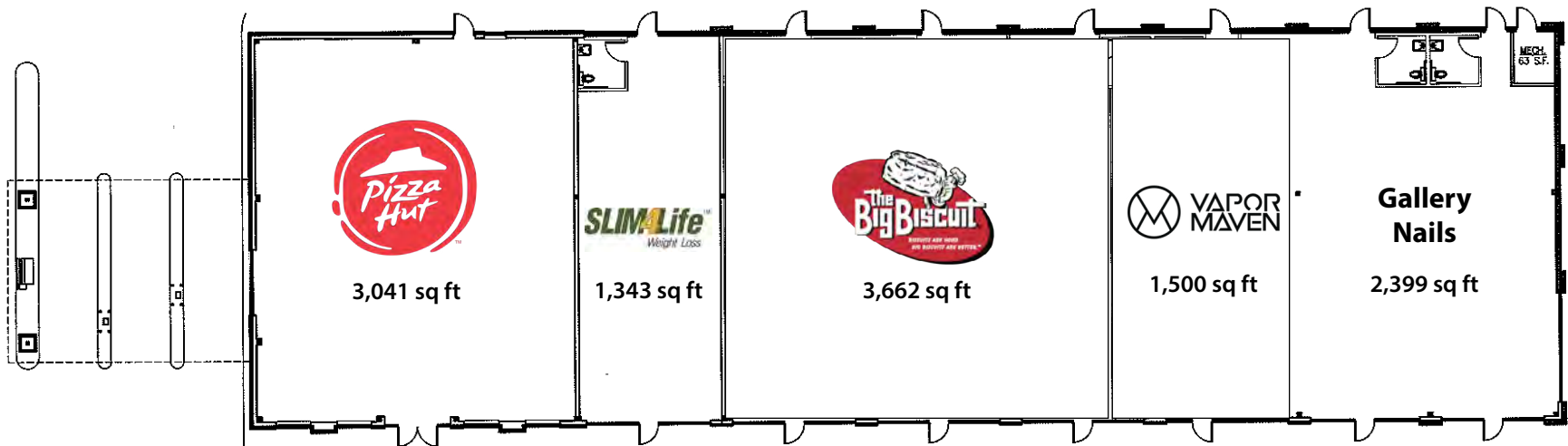

**LEASE PLAN**  
SCALE: 1/8" = 1'-0"





# Raymore Galleria Shops | 100% Occupied

## NNN LEASE REAL ESTATE INVESTMENT SALE

301-315 N. Dean Avenue, Raymore, MO | A Kansas City Suburb

11,945 SF Retail Strip in a 400,000 SF Power Center

AERIAL

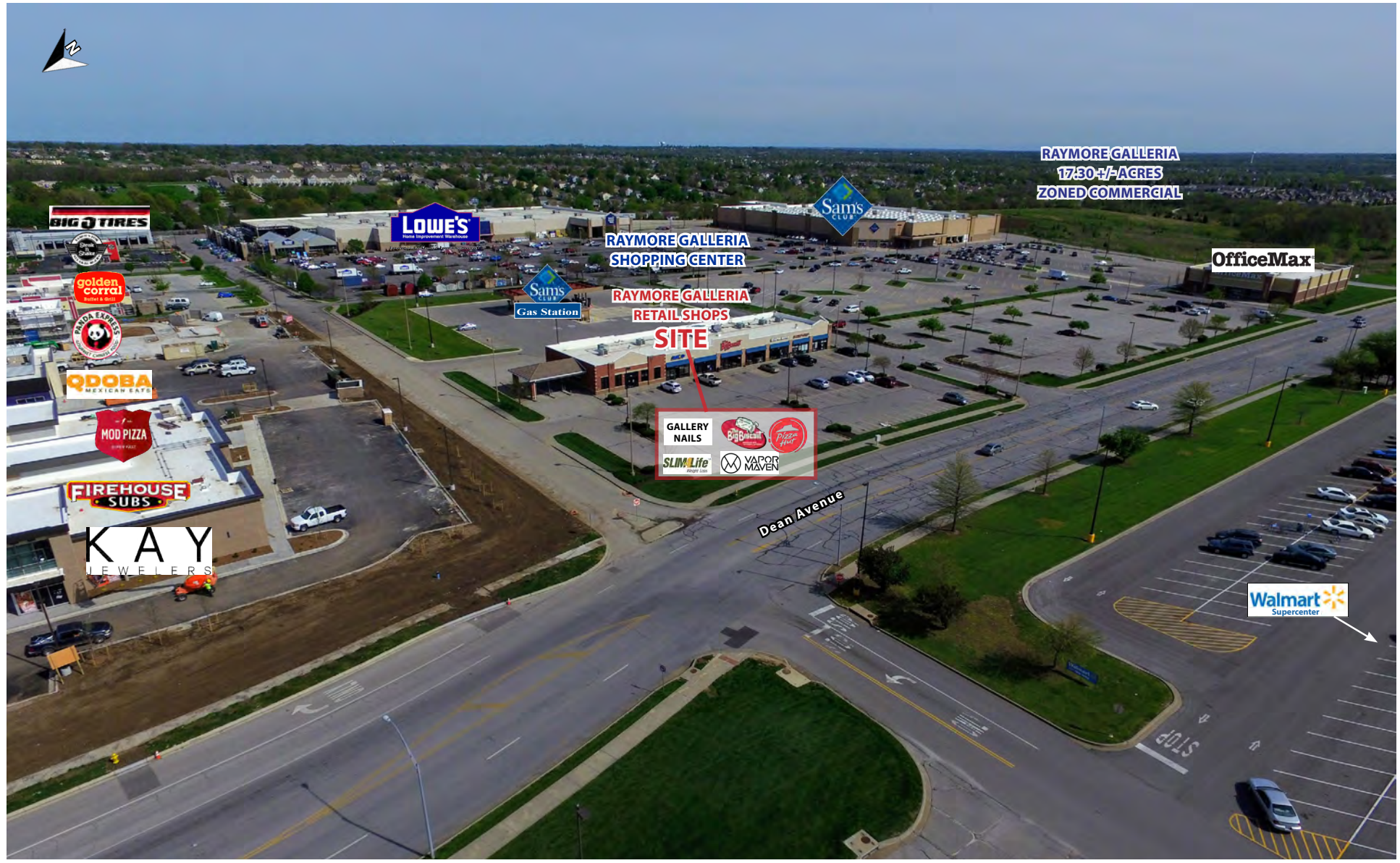



# Raymore Galleria Shops | 100% Occupied

## NNN LEASE REAL ESTATE INVESTMENT SALE

301-315 N. Dean Avenue, Raymore, MO | A Kansas City Suburb

11,945 SF Retail  
Strip in a 400,000  
SF Power Center

AERIAL

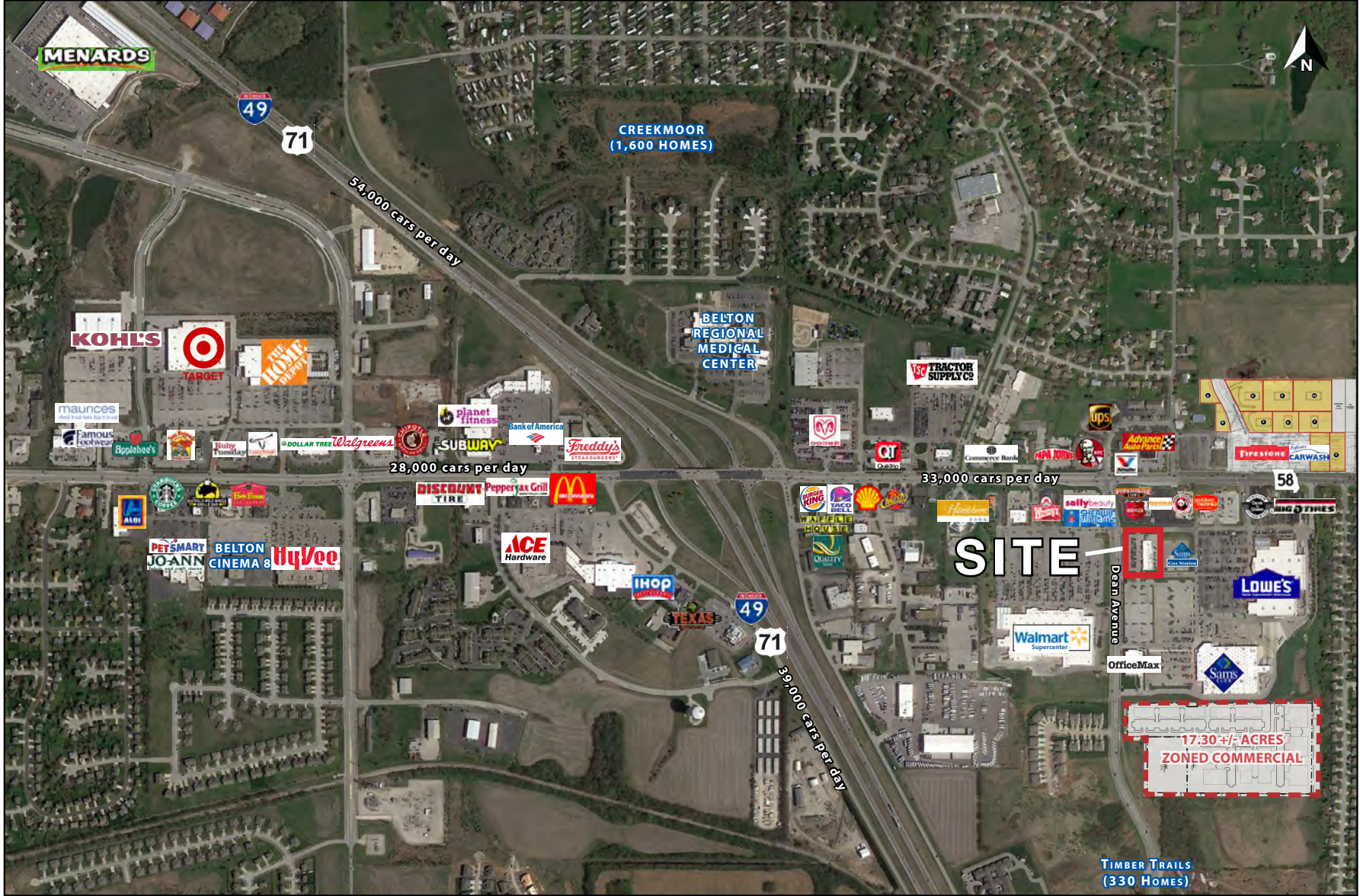

All information furnished regarding property for sale or lease is from sources deemed reliable, but no warranty or representation is made as to the accuracy thereof and the same is subject to errors, omissions, changes of prices, rental or other conditions, prior sale or lease or withdrawal without notice.



# Raymore Galleria Shops | 100% Occupied

## NNN LEASE REAL ESTATE INVESTMENT SALE

301-315 N. Dean Avenue, Raymore, MO | A Kansas City Suburb

11,945 SF Retail Strip in a 400,000 SF Power Center

### AERIAL





# Raymore Galleria Shops | 100% Occupied

## NNN LEASE REAL ESTATE INVESTMENT SALE

301-315 N. Dean Avenue, Raymore, MO | A Kansas City Suburb

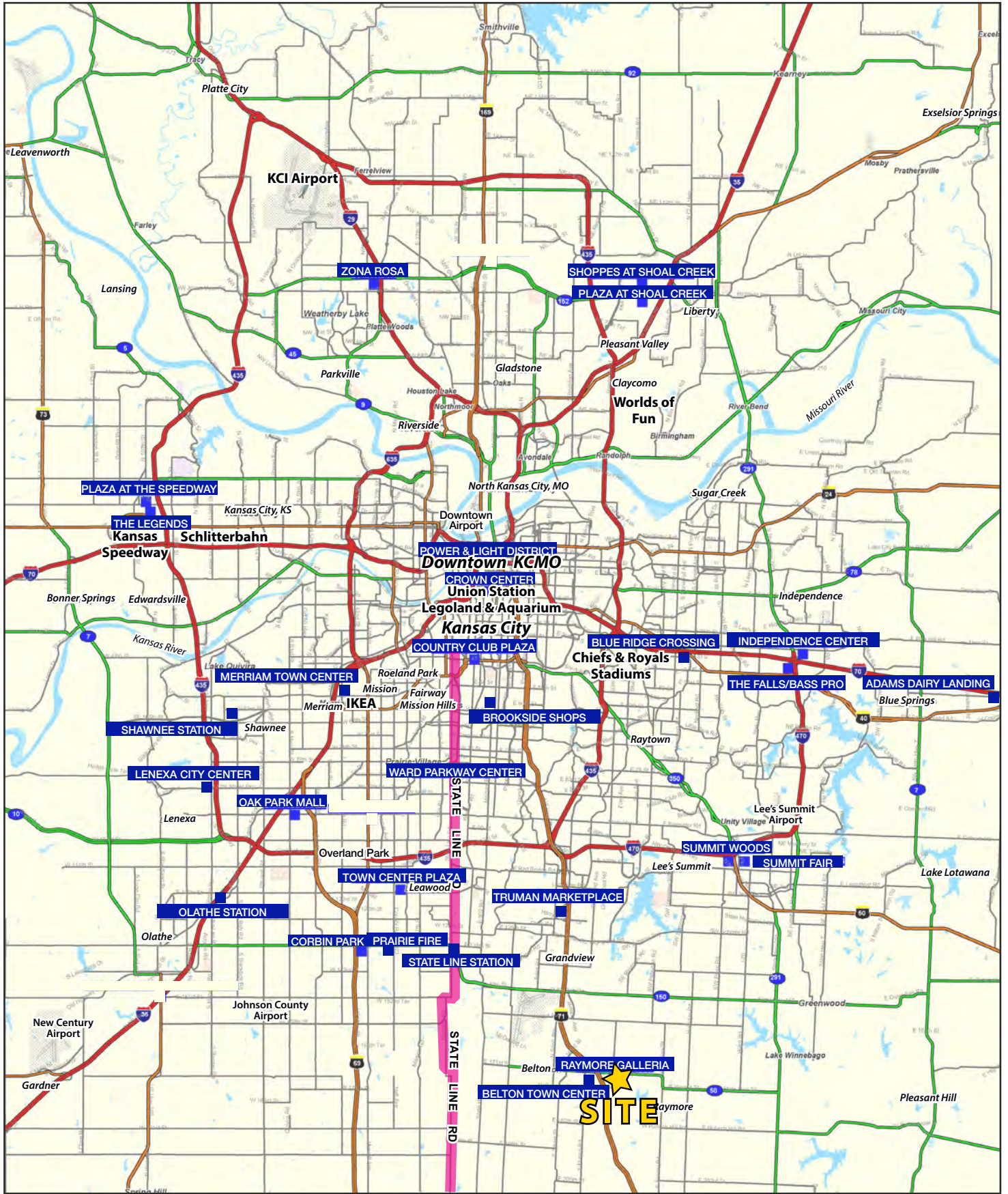



# Raymore Galleria Shops | 100% Occupied

## NNN LEASE REAL ESTATE INVESTMENT SALE

301-315 N. Dean Avenue, Raymore, MO | A Kansas City Suburb

### 5-10-15 MINUTE DRIVE TIME MAP

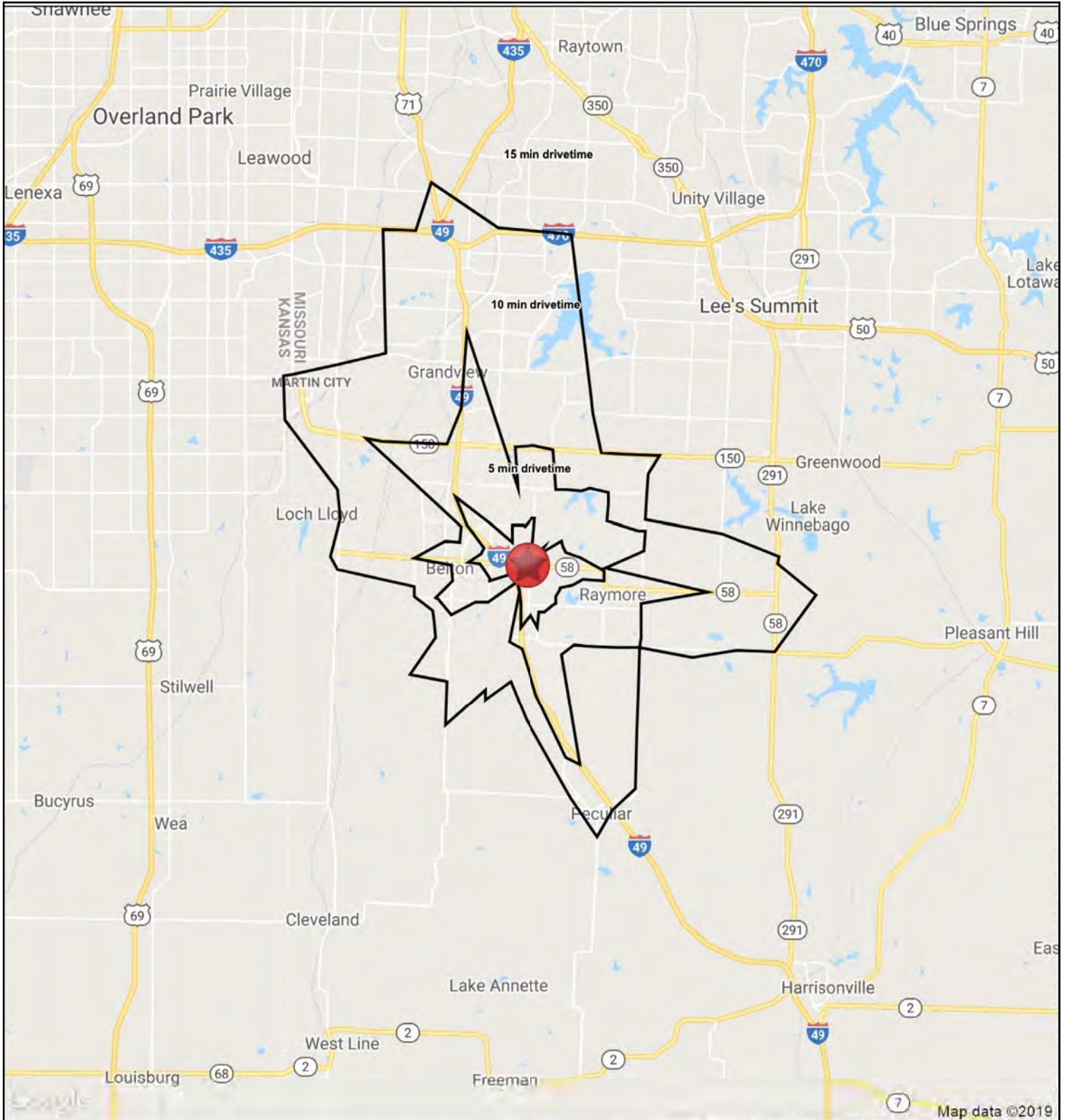



# Raymore Galleria Shops | 100% Occupied

## NNN LEASE REAL ESTATE INVESTMENT SALE

301-315 N. Dean Avenue, Raymore, MO | A Kansas City Suburb

### 5-10-15 MINUTE DRIVE TIME DEMOS

RS1

58 Highway & Dean Avenue		5 min drivetime	10 min drivetime	15 min drivetime
Belton, MO 64012				
POPULATION	2019 Estimated Population	7,443	42,459	99,463
	2024 Projected Population	7,792	44,225	103,057
	2010 Census Population	6,717	39,434	95,785
	2000 Census Population	4,379	29,713	86,109
	Projected Annual Growth 2019 to 2024	0.9%	0.8%	0.7%
	Historical Annual Growth 2000 to 2019	3.7%	2.3%	0.8%
	2019 Median Age	37.3	36.2	35.8
HOUSEHOLDS	2019 Estimated Households	3,019	16,883	39,915
	2024 Projected Households	3,148	17,468	41,045
	2010 Census Households	2,582	14,794	36,405
	2000 Census Households	1,663	11,030	32,591
	Projected Annual Growth 2019 to 2024	0.9%	0.7%	0.6%
	Historical Annual Growth 2000 to 2019	4.3%	2.8%	1.2%
RACE AND ETHNICITY	2019 Estimated White	82.8%	76.0%	65.0%
	2019 Estimated Black or African American	9.6%	15.1%	26.0%
	2019 Estimated Asian or Pacific Islander	1.7%	1.5%	1.4%
	2019 Estimated American Indian or Native Alaskan	0.5%	0.6%	0.5%
	2019 Estimated Other Races	5.4%	6.7%	7.1%
	2019 Estimated Hispanic	7.1%	7.5%	7.6%
INCOME	2019 Estimated Average Household Income	\$73,999	\$78,137	\$69,617
	2019 Estimated Median Household Income	\$75,541	\$73,565	\$63,647
	2019 Estimated Per Capita Income	\$30,042	\$31,104	\$27,988
EDUCATION (AGE 25+)	2019 Estimated Elementary (Grade Level 0 to 8)	1.5%	1.9%	2.2%
	2019 Estimated Some High School (Grade Level 9 to 11)	6.8%	5.3%	6.0%
	2019 Estimated High School Graduate	31.1%	30.2%	32.1%
	2019 Estimated Some College	25.9%	25.8%	26.8%
	2019 Estimated Associates Degree Only	7.8%	7.7%	8.0%
	2019 Estimated Bachelors Degree Only	17.2%	17.6%	15.7%
	2019 Estimated Graduate Degree	9.7%	11.5%	9.2%
BUSINESS	2019 Estimated Total Businesses	458	1,109	3,044
	2019 Estimated Total Employees	5,231	11,470	40,863
	2019 Estimated Employee Population per Business	11.4	10.3	13.4
	2019 Estimated Residential Population per Business	16.2	38.3	32.7







# Raymore Galleria Shops | 100% Occupied

## NNN LEASE REAL ESTATE INVESTMENT SALE

301-315 N. Dean Avenue, Raymore, MO | A Kansas City Suburb

### 1-3-5 MILE RADIUS RING MAP

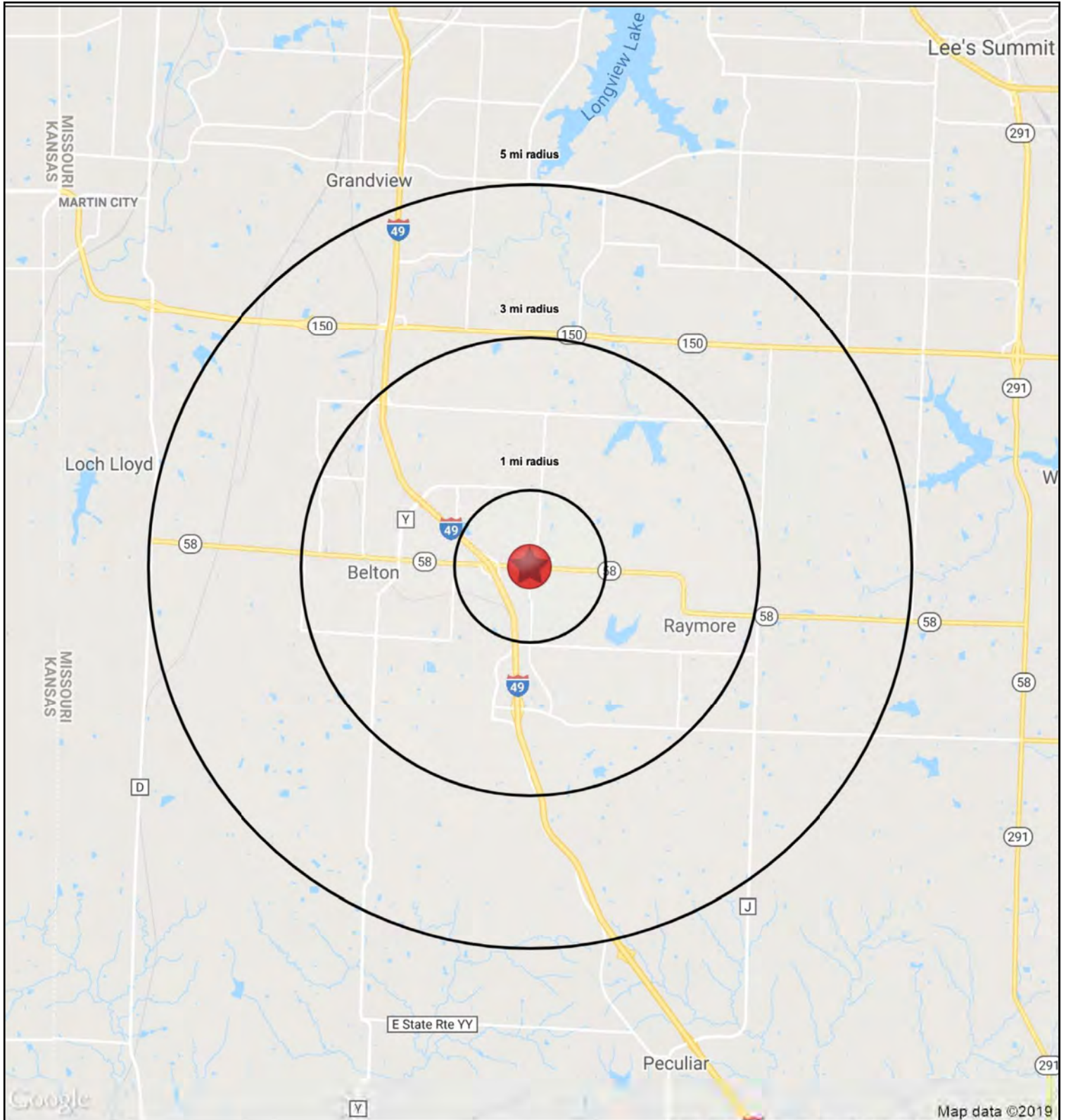



# Raymore Galleria Shops | 100% Occupied

## NNN LEASE REAL ESTATE INVESTMENT SALE

301-315 N. Dean Avenue, Raymore, MO | A Kansas City Suburb

### 1-3-5 MILE RADIUS RING DEMOS

RS1

58 Highway & Dean Avenue		1 mi radius	3 mi radius	5 mi radius
Belton, MO 64012				
POPULATION	2019 Estimated Population	7,042	44,716	62,010
	2024 Projected Population	7,365	46,923	64,927
	2010 Census Population	6,155	41,539	58,654
	2000 Census Population	3,936	32,009	47,820
	Projected Annual Growth 2019 to 2024	0.9%	1.0%	0.9%
	Historical Annual Growth 2000 to 2019	4.2%	2.1%	1.6%
	2019 Median Age	37.9	37.0	36.7
HOUSEHOLDS	2019 Estimated Households	2,888	17,811	24,473
	2024 Projected Households	3,008	18,579	25,464
	2010 Census Households	2,396	15,621	21,868
	2000 Census Households	1,550	11,905	17,556
	Projected Annual Growth 2019 to 2024	0.8%	0.9%	0.8%
	Historical Annual Growth 2000 to 2019	4.5%	2.6%	2.1%
RACE AND ETHNICITY	2019 Estimated White	82.5%	83.0%	78.6%
	2019 Estimated Black or African American	9.8%	8.5%	12.6%
	2019 Estimated Asian or Pacific Islander	1.9%	1.5%	1.4%
	2019 Estimated American Indian or Native Alaskan	0.4%	0.6%	0.6%
	2019 Estimated Other Races	5.4%	6.4%	6.8%
	2019 Estimated Hispanic	7.3%	7.3%	7.6%
INCOME	2019 Estimated Average Household Income	\$72,815	\$80,469	\$79,177
	2019 Estimated Median Household Income	\$75,320	\$75,772	\$74,209
	2019 Estimated Per Capita Income	\$29,892	\$32,096	\$31,302
EDUCATION (AGE 25+)	2019 Estimated Elementary (Grade Level 0 to 8)	1.4%	1.8%	1.9%
	2019 Estimated Some High School (Grade Level 9 to 11)	7.1%	5.0%	4.9%
	2019 Estimated High School Graduate	29.9%	31.5%	31.4%
	2019 Estimated Some College	26.6%	26.1%	26.1%
	2019 Estimated Associates Degree Only	7.5%	7.8%	8.0%
	2019 Estimated Bachelors Degree Only	17.3%	16.9%	17.0%
	2019 Estimated Graduate Degree	10.1%	10.9%	10.8%
BUSINESS	2019 Estimated Total Businesses	312	1,229	1,516
	2019 Estimated Total Employees	3,694	12,511	19,352
	2019 Estimated Employee Population per Business	11.9	10.2	12.8
	2019 Estimated Residential Population per Business	22.6	36.4	40.9





# Raymore Galleria Shops | 100% Occupied

## NNN LEASE REAL ESTATE INVESTMENT SALE

301-315 N. Dean Avenue, Raymore, MO | A Kansas City Suburb

11,945 SF Retail  
Strip in a 400,000  
SF Power Center

### CONFIDENTIALITY AGREEMENT

The information contained in the following Marketing Brochure is proprietary and strictly confidential. It is intended to be reviewed only by the party receiving it from Block & Company Inc., Realtors and should not be made available to any other person or entity without the written consent of Block & Company Inc., Realtors. This Marketing Brochure has been prepared to provide summary, unverified information to prospective purchasers, and to establish only a preliminary level of interest in the subject property. The information contained herein is not a substitute for a thorough due diligence investigation. Block & Company Inc., Realtors has not made any investigation, and makes no warranty or representation, with respect to the income or expenses for the subject property, the future projected financial condition or business prospects of any tenant, or any tenant's plans or intentions to continue its occupancy of the subject property. The information contained in the Marketing Brochure has been obtained from sources we believe to be reliable; however, Block & Company Inc., Realtors has not verified, and will not verify any of the information contained herein, nor has Block & Company Inc., Realtors conducted any investigation regarding these matters and makes no warranty or representation whatsoever regarding the accuracy or completeness of the information provided. All potential buyers must take appropriate measures to verify all of the information set forth herein.

### NON-ENDORSEMENT NOTICE

Block and Company Inc. is not affiliated with, sponsored by, or endorsed by any commercial tenant or lessee identified in this marketing package. The presence of any corporation's logo or name is not intended to indicate or imply affiliation with, or sponsorship or endorsement by, said corporation of Block & Company Inc., Realtors its affiliates or subsidiaries, or any agent, product, service, or commercial listing of Block and Company Inc., and is solely included for the purpose of providing tenant lessee information about this listing to prospective customers.

