

FOR LEASE

140 Congress Blvd | Duncan, SC 29334



Unit B | \$7.50/SF NNN

- ±2,455 SF warehouse space & ±1,145 SF office space
- 1 Dock door
- 24' to 27' Clear ceiling height
- Fully sprinklered
- Metal Halide lights
- ± 0.8 mile to Interstate 85 (Exit 63)
- ± 8 miles to GSP International Airport
- ± 9 miles to SC Inland Port

Demographics	1 Mile	3 Miles	5 Miles
Total Population:	2,049	13,271	31,766
Average HH Income:	\$68,173	\$61,746	\$60,485

No Warranty Or Representation, Express Or Implied, Is Made As To The Accuracy Of The Information Contained Herein, And The Same Is Submitted Subject To Errors, Omissions, Change Of Price, Rental Or Other Conditions, Prior Sale, Lease Or Financing, Or Withdrawal Without Notice, And Of Any Special Listing Conditions Imposed By Our Principals No Warranties Or Representations Are Made As To The Condition Of The Property Or Any Hazards Contained Therein Are Any To Be Implied.

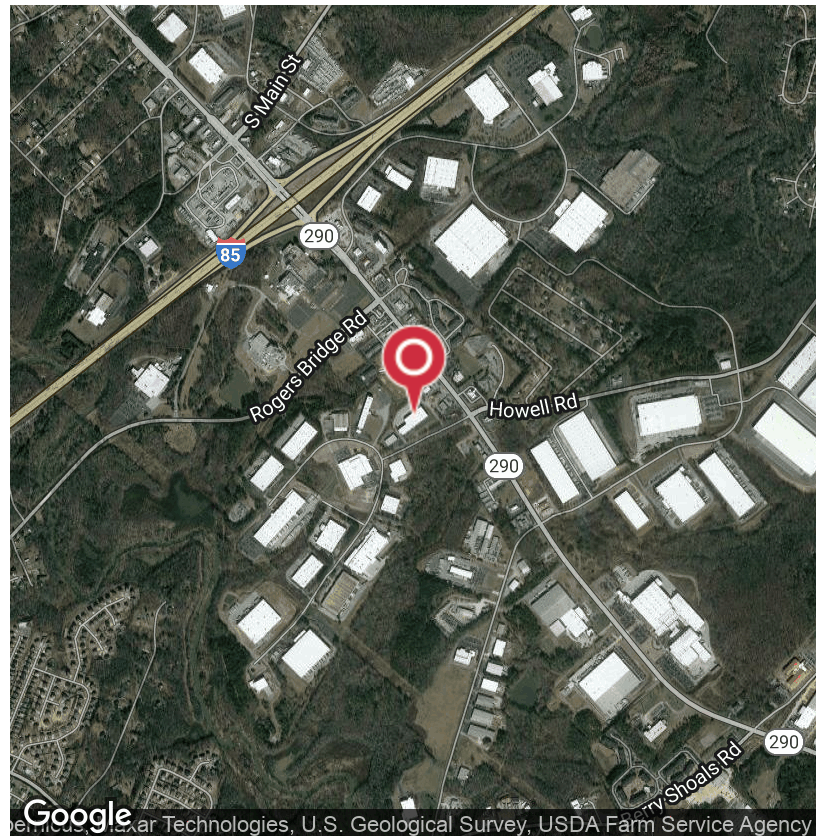

✉ **Will Coker**
O: +1 864 680 0526
wcoker@naiearlefurman.com

✉ **Clay Williams, SIOR**
O: +1 864 678 5938
C: +1 864 706 7622
clay@naiearlefurman.com

✉ **Grice Hunt, SIOR**
O: +1 864 678 5935
C: +1 864 346 7611
grice@naiearlefurman.com

📍 **101 E Washington St**
Greenville, SC 29601
naiearlefurman.com

Aerial & Floor Plan

140 Congress Blvd | Duncan, SC

NAI Earle Furman

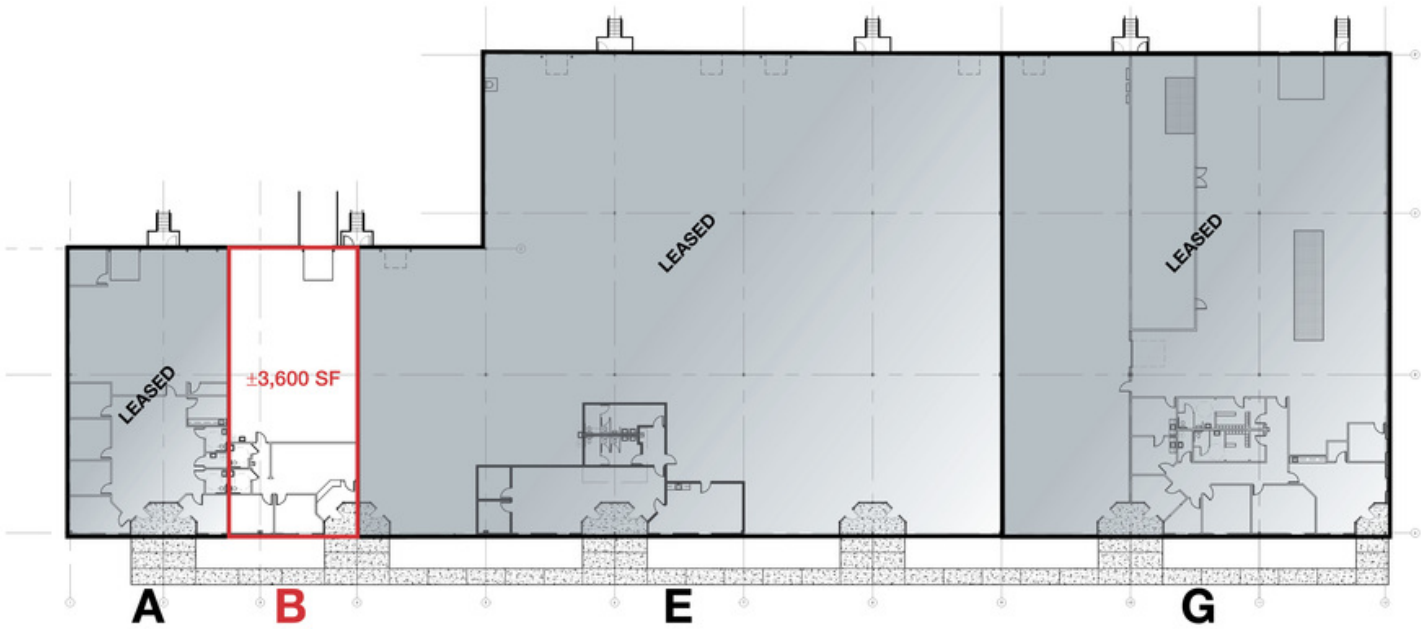

140 Congress Blvd, Duncan, SC

±53,700 Total SF

✉ Will Coker
O: +1 864 680 0526
wcoker@naiearlefurman.com

✉ Clay Williams, SIOR
O: +1 864 678 5938
C: +1 864 706 7622
clay@naiearlefurman.com

✉ Grice Hunt, SIOR
O: +1 864 678 5935
C: +1 864 346 7611
grice@naiearlefurman.com

📍 101 E Washington St
Greenville, SC 29601
naiearlefurman.com

Property Photos

140 Congress Blvd | Duncan, SC

