

FOR LEASE

# CENTER PLAZA

2620 Williamson Place / Building 2, Suite 129  
DuPont, WA 98327



## PRIME WAREHOUSE/FLEX SPACE

- + Available June 1, 2020
- + 2,976 SF total SF available
  - 1,820 SF warehouse
  - 1,156 SF office
- + Lease rate: \$0.75 shell / \$0.95 office
- + Corporate image with high quality finishes
- + One mile from Interstate 5 (Exit 119)
- + Immediate access to Joint Base Lewis McChord (JBLM)
- + 21' clear height
- + 3-phase power
- + 14' x 12' grade-level loading
- + Abundant parking



OWNED & OPERATED BY:



# SITE PLAN & LOCATION MAP

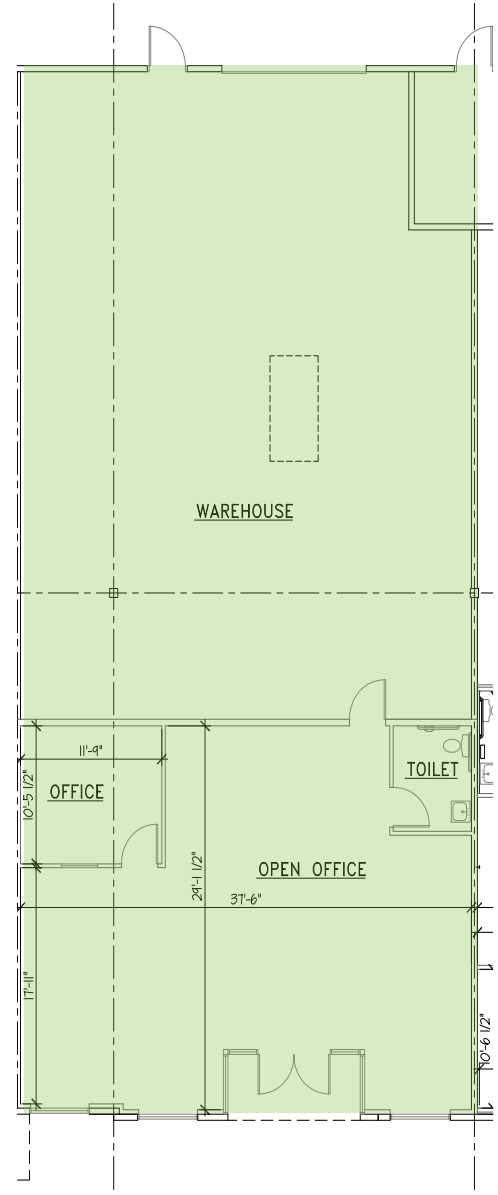

## MONTE DECKER

Senior Vice President  
 +1 253 596 0041  
 monte.decker@cbre.com

## CHRIS COWLES

Senior Associate  
 +1 253 596 0048  
 chris.cowles@cbre.com

## CBRE, INC.

1201 Pacific Avenue  
 Suite 1502  
 Tacoma, WA 98402

© 2019 CBRE, Inc. All rights reserved. This information has been obtained from sources believed reliable, but has not been verified for accuracy or completeness. You should conduct a careful, independent investigation of the property and verify all information. Any reliance on this information is solely at your own risk. CBRE and the CBRE logo are service marks of CBRE, Inc. All other marks displayed on this document are the property of their respective owners, and the use of such logos does not imply any affiliation with or endorsement of CBRE. Photos herein are the property of their respective owners. Use of these images without the express written consent of the owner is prohibited. RB 06.02.20