



Available for Lease

±4,855 - ±10,000 SF

Zehnder Industrial Complex

Elk Grove, CA

9731 & 9735 Dino Drive | Elk Grove, CA

Description

Complex located at Waterman Road at Dino Drive, North of Grant Line Road in the desirable Elk Grove submarket.

This project offers a variety of floor plans. Location provides great access to Highway 99 and is conveniently located near several new housing communities and food services.

Property Features

- Up to ± 10,000 SF contiguous
- Monitored Fire Sprinklers
- Overhead Doors
- Three Phase Power
- LI Zoning



For further information please contact us at (916) 381-8113 or jacksonprop.com

Broker participation is invited.

The information herein is provided from reliable sources; however, Jackson Properties, Inc. assumes no liability for accuracy. The individual broker or user should confirm the physical information for themselves. Prices subject to change without notice.

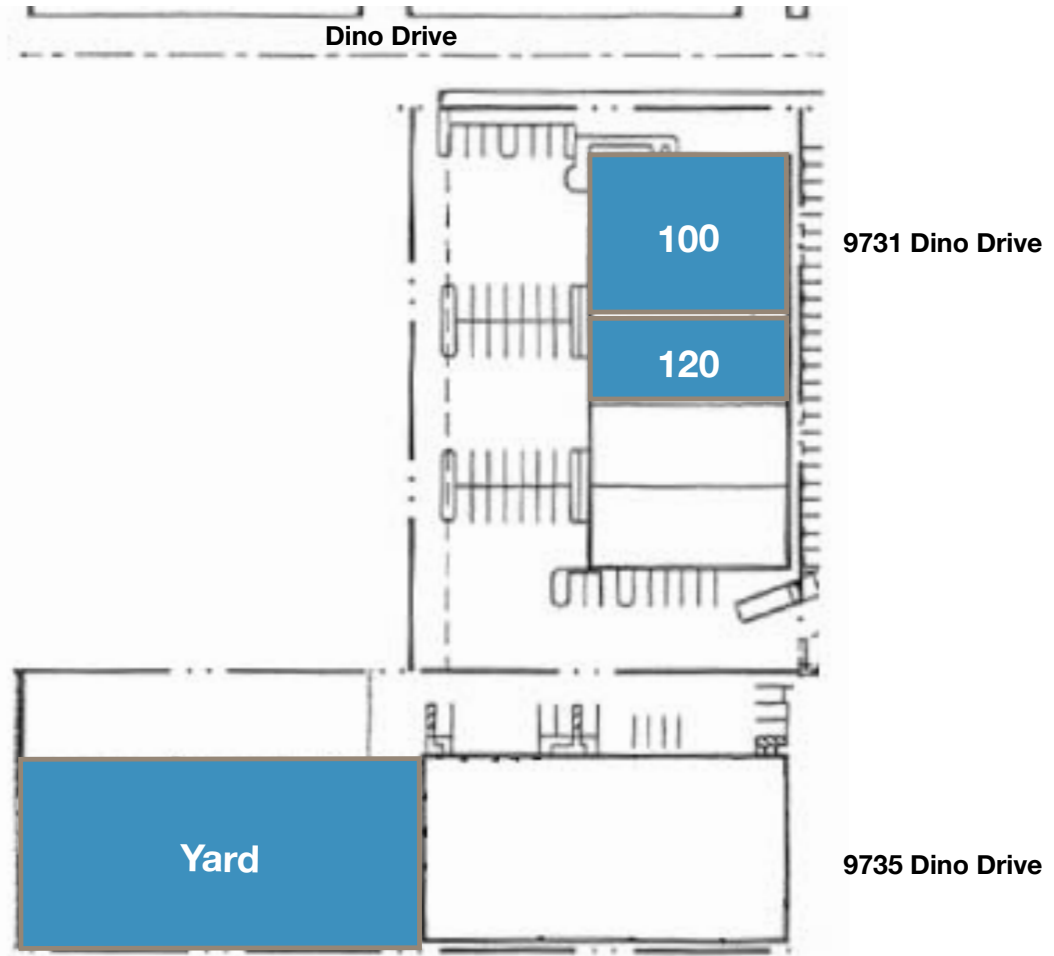

9731 & 9735 Dino Drive

Elk Grove, CA

Available Units	Total SF	Warehouse	Office	Monthly Rent
9731 Dino Drive, Suite 120	±4,855 SF	±4,415 SF	±440 SF	\$2,915.00 NNN
9731 Dino Drive, Suite 100	±9,710 SF	±7,773 SF	±1,937 SF	\$5,825.00 NNN
9735 Dino Drive, Yard Space	±13,500 SF	None	None	\$1,755.00 NNN



JACKSON
PROPERTIES, INC.

For further information please contact us at (916) 381-8113 or jacksonprop.com

Broker participation is invited.

The information herein is provided from reliable sources; however, Jackson Properties, Inc. assumes no liability for accuracy. The individual broker or user should confirm the physical information for themselves. Prices subject to change without notice. Disclaimer for 3-5 lease rate.



Elk Grove Industrial

9731 & 9735 Dino Drive | Elk Grove, CA



JACKSON
PROPERTIES, INC.

For further information please contact us at (916) 381-8113 or jacksonprop.com

9731 Dino Drive, Elk Grove

Suite 120 ±4,855 SF w/440 SF Office

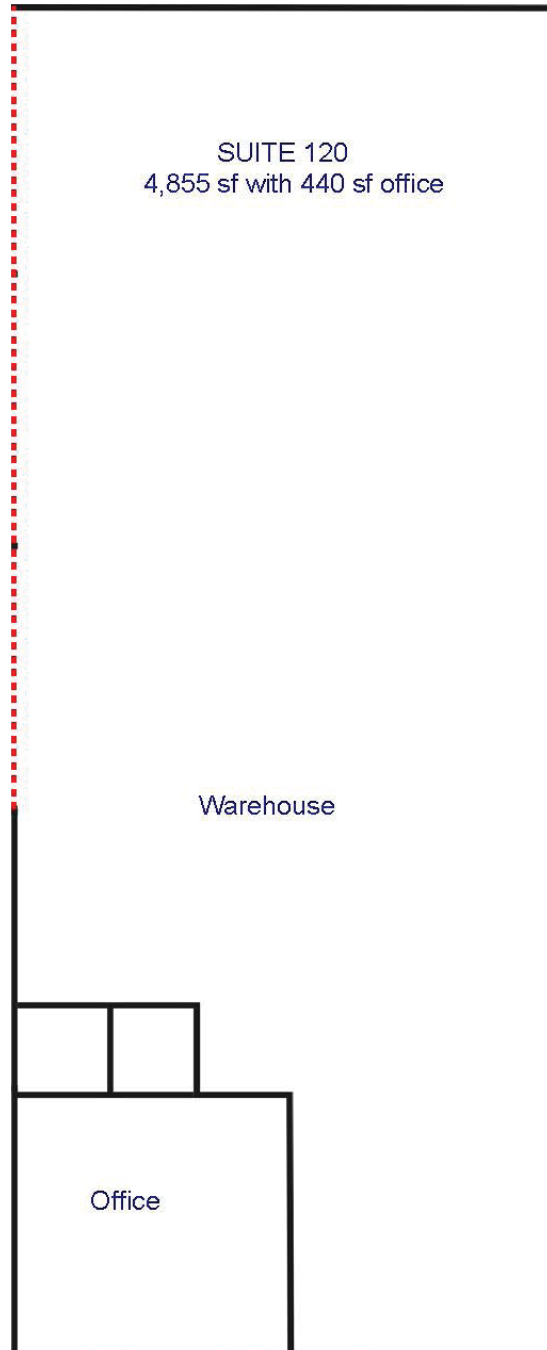

JACKSON
PROPERTIES, INC.

For further information please contact us at (916) 381-8113 or jacksonprop.com

Disclaimer: For reference only. Not to scale.

9731 Dino Drive, Elk Grove

Suite 100 ±9,710 SF w/1,937 SF Office

