

15 E. CENTER STREET
PETERSBURG, MICHIGAN

RETAIL FOR SALE
2,598 Square Feet Available



**SIGNATURE
ASSOCIATES**
KNOW SIGNATURE | KNOW RESULTS

BANK BUILDING



PROPERTY FEATURES

- 2,598 available square feet
- Zoned C-1
- 11 parking spaces
- 0.43 acre
- Sale Price: \$564,000 (\$217.09/sq.ft.)

Comments: Former bank branch with drive-thru. Deed restriction for 5 years against bank or credit union use.

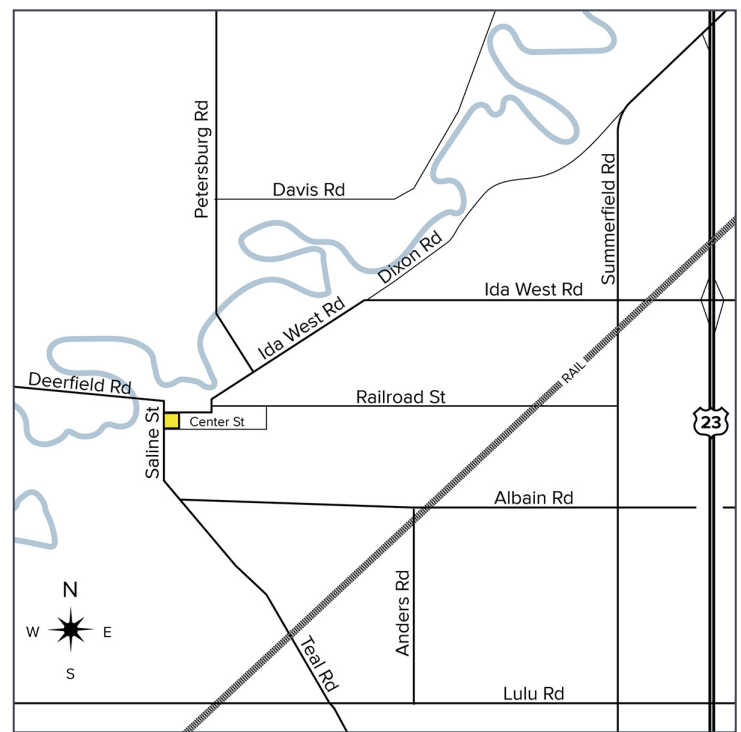

For more information, please contact:

JEFFREY TREPECK
(248) 359 0626
jtrepeck@signatureassociates.com

SIGNATURE ASSOCIATES
One Towne Square, Suite 1200
Southfield, MI 48076
www.signatureassociates.com

15 E. Center Street – Petersburg, Michigan

Retail For Sale

2,598
Square Feet
AVAILABLE

DEMOGRAPHICS

	POPULATION	MED. HH INCOME
1 MILE	1,414	\$52,833
3 MILE	2,971	\$67,621
5 MILE	10,389	\$70.643

TRAFFIC COUNTS (TWO-WAY)

6,665	Center St. & Wood St.
1,243	Saline St. & Center St.
1,808	Railroad St. & Saline St.
6,675	Pahl Mall St. E. of Saline St.



For more information, please contact:

JEFFREY TREPECK
(248) 359 0626
jtrepeck@signatureassociates.com

SIGNATURE ASSOCIATES
One Towne Square, Suite 1200
Southfield, MI 48076
www.signatureassociates.com

15 E. Center Street – Petersburg, Michigan

Retail For Sale

2,598
Square Feet
AVAILABLE

Site Plan

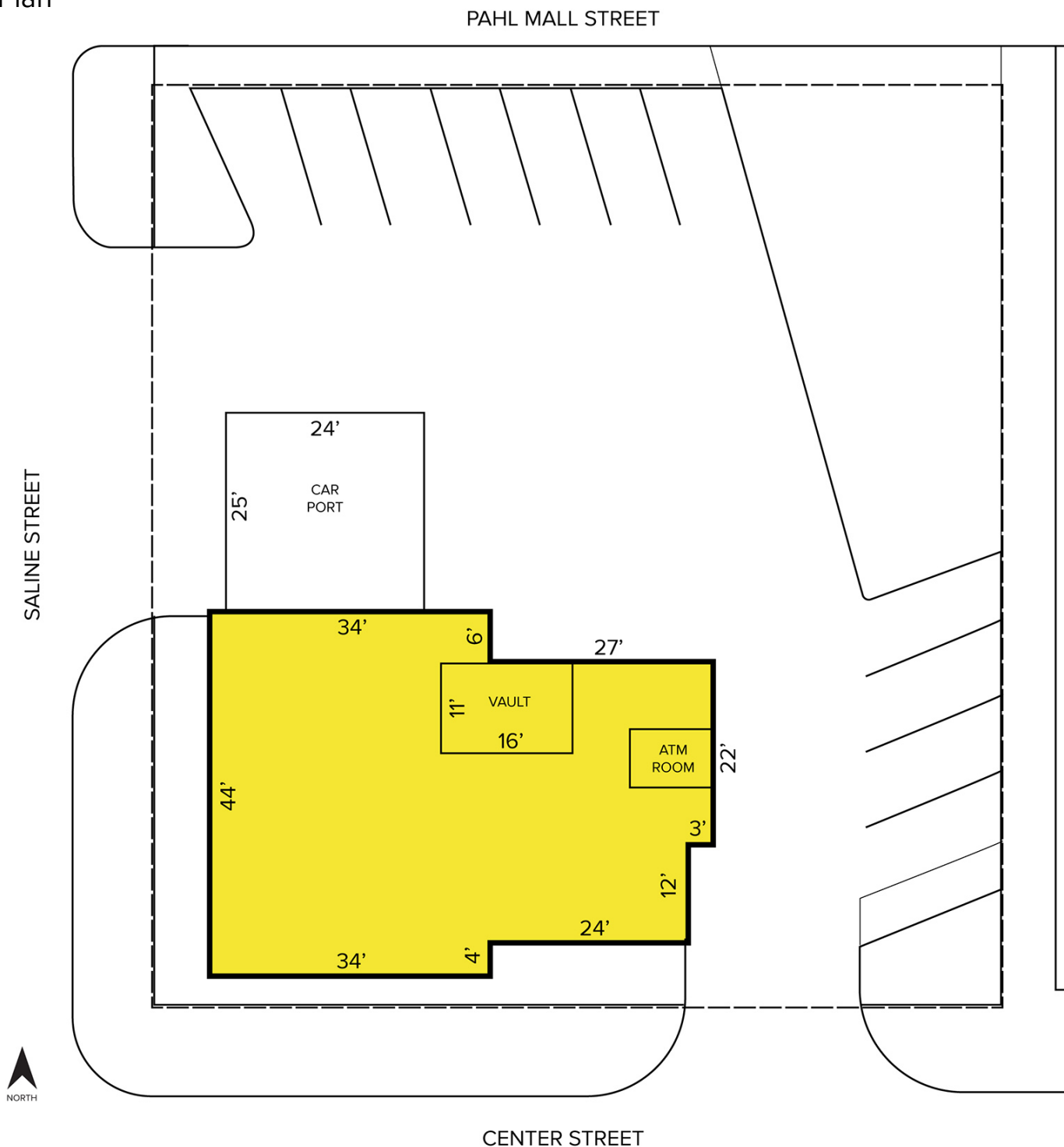

For more information, please contact:

JEFFREY TREPECK
(248) 359 0626
jtrepeck@signatureassociates.com

SIGNATURE ASSOCIATES
One Towne Square, Suite 1200
Southfield, MI 48076
www.signatureassociates.com