

Commercial Lease
4699253
Active

17 Farmington Road
Rochester NH 03867

Unit/Lot #:

\$1,500.00 \$ / Monthly
Price-Leased
Date - Leased

FOR LEASE Route 11 Plaza 17 Farmington Road, Rochester, NH. Retail Store 900 sq ft. Prime location, Traffic Count 24,000 VPD, Weekends 32,000 VPD

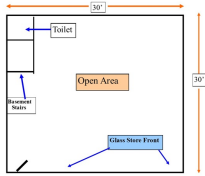

Rent: \$1,000 per month
 Tenant Pays: Utilities
 Landlord Pays: Taxes, Insurance & Snow removal

\$0

Lease Term
Lease/Sublease Lease
Road Front/Lgth Yes /
Constrctn Status
SqFt-TotBld/Src /
SqFt-TotAvail/Src
Sub Property Type Office, Retail
Sub Prop Type Use
DOM 46
Directions

Lease Type Modified Gross
Year Built 1986
Flood Zone No
Zoning GRD
Lot Acres/SqFt /
Traffic Count

Virtual Tours

STRUCTURE

Building # / **Units Per Building** / **Total Stories**
Divisible SqFt Min/Max / **Basement/Access Type** Yes / Interior
Foundation / **Basement Description** Concrete
Roof / **Construction**
Exterior Metal
Total Drive-in Doors / **Door Height**
Total Loading Docks / **Dock Height** / **Dock Levelers**
Ceiling Height / **Total Elevators**

UTILITIES

Heating / **Services**
Heat Fuel
Gas - Natural Available / **Management Co/Phone** /
Cooling / **Fuel Company**
Water Public / **Phone Company**
Sewer Public Sewer On-Site / **Cable Company**
Electric / **Electric Company**

LOT / LOCATION

County Strafford / **Submarket**
Water Body Access / **Project Building Name**
Water Body Type / **ROW - Parcel Access**
Water Body Name / **ROW - Length/Width** /
Water Frontage Length / **ROW to other Parcel**
Water Restrictions / **Surveyed / By**
Lot Description / **Area Description**

Air Conditioning %		Sprinkler	
Railroad Avail/Provider	/	Signage	
Green Verification Progm		Green Verification Rating/Metric	/
Green Verification Body		Green Verification New Construction	
Green Verification Status/Year	/	Green Verification URL	

DISCLOSURES

Listing Service	Full Service	Tenant Pays
Comp Only/Type	No /	
Seasonal	No	Negotiable
Delayed Showing/Begin Date	N /	

PREPARED BY

Peter Russell - Cell: 603-498-3627

prussell411@gmail.com

Peter Russell & Associates - Off: 603-431-2316

500 Market Street, Suite 15L
Portsmouth NH 03801

