

2551-2555 Broadway

UPPER WEST SIDE
NEW YORK, NY



Property Details

Location

Southwest corner of Broadway and West 96th Street

Approximate Size

Ground Floor	
Space A	1,844 SF
Space B	1,230 SF
Total	3,074 SF

Frontage

Space A	40 FT
Space B	25 FT

Ceiling heights

13 FT 10 IN

Possession

Arranged

Site Status

New Condominium Development

Comments

Spaces can be combined

Located at the base of a newly built, 144-unit luxury condominium building

Adjacent to the 96th Street **1 2 3** subway station, servicing approximately 11,700,000 riders annually

Ground Floor

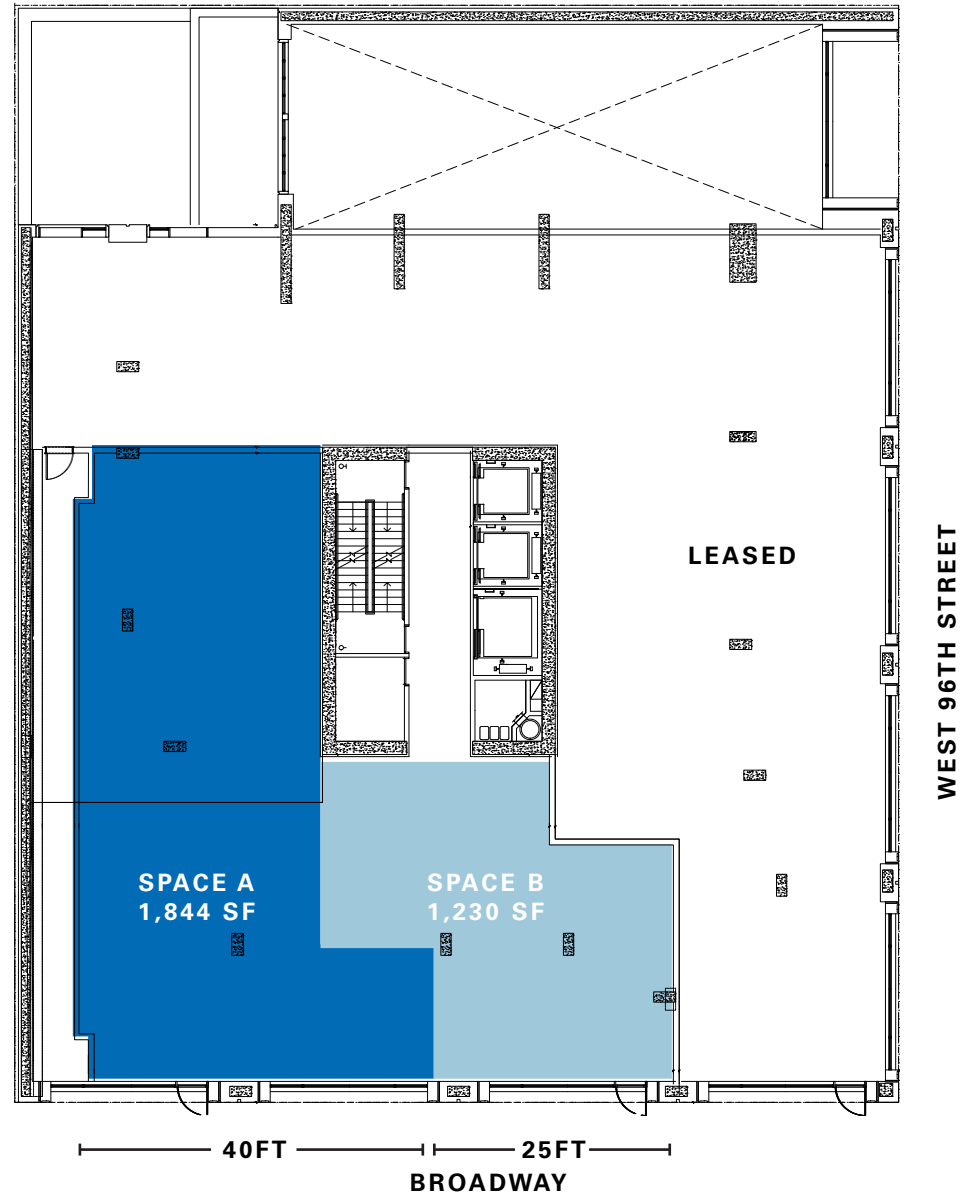

2551-2555 BROADWAY

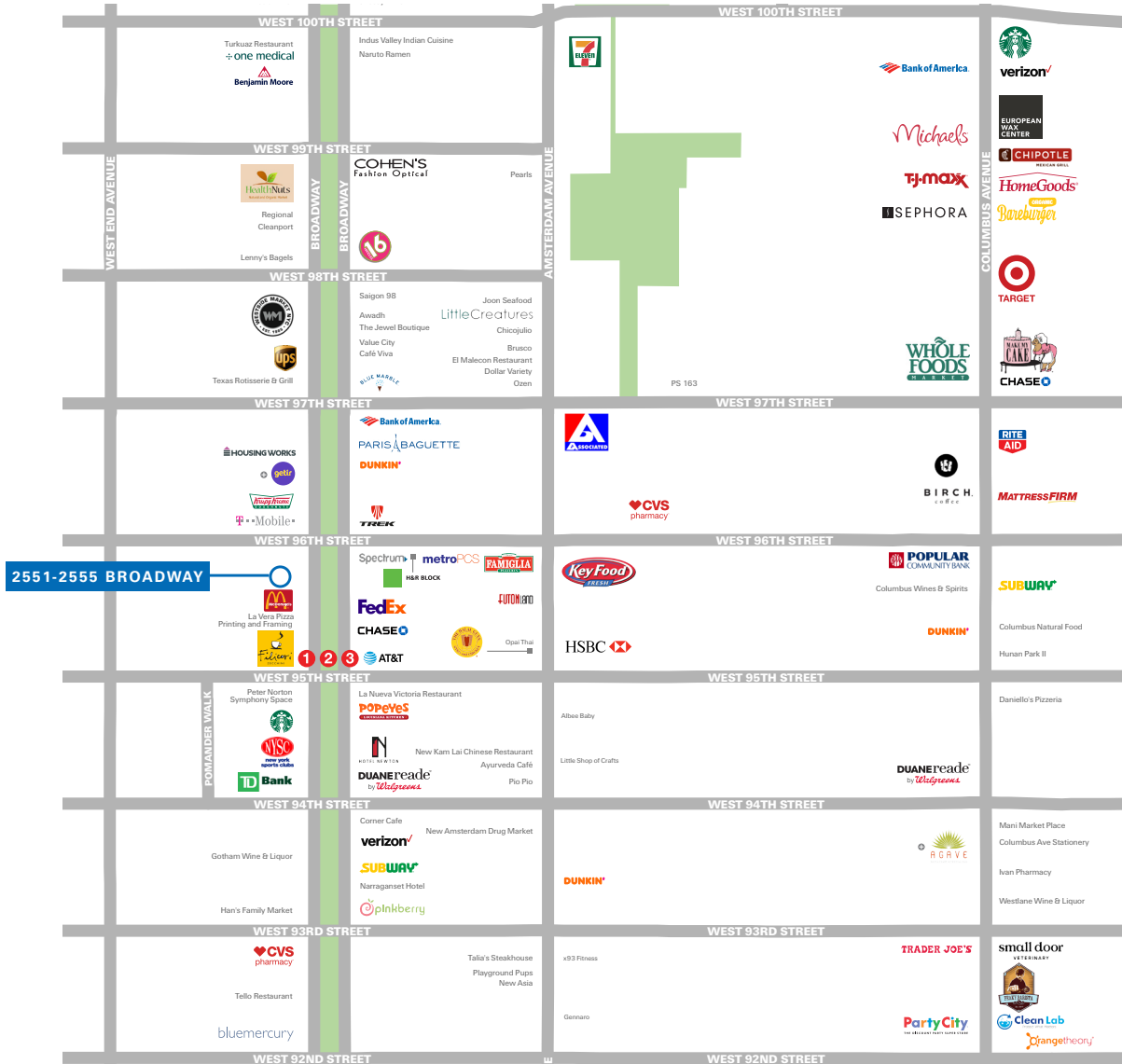

CONTACT

Benjamin Birnbaum

t 212-850-5474

benjamin.birnbaum@nmrk.com

Ariel Schuster

t 212-331-0132

ariel.schuster@nmrk.com

Gabriel Staab

t 212-372-2053

gabriel.staab@nmrk.com

nmrk.com