

PRIME RETAIL SPACE ADJACENT TO KOHL'S

Boynton Beach, FL 33426 | 1901 N Congress Ave | Gateway Blvd & N Congress Ave | #1222



- 32,400 SF available
- Junior anchor space available adjacent to Kohl's
- Excellent visibility at the intersection of Congress Ave & Gateway Blvd with 68,500 vpd
- Located within Boynton Beach's primary retail trade corridor with significant critical mass in the immediate area

DEMOGRAPHICS	1 MILE	3 MILES	5 MILES	TRAFFIC COUNTS	
2018 POPULATION	16,774	125,000	262,681	Gateway Blvd	32,000 VPD
2018 DAYTIME POPULATION	16,526	105,355	219,243	N Congress Ave	36,500 VPD
2018 AVERAGE HH INCOME	\$71,109	\$70,095	\$78,419		
2018 MEDIAN HH INCOME	\$58,648	\$51,552	\$54,801		

AVAILABLE SF:
32,400 SF

FRONTAGE:
108' 9"

ZONING:
COMMERCIAL

RATES:
CALL FOR DETAILS

AREA ANCHORS:



FOR MORE INFORMATION, CONTACT EXCLUSIVE AGENT(S):
MIKE FETHERSTON • mike.fetherston@tscg.com • 305.262.8877



PRIME RETAIL SPACE ADJACENT TO KOHL'S

Boynton Beach, FL 33426 | 1901 N Congress Ave | Gateway Blvd & N Congress Ave | #1222



FOR MORE INFORMATION, CONTACT EXCLUSIVE AGENT(S):
 MIKE FETHERSTON • mike.fetherston@tscg.com • 305.262.8877

TSCG

Stan Johnson Co.
 THE NET LEASE AUTHORITY™

CHAINLINKS
 RETAIL ADVISORS

Demographics: Esri 2018 No warranty expressed or implied has been made as to the accuracy of the information provided herein, no liability assumed for error or omissions.

PRIME RETAIL SPACE ADJACENT TO KOHL'S

Boynton Beach, FL 33426 | 1901 N Congress Ave | Gateway Blvd & N Congress Ave | #1222

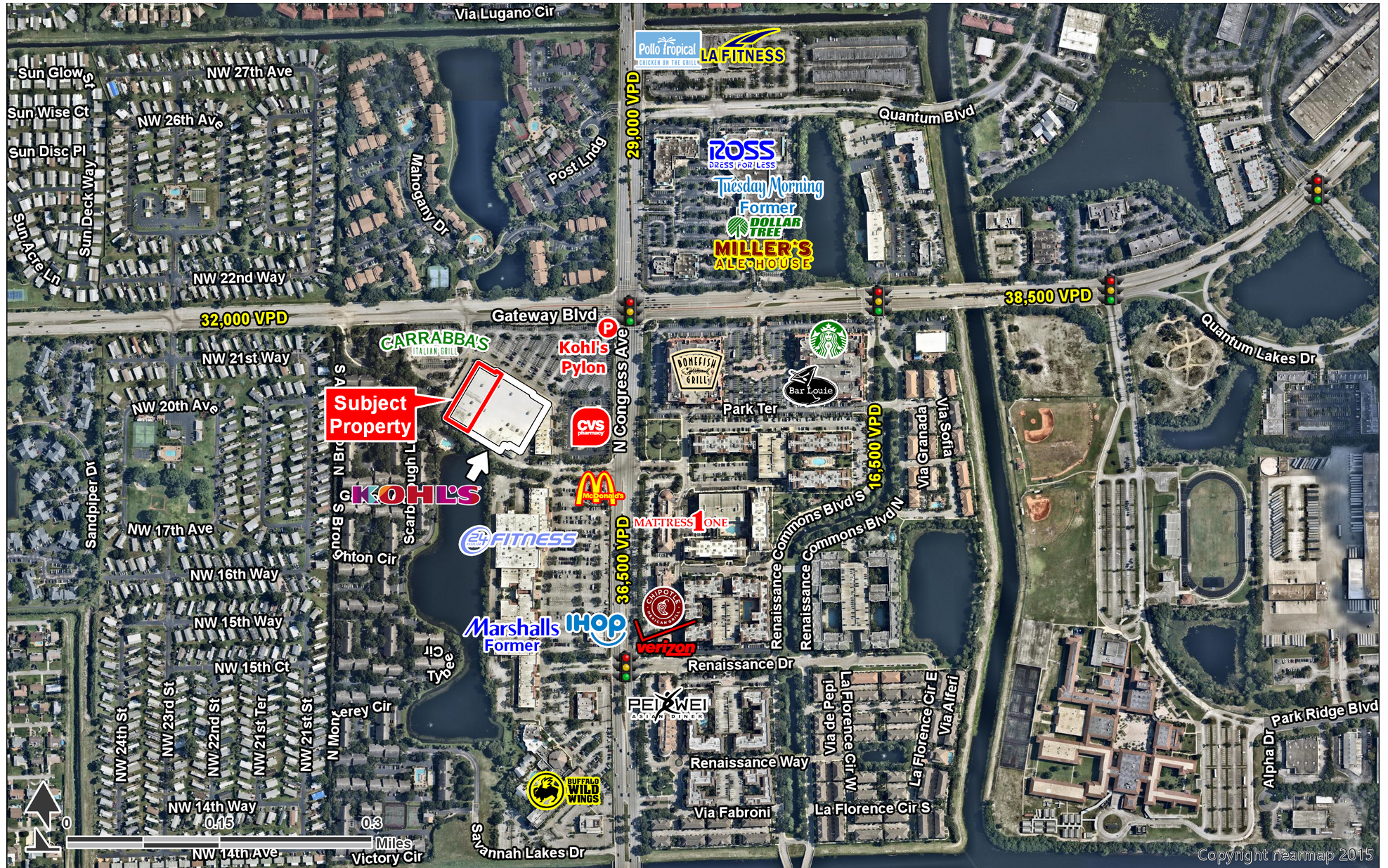

FOR MORE INFORMATION, CONTACT EXCLUSIVE AGENT(S):
 MIKE FETHERSTON • mike.fetherston@tscg.com • 305.262.8877



Demographics: Esri 2018 No warranty expressed or implied has been made as to the accuracy of the information provided herein, no liability assumed for error or omissions.

PRIME RETAIL SPACE ADJACENT TO KOHL'S

Boynton Beach, FL 33426 | 1901 N Congress Ave | Gateway Blvd & N Congress Ave | #1222

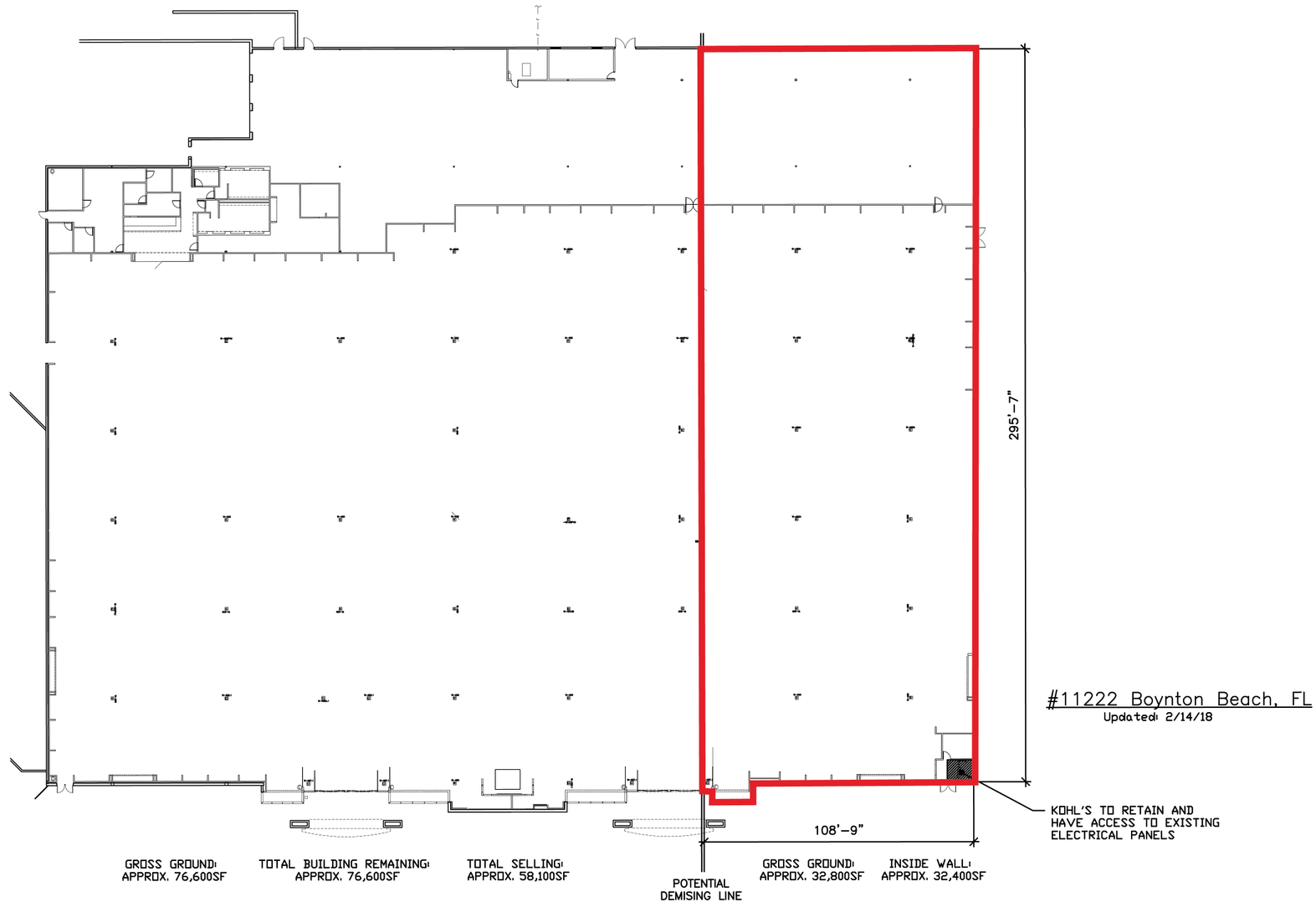

FOR MORE INFORMATION, CONTACT EXCLUSIVE AGENT(S):
MIKE FETHERSTON • mike.fetherston@tscg.com • 305.262.8877

