



## Property Highlights

- Lease Rate: \$1.00 psf, NNN
- Tenant Improvement Allowance: \$25 psf
- 5,891 sf professional office space available:
  - Suite 1- 3,021 sf
  - Suite 2- 2,870 sf
- Located in the heart of Mesquite's new commercial center
- Easy access to the hospital and freeway
- Great street visibility and access from Pioneer Blvd
- Co-tenancy with a very successful dental practice
- Custom build-outs available
- Generous tenant improvement monies available
- Free rent available

## 5,891 SF For Lease



**Travis J. Parry, SIOR, CCIM**  
Senior Director  
+1 702 688 6895  
travis.parry@cushwake.com

2 West St. George Blvd, Suite 10  
St. George, Utah 84770  
Main +1 435 673 7111  
Fax +1 435 673 7153  
**cushmanwakefield.com**



FOR LEASE

# 760 West Pioneer Blvd

Mesquite, Nevada



**Travis J. Parry, SIOR, CCIM**  
Senior Director  
+1 702 688 6895  
travis.parry@cushwake.com

2 West St. George Blvd, Suite 10  
St. George, Utah 84770  
Main +1 435 673 7111  
Fax +1 435 673 7153  
**cushmanwakefield.com**



**CUSHMAN &  
WAKEFIELD**

FOR LEASE

# 760 West Pioneer Blvd

Mesquite, Nevada

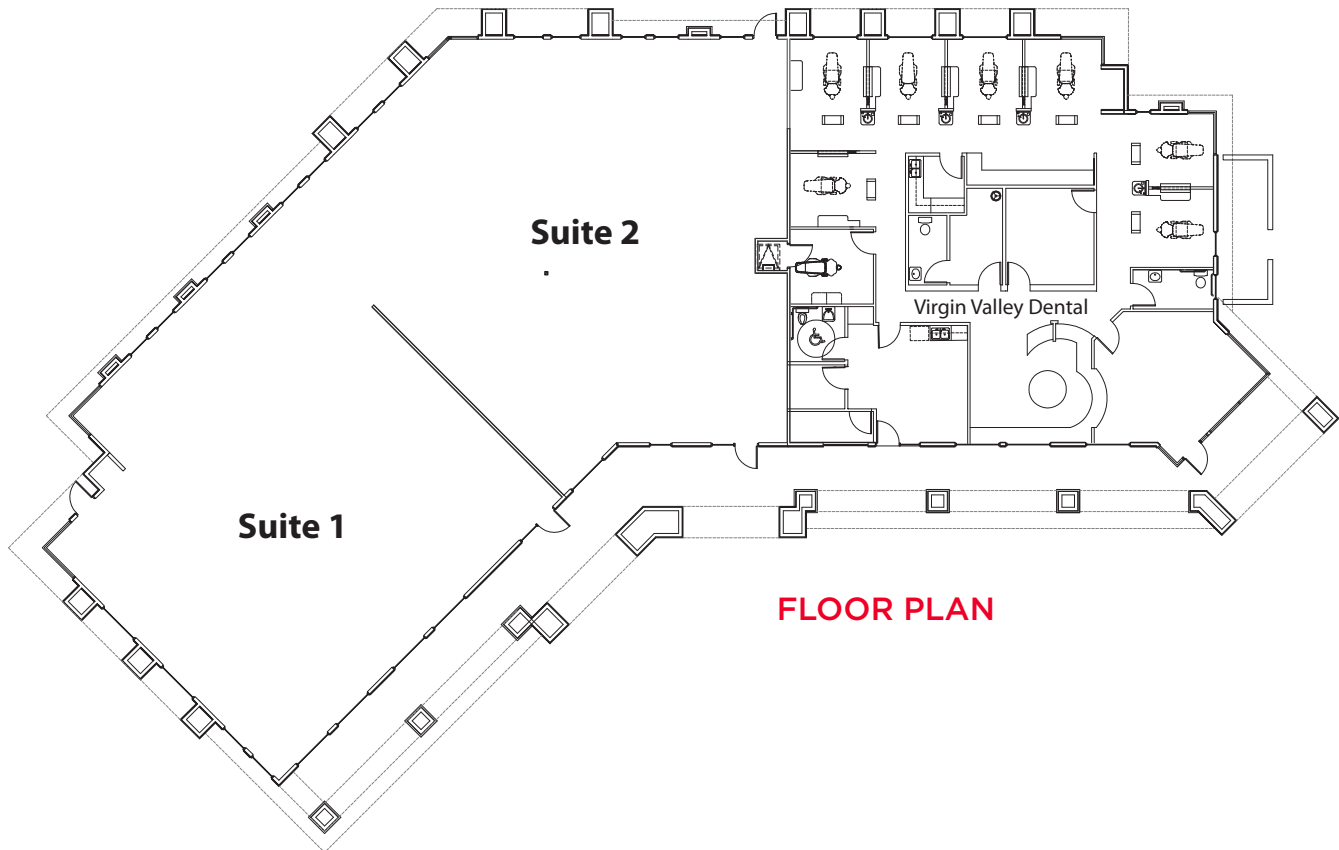

**Travis J. Parry, SIOR, CCIM**  
Senior Director  
+1 702 688 6895  
travis.parry@cushwake.com

2 West St. George Blvd, Suite 10  
St. George, Utah 84770  
Main +1 435 673 7111  
Fax +1 435 673 7153  
**cushmanwakefield.com**