



FOR LEASE 2,500 - 5,000 SQ. FT. UNITS



868 - 898 West 16th Street, Newport Beach
1600 - 1606 Monrovia Avenue, Newport Beach
1607 - 1613 Babcock Street, Newport Beach

OFFICE FEATURES

- Approximately 400 Square Feet Office Space Per Unit
- Fully Heated / Air-Conditioned
- Time Warner Business Class High Speed Internet available
- Fully Carpeted
- Two or Four Restrooms Per Unit

WAREHOUSE FEATURES

- Minimum 100 Amps of Power
* Some units with additional power
- 12 Ft. Clearance
- 10' X 10' Overhead Doors

OTHER FEATURES

- Street Front Exposure
- Close to Ocean

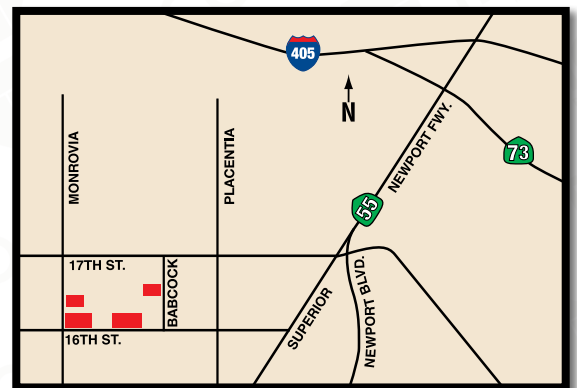

For Further Information, Please Contact:

Cindy Rowe

LICENSE 01824146

cindyrowe@tricoREALTY.com

(714) 751-4420

Fax (714) 540-4579

For additional TRICO listings Visit our Website @
www.TricoRealty.com

Trico Realty, Inc. 3100-A Pullman Street, Costa Mesa, CA 92626 • (714) 751-4420 • Fax (714) 540-4579

This information has been furnished from sources which we deem reliable; however, we do not guarantee its accuracy and assume no liability. Do not rely on any of the information contained herein without verifying it yourself, directly with the listing broker or owner.

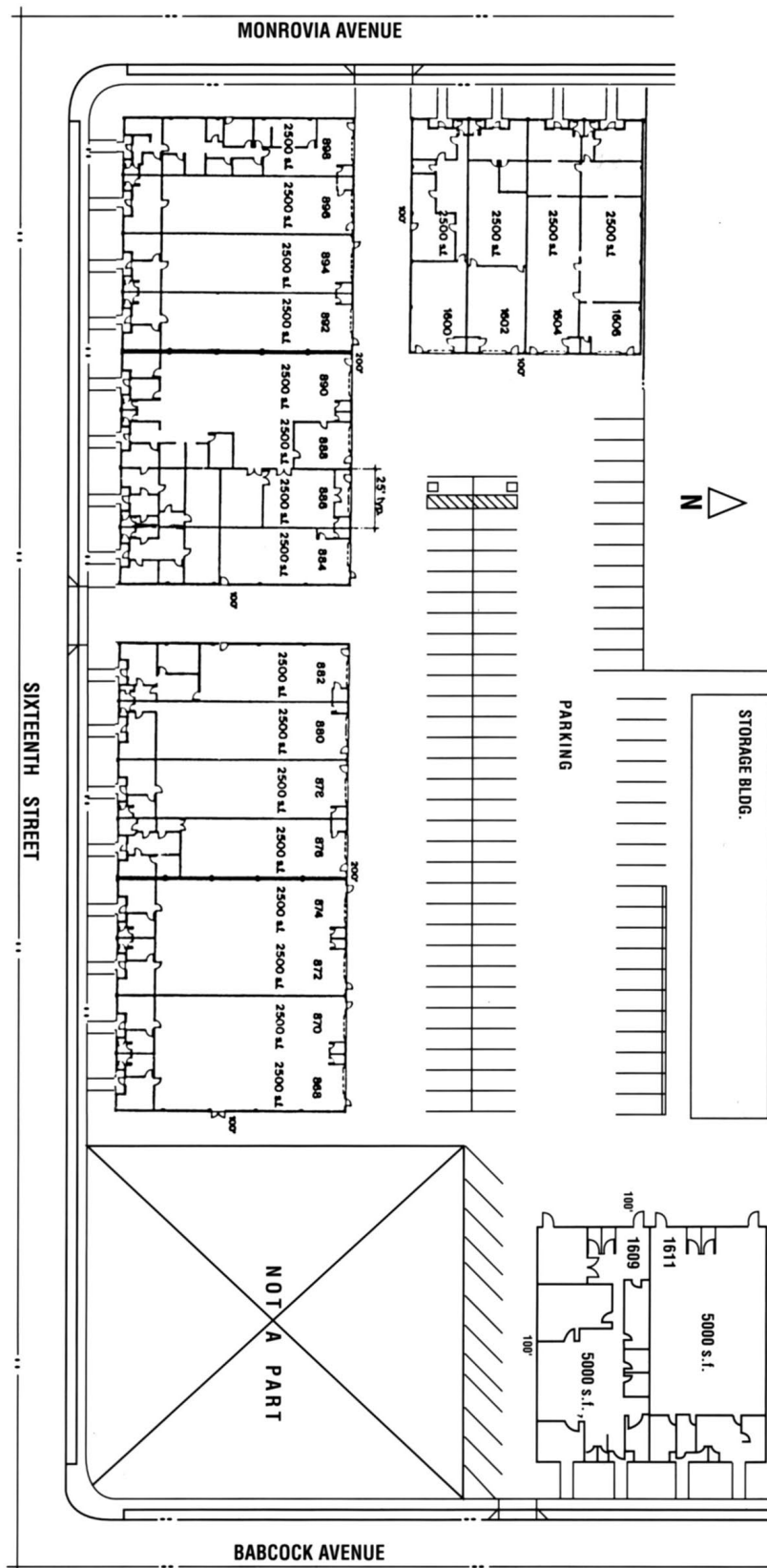

For Further Information, Please Contact:

Cindy Rowe

LICENSE 01824146

cindyrowe@tricoREALTY.com

(714) 751-4420

Fax (714) 540-4579



For additional TRICO listings Visit our Website @
www.TricoRealty.com

Trico Realty, Inc. 3100-A Pullman Street, Costa Mesa, CA 92626 • (714) 751-4420 • Fax (714) 540-4579

This information has been furnished from sources which we deem reliable; however, we do not guarantee its accuracy and assume no liability. Do not rely on any of the information contained herein without verifying it yourself, directly with the listing broker or owner.