

2830 GARNET AVENUE, PACIFIC BEACH

FOR LEASE

FUTURE MULTI-TENANT RETAIL SPACES AVAILABLE



Highlights

- Great location and visibility at corner of Garnet Ave & E. Mission Bay Dr
- High Daily Traffic Count – 31,200 Cars
- Nearby other retail and restaurant amenities
- Parking on-site
- Signage available
- Small suites available

For more information, please contact:

Lauren Suazo

858.362.1670

lsuazo@westcore.net



2830 GARNET AVENUE, PACIFIC BEACH

Approx. 1,000 – 1,200 SF Available

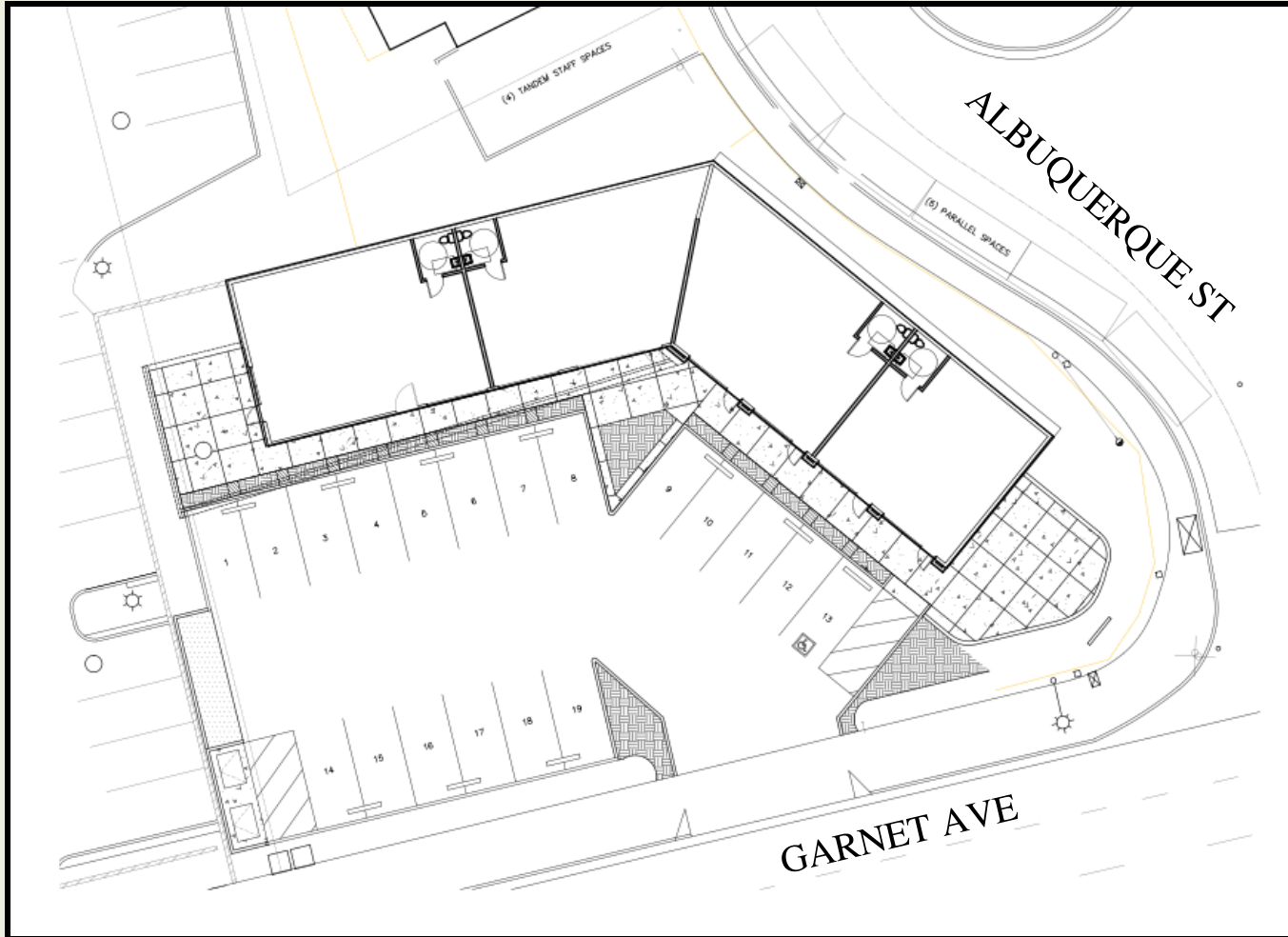

2830 GARNET AVENUE, PACIFIC BEACH

Location Map

