



### Property Features

- Suite F: 1,949 SF
- Suite G: 3,077 SF
- Suites F&G can be combined into one contiguous 5,026 SF
- \$11.75 PSF, net of utilities & janitorial
- Located in Oyster Point Business Park with excellent exposure on corner of Thimble Shoals Blvd. & Pilot House Dr.
- Stand alone building with great parking
- Building and monument signage available



For more information, contact:

**TERESA NETTLES**  
Senior Vice President  
757 873 9268  
[teresa.nettles@thalhimer.com](mailto:teresa.nettles@thalhimer.com)

One BayPort Way, Suite 100  
Newport News, VA 23606  
[www.thalhimer.com](http://www.thalhimer.com)

Independently Owned and Operated / A Member of the Cushman & Wakefield Alliance

Cushman & Wakefield | Thalhimier © 2015. No warranty or representation, express or implied, is made to the accuracy or completeness of the information contained herein, and same is submitted subject to errors, omissions, change of price, rental or other conditions, withdrawal without notice, and to any special listing conditions imposed by the property owner(s). As applicable, we make no representation as to the condition of the property (or properties) in question.

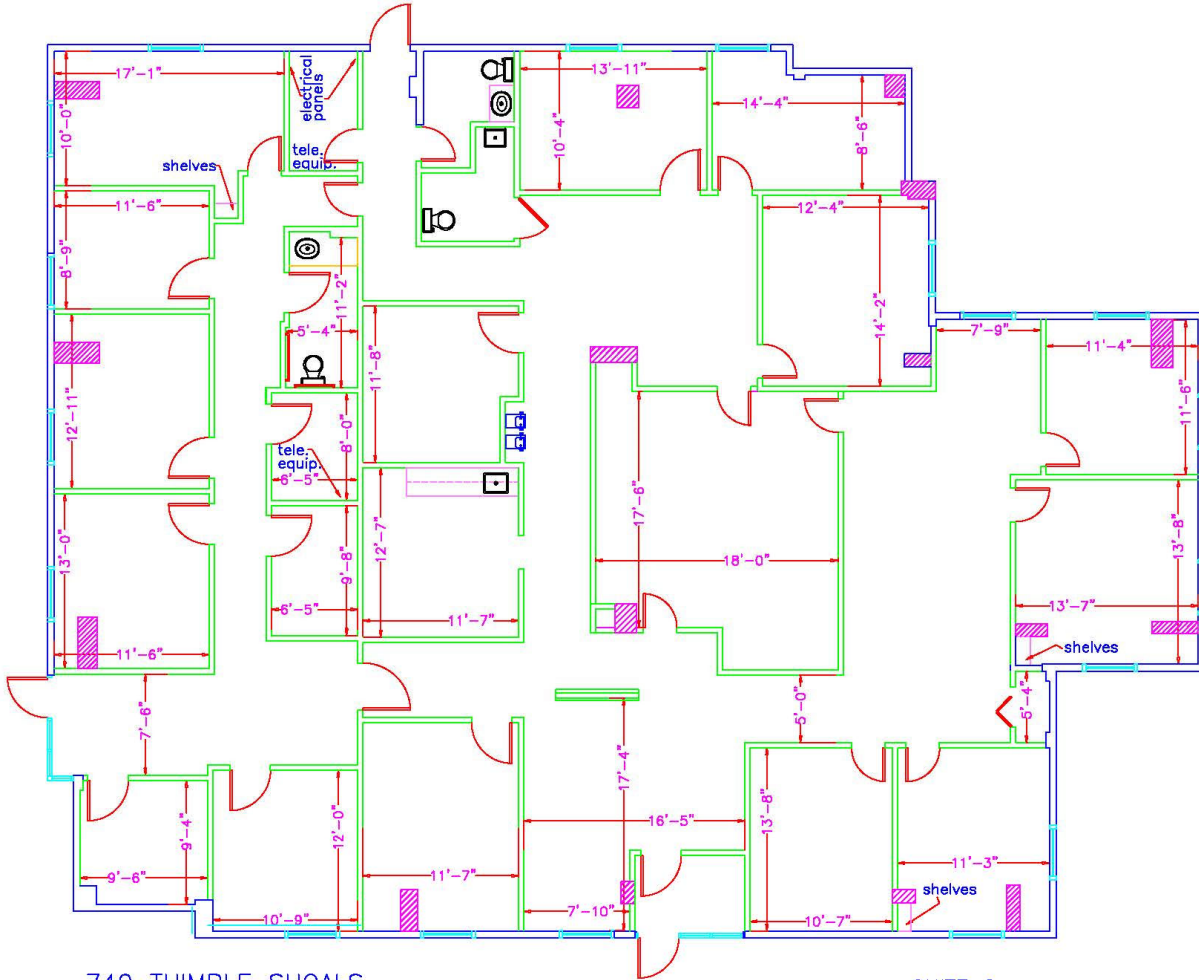

**740 THIMBLE SHOALS**

**SUITE G**  
**5,026 SF**

EXISTING FLOOR PLAN  
 SCALE: N.T.S. DATE: 5/17/16  
 DRAWN BY: K.L. MONETTE 757.214.1345

For more information, contact:

**TERESA NETTLES**  
 Senior Vice President  
 757 873 9268  
[teresa.nettles@thalhimer.com](mailto:teresa.nettles@thalhimer.com)

One BayPort Way, Suite 100  
 Newport News, VA 23606  
[www.thalhimer.com](http://www.thalhimer.com)